

Fountain Street and McEvoy Street intersection improvements

Alexandria to Moore Park corridor

Transport for NSW | May 2020

Review of Environmental Factors outcome

Thank you for your feedback on the Review of Environmental Factors (REF) for the Alexandria to Moore Park Project on display in November and December 2019. Refer to map A to see what was included in the display. The REF has now been approved. The first section of work at the intersection of Fountain Street and McEvoy Street will start on **Wednesday 13 May 2020**. We will not be implementing any other parts of the project at this time.

Close to 200 submissions were received, categorised and reviewed. Most of the submissions on the online mapping tool focused on six key issues:

- parking and clearways
- active transport
- business impacts
- right turn bans
- air quality
- congestion
- trees.

There is a lot happening in this fast growing urban area. Light Rail recently opened nearby and construction of the Sydney Metro Station at Waterloo is underway. With all this change, REF submissions affirmed that maintaining the area's neighbourhood feel was important to the community.

We've planned a package of work that considers this and we will not be carrying out all of the work described in the REF straight away.

To begin, we will be upgrading the Fountain Street/McEvoy Street intersection by installing two through lanes (westbound) and a dedicated right turn bay into Fountain Street from McEvoy Street to improve traffic flow. The improvements at the other three intersections will not be implemented yet, neither will the clearways or right turn bans.

Later this year Transport for NSW will review traffic volumes along the key connections between Alexandria and Moore Park. We will take into account how motorists, pedestrians and cyclists use this area and the impact of continued urban growth and public transport use. We will consider whether the additional measures detailed in the REF are needed at that time. We are committed to engaging with the community further before any more work is undertaken.

Submissions report

Submissions to the REF were categorised and responded to in the Submissions Report, which is now available on the project website. Read or download the full report at www.rms.nsw.gov.au/a2mp

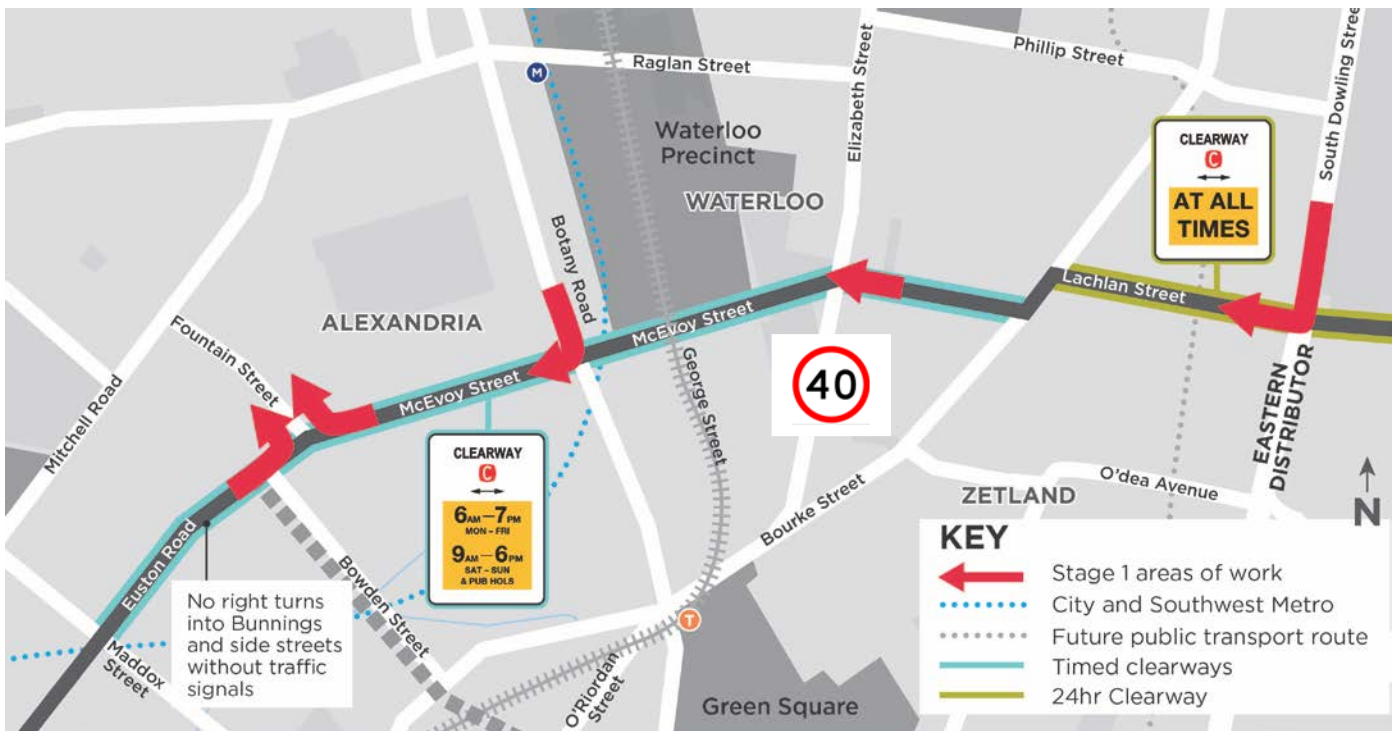

Fountain and McEvoy streets intersection - start of work

On **Wednesday 13 May 2020**, we will begin to upgrade the intersection of Fountain Street and McEvoy Street, Alexandria.

The upgrade includes a dedicated westbound right turn lane from McEvoy Street into Fountain Street, two dedicated (westbound) through lanes, footpath improvements and kerb/gutter realignment. Any trees removed will be replaced with new trees. In addition to improving congestion and safety, it is designed to encourage traffic to stay on McEvoy Street rather than local streets and improve connectivity between customers and businesses on Fountain Street.

The work is expected to be completed in the first half of 2021, weather permitting.

To improve the intersection we will work initially two nights a week from 8pm to 5am. We will try and complete the noisiest activities by midnight.

The first night work will be on **Wednesday 13 May** and will include delivery of site sheds, relocation work, underground services investigation, placing temporary road barriers and doing survey work.

A site compound will be set up at **110-112 McEvoy Street, Alexandria** and we will be working **Monday to Friday from 7am to 6pm** and **Saturday from 8am to 1pm** to prepare the area. This work includes installing a temporary site compound, temporary fencing, services connections, surveying work, vegetation trimming and removal. See map B for more detail.



The Fountain Street/McEvoy Street intersection

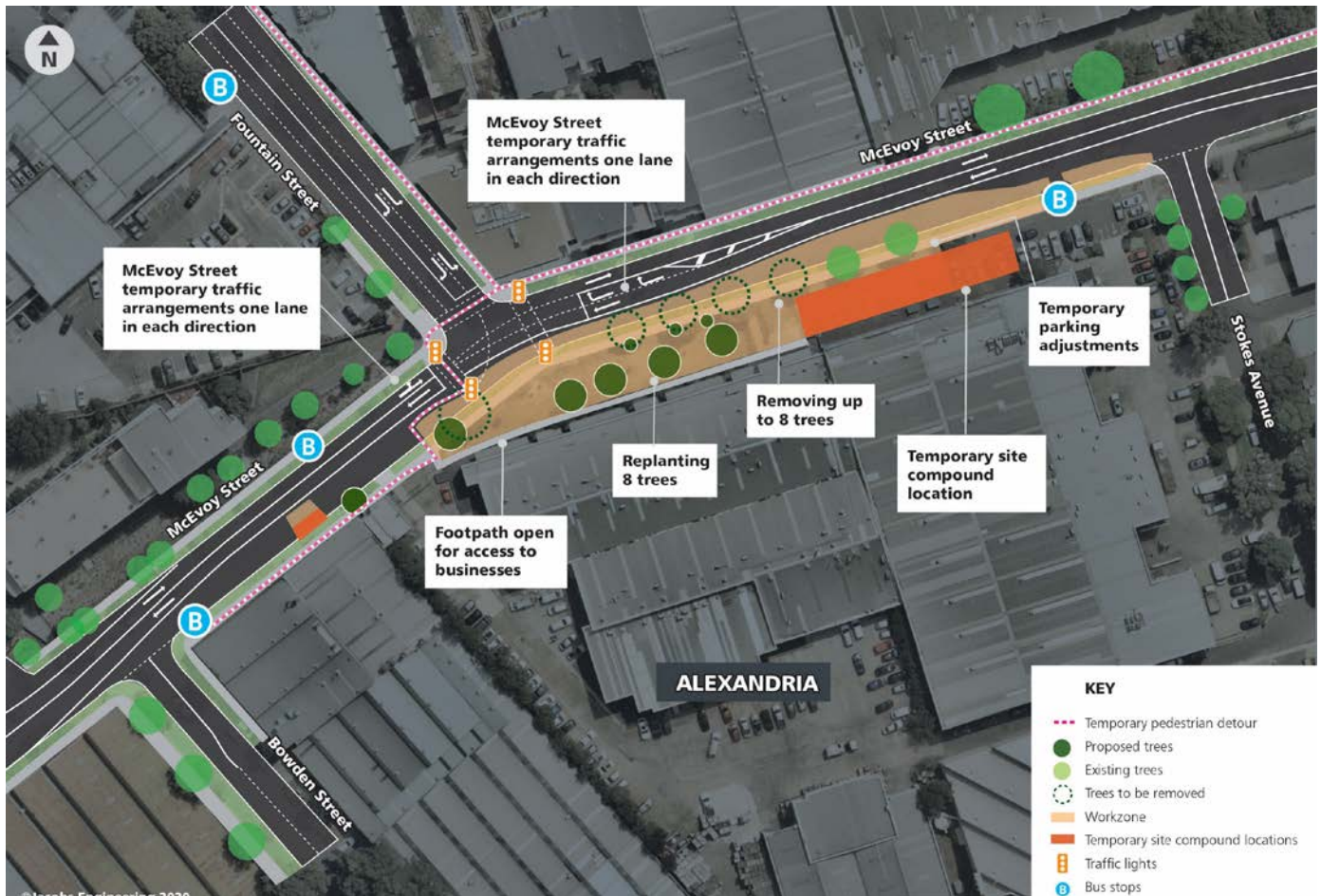

Temporary traffic and parking changes during May

From **8pm on Sunday 17 May 2020**, McEvoy Street between Stokes Avenue (east) and Bowden Street will operate with one lane in each direction. This will create a safe work zone on the southern side of McEvoy Street.

When traffic volumes normalise in the area, one of these lanes will be returned to traffic. One lane will stay closed for the duration of the work.

Parking will be temporarily removed **from 6pm on Thursday 14 May 2020** on McEvoy Street between Harley Street and Loveridge Street until work is complete to facilitate the one lane arrangement. Please check signage before leaving your vehicle parked on McEvoy Street.

These changes may affect travel times. Please keep to speed limits, follow signs and traffic controllers' directions. For the latest traffic updates, you can call 132 701, visit livetraffic.com or download the Live Traffic NSW App.

We will also work to ensure access to footpaths, driveways, bus stops is maintained at all times during the work.

How will the work affect you?

Our night work may be noisy at times but we will do everything we can to minimise its impact, including completing the noisier activities such as concrete cutting and jack hammering by midnight.

We have included a table to better explain the types of equipment and types of activities that will contribute to noise across the duration of the intersection improvement work.

Noisier activities and equipment	Less noisy activities and equipment
<ul style="list-style-type: none"> - Footpath demolition - Saw cutting concrete - Demolishing kerb and gutter 	<ul style="list-style-type: none"> - Pouring concrete - Loading and unloading trucks - Service investigation and non-destructive excavation - Reversing tones

We will minimise impacts by scheduling noisier work to occur during the day and finish before midnight, alternate our work locations, use equipment fitted with noise mitigation devices and monitor noise at night.

Social distancing restrictions currently in place have led to reduced traffic volumes across the network, allowing the team to start with increased day shifts.

When traffic volumes begin to normalise, we may need to reduce day shifts to make room for traffic and increase our night work to up to five nights a week, with the noisiest activities finishing at midnight to reduce the overall work duration. We will engage with nearby community members at that time.

Construction during Covid-19

Work on vital NSW Government transport infrastructure projects is continuing during the Coronavirus outbreak. Construction work creates jobs and encourages spending in small businesses located near job sites.

In line with current Australian Government guidelines around slowing the spread of Coronavirus and physical distancing, work is being carried out from a safe distance where possible and necessary hygiene practices are observed.

The safety of all workers on Transport for NSW work sites across the state is of the highest priority during the evolving Coronavirus situation.

To support industry and continue the delivery of critical infrastructure, the NSW Government has introduced new rules allowing construction sites, including public infrastructure projects, to operate on weekends and public holidays.

These changes have been made to facilitate physical distancing on construction sites and support the health and wellbeing of our workers.

In line with these changes, we will be working more day shifts while traffic volumes in the area are low. When traffic volumes return to normal, we will need to adjust working hours which is likely to include additional night shifts.

Stay informed

We will keep you informed with regular project information on the project website.

To receive specific information about the Fountain Street/McEvoy Street intersection upgrade, you can opt-in to receive regular updates by email and/or text.

All you need to do is email your mobile number to a2mp@rms.nsw.gov.au, and write 'Fountain Street updates' in the subject header. We can then register you for updates via text message.

Thank you for your patience while we carry out this important work.

Contact us

If you have any questions or would like more on the Alexandria to Moore Park project including Fountain Street and McEvoy Street intersection improvements work please contact our project team:

 1800 875 557

 a2mp@rms.nsw.gov.au

 www.rms.nsw.gov.au/a2mp

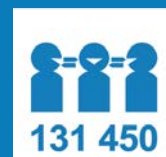

If you need help understanding this information, please contact the Translating and Interpreting Service on 131 450 and ask them to call us on 1800 875 557.