

Night work on the Princes Highway between Meroo Road and Cambewarra Road/Moss Vale Road roundabout

The NSW Government is upgrading the Princes Highway between Berry and Bomaderry to improve safety, increase road capacity and improve traffic flow.

What are we doing?

We will be laying the final layer of asphalt on the Princes Highway between Meroo Road and Cambewarra/Moss Vale Road roundabout. Work will take place over **12 night shifts** with **three nights of work each week** from **Sunday 30 January to Friday 25 February**, weather permitting.

Work will be carried out **between 6pm and 5am** with the diversion in place from about 8pm.

Should the work need to be postponed, new dates will be advertised on electronic variable message signs along the highway and on the project website.

How will the work affect you?

There will be some temporary traffic changes during this work and road users are advised to drive to conditions and follow the direction of signs and traffic control.

Work will involve the temporary diversion of northbound and southbound highway traffic at separate times over four weeks as shown on the maps over the page. The maps show the sequence of the weekly work.

When work is carried out, light vehicle highway traffic will be detoured via Meroo and Cambewarra roads. Heavy vehicles will be detoured via Meroo and Bolong roads.

Resident and business access will be maintained during the work.

There will be noise and light associated with this work. Work will include the use of lighting towers, asphalt paving machinery, rollers, guardrail installation equipment, excavators, crane trucks and construction vehicles.

Transport for NSW thanks road users for their patience during this time.

Contact

If you have any questions, please contact the project team on 1800 506 976 or BerrytoBomaderryUpgrade@DSWJV.com.au.

For more information on our projects, visit roads-maritime.transport.nsw.gov.au



If you need help understanding this information, please contact the Translating and Interpreting Service on 131 450 and ask them to call us on 1800 506 976

Princes Highway - Abernethys Lane to Pestells Lane northbound asphalt works. Nightworks

Diagrammatic - not to scale

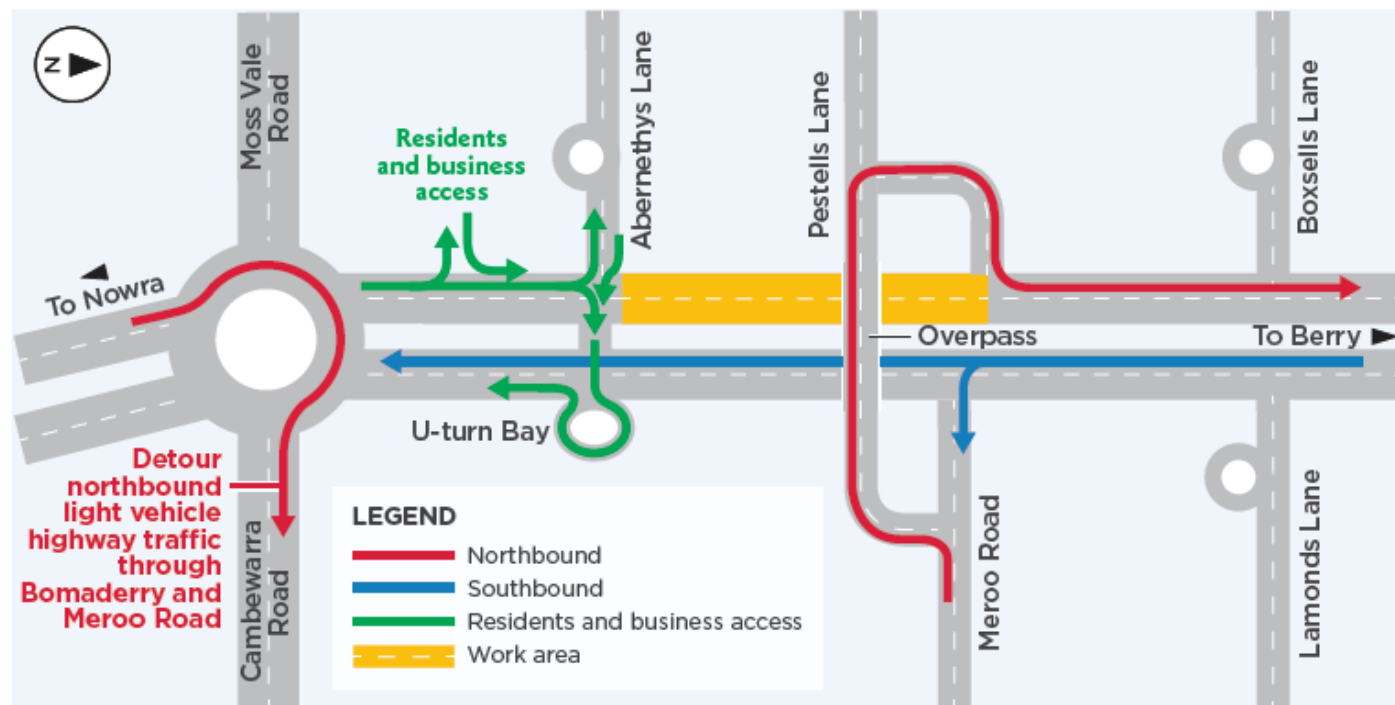

Princes Highway - Moss Vale Road to Abernethys Lane northbound asphalt works. Nightworks

Diagrammatic - not to scale

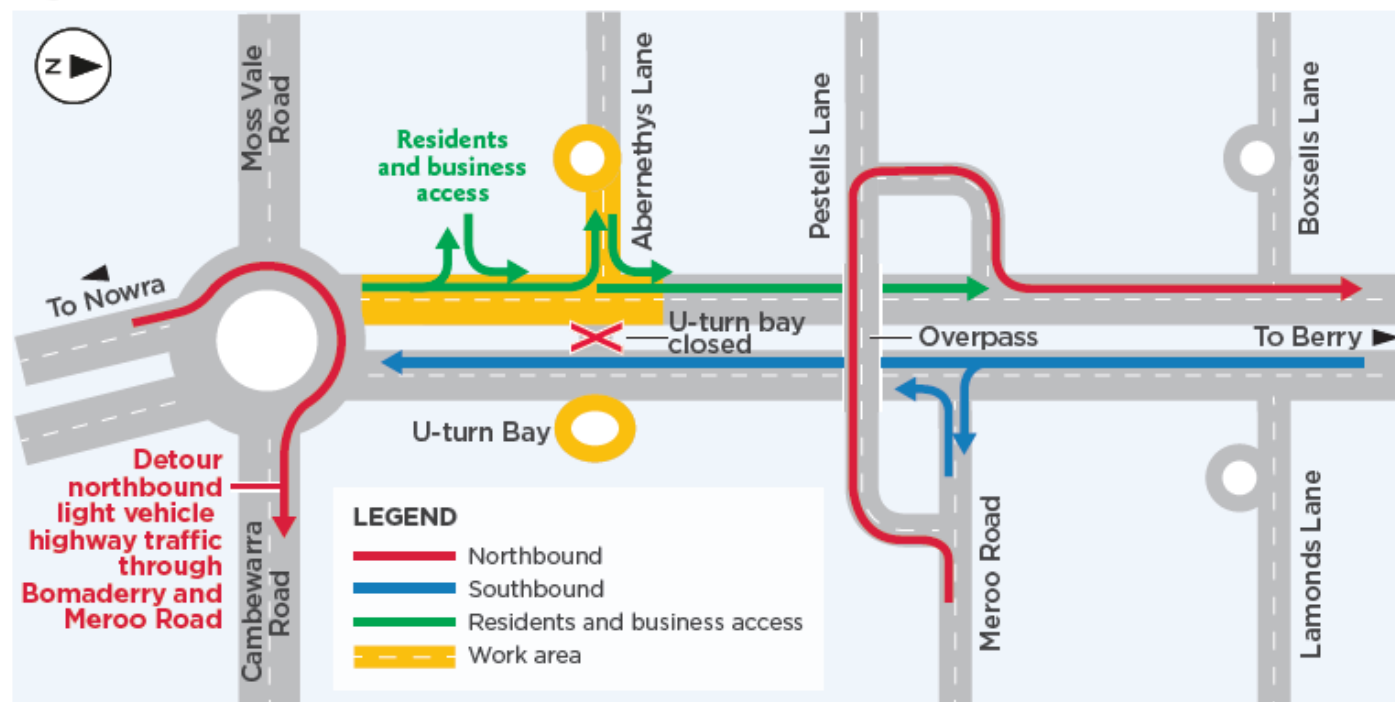

Princes Highway - Meroo Road to Abernethys Creek southbound asphalt works. Nightworks

Diagrammatic - not to scale

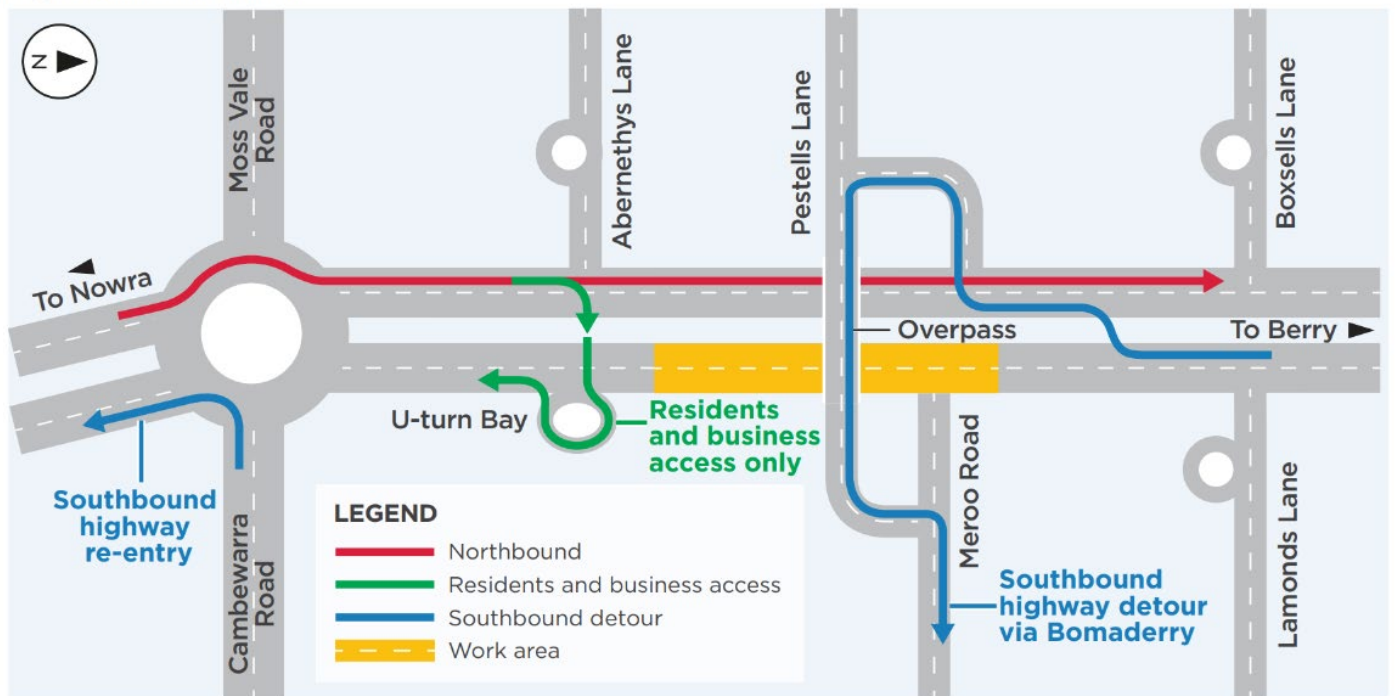

Princes Highway - Abernethys Lane to Cambewarra Road southbound asphalt works. Nightworks

Diagrammatic - not to scale

