

Changed traffic conditions on the Princes Highway between Devitts Lane and Mullers Lane, Jaspers Brush

The NSW Government is upgrading the Princes Highway between Berry and Bomaderry to improve safety, increase road capacity and improve traffic flow.

What are we doing?

We will be changing traffic arrangements on the Princes Highway between Devitts Lane and Mullers Lane to its final lane configuration over two stages on **Wednesday 3 November and Friday 12 November**, weather permitting. These changes are necessary to meet the new design of the highway.

In preparation for these changes, we will be carrying out safety barrier relocation, signage installation, pavement work and line marking on the Princes Highway from **Monday 1 November to Friday 12 November**, weather permitting.

Work will be carried out **between 6pm and 7am**.

Should the work need to be postponed, new dates will be advertised on variable message signs and on the project website.

How will the work affect you?

Stage 1 will be in place from **Wednesday 3 November**, with southbound motorists temporarily moved over to the northbound carriageway between Strongs Road and Turners Lane. This will allow the final layer of asphalt pavement to be placed. This temporary change will require access to Turners Lane via Devitts Lane interchange. U-Turn bays between Strongs Road and Turners Lane will be closed and temporary detours in place via Devitts Lane interchange and Strongs Road.

Stage 2 will be in place from **Friday 12 November**, with northbound motorists moved onto the new northbound carriageway between Croziers Road and Mullers Lane. Southbound motorists will be moved onto the new southbound carriageway between Croziers Road and Devitts Lane interchange. Please see the maps over the page for the locations of this work.

There will be some noise and light associated with this work. Work will include the use of lighting towers, cranes, road surfacing machinery and heavy vehicles.

Motorists are advised to drive to conditions and follow the direction of signs and traffic control. For the latest traffic updates call 132 701, visit livetraffic.com, or download the Live Traffic App.

Transport for NSW thanks the community for their patience during this time.

Northern Switch Phase 1

Diagrammatic - not to scale

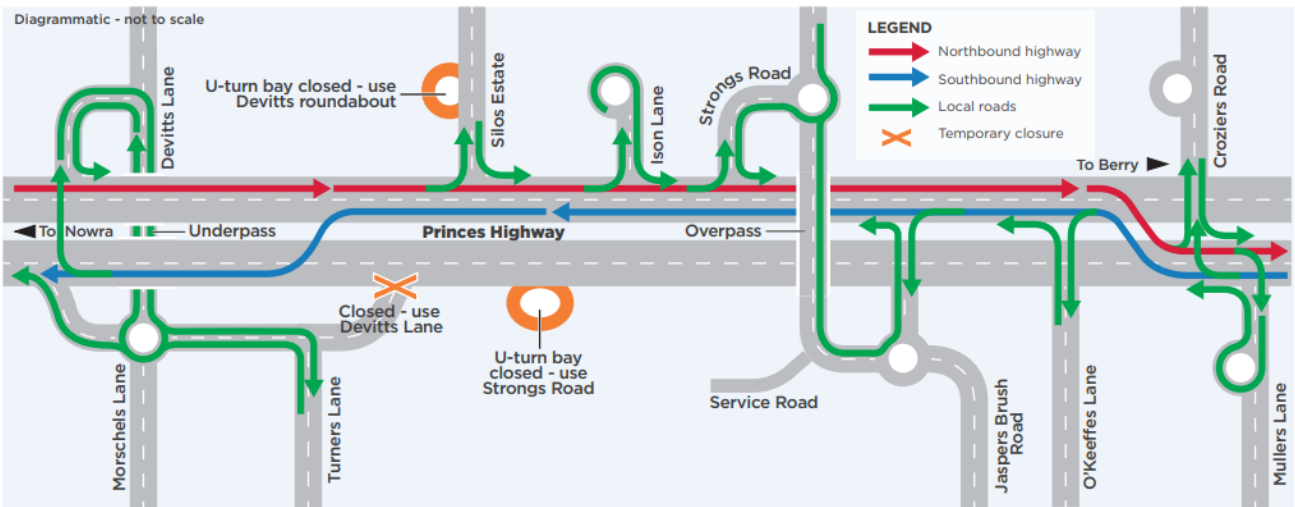

Northern Switch Phase 2

Diagrammatic - not to scale

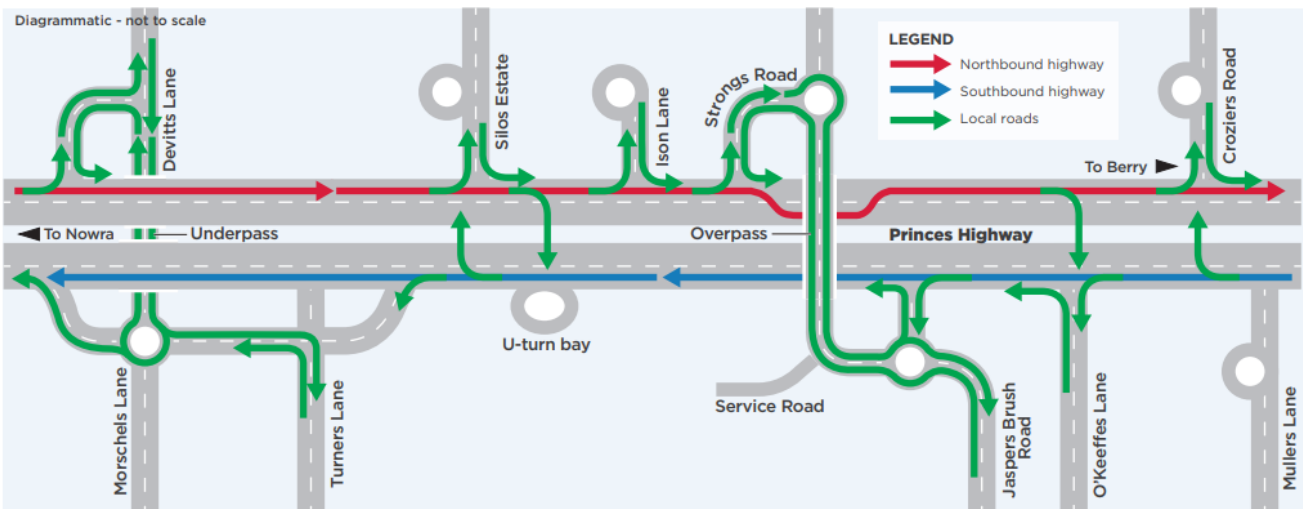

Contact

If you have any questions, please contact the project team on 1800 506 976 or

BerrytoBomaderryUpgrade@DSWJV.com.au

For more information on our project, visit roads-maritime.



If you need help understanding this information, please contact the Translating and Interpreting Service on 131 450 and ask them to call us on 1800 506 976