



Australian Government

BUILDING OUR FUTURE



Changed traffic arrangements on Cowpasture Road (south), Leppington from Friday, 15 September 2017

The Australian and NSW Governments are funding this work under the \$509 million Bringelly Road Upgrade between Camden Valley Way, Leppington and The Northern Road, Bringelly. This project is part of the \$3.6 billion Western Sydney Infrastructure Plan.

Roads and Maritime Services is carrying out work to upgrade the Bringelly Road and Cowpasture Road (south) intersection. As part of this work, a section of Cowpasture Road (south) will be switched to the newly built northbound lanes.

Our work schedule

Traffic will travel on the new Cowpasture Road (south) lanes from **10am, Friday, 15 September 2017**, weather permitting.

We have included a map of changed traffic arrangements.

Traffic changes

Electronic message signs will be in place to advise road users of changes.

There may be some short delays to traffic along Bringelly Road as traffic controllers help trucks to safely enter and exit our construction site.

Please keep to speed limits and follow signs and traffic controllers' directions. For the latest traffic updates, you can call 132 701, visit livetraffic.com or download the Live Traffic NSW App.

Contact

If you have any questions, please contact our delivery partner BMD Constructions on 1800 199 009 or bringellyroadupgrade@bmd.com.au.

For more information on our projects, visit rms.nsw.gov.au

Thank you for your patience during this important work.

Changed traffic arrangements

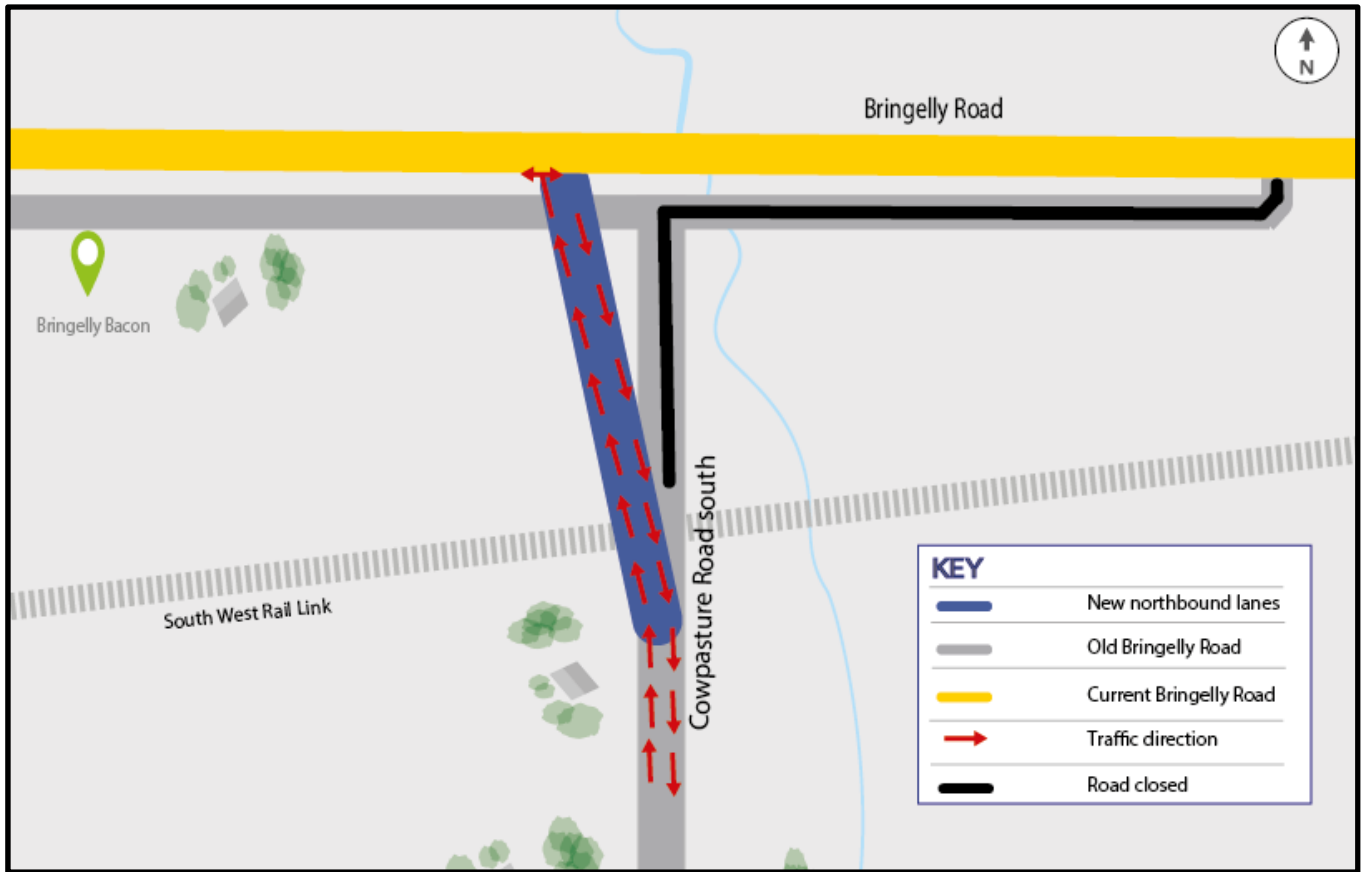

Western Sydney Infrastructure Plan

The Australian and NSW governments are funding a 10 year, \$3.6 billion road investment program for western Sydney. The Western Sydney Infrastructure Plan will deliver major road upgrades to support integrated transport for the region and capitalise on the economic benefits from developing the Western Sydney Airport at Badgerys Creek. It will also improve safety, increase road capacity and reduce congestion and travel times in the future. For more information on Western Sydney Infrastructure Plan projects, visit rms.nsw.gov.au/wsip or call 1800 703 457.



 If you need help understanding this information, please contact the Translating and Interpreting Service on 131 450 and ask them to call us on 1800 199 009