



Transport
Roads & Maritime
Services

APPENDIX D

Campbelltown Road MR177 Bridge Design

RMS 2013



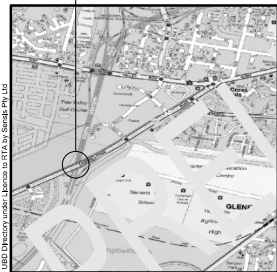
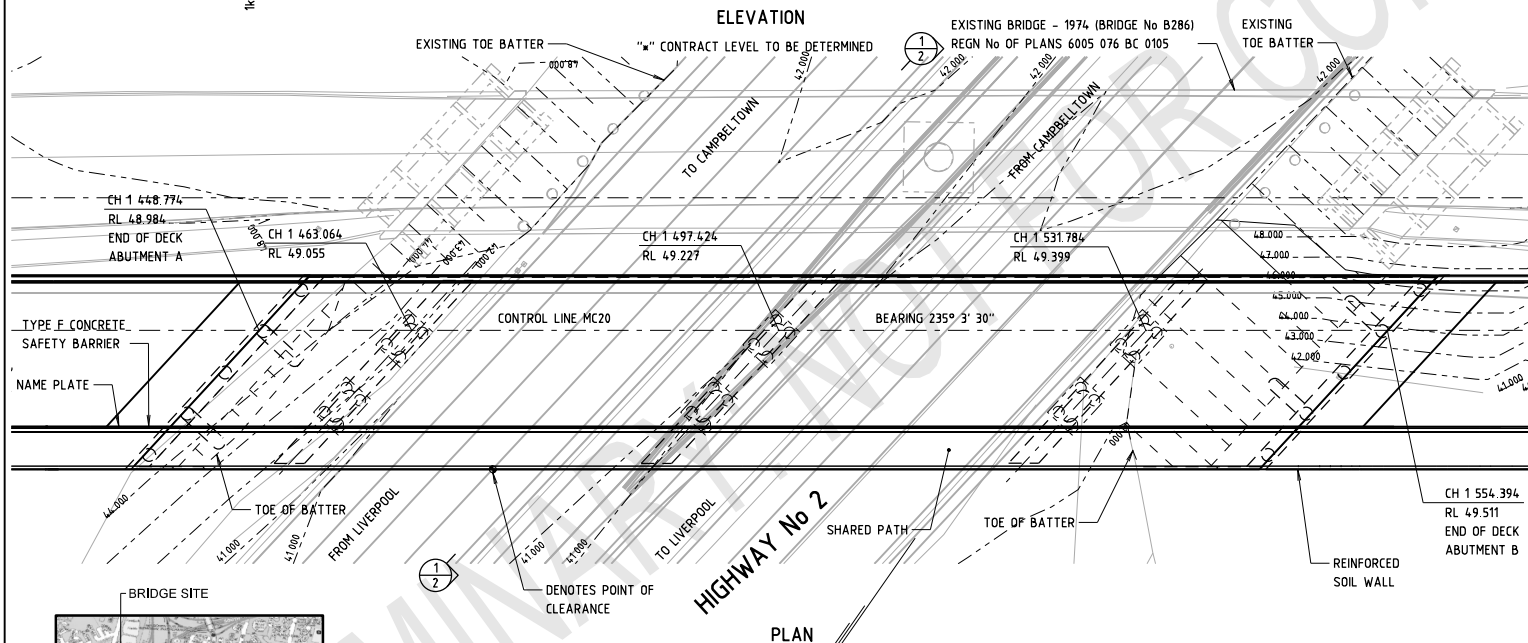
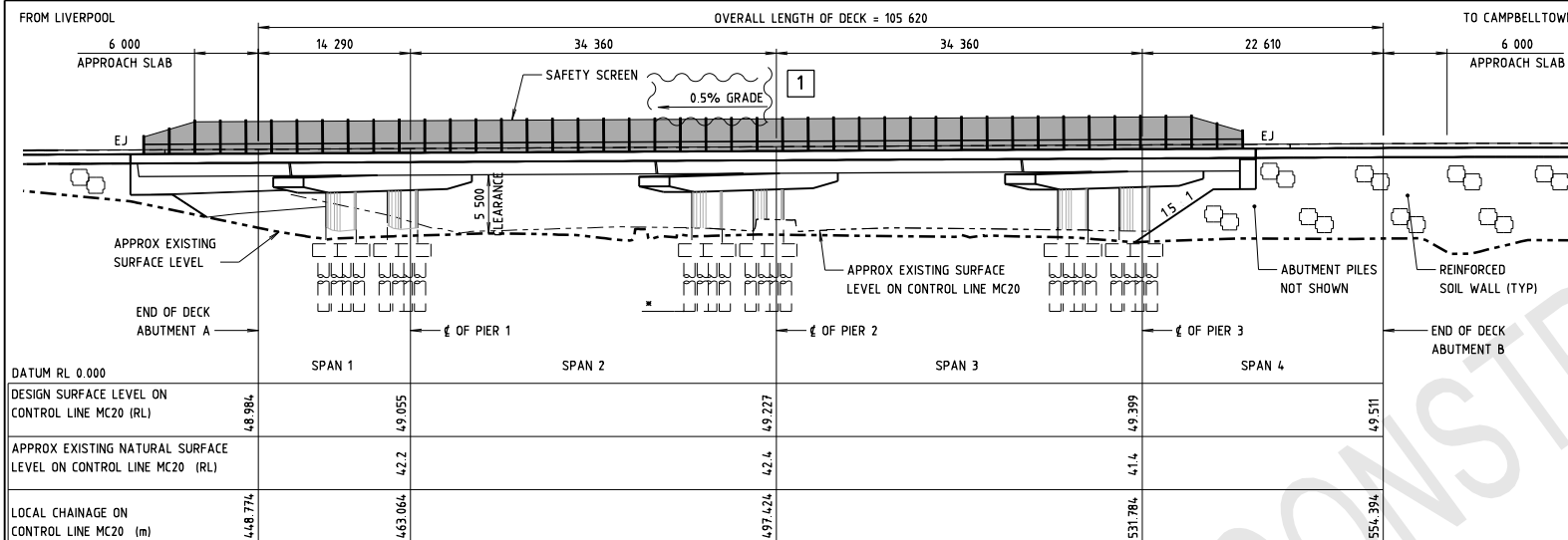

LOCALITY PLAN
THE BRIDGE SITE IS APPROXIMATELY
39 km BY ROAD FROM SYDNEY

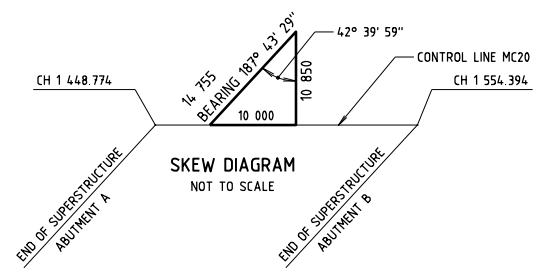

GENERAL NOTES

SCALE 0 5 10 15m OR AS SHOWN

DIMENSIONS ARE IN MILLIMETRES.
CHAINAGES AND REDUCED LEVELS ARE IN METRES.

ISSUE	DATE	REVISION	DC	PREP	CHECK	AUTH
1	09/08/12	DECK SLOPE 0.5% WAS 5%				

HIGHWAY No 2 CITY OF LIVERPOOL

BRIDGE OVER HIGHWAY No 2
AT MAIN ROAD No 177
CONCEPT SKETCH - SHEET A

<p>Transport Roads & Maritime Services</p>	<p>PREPARED BY BRIDGE AND STRUCTURAL ENGINEERING BRANCH 110 GEORGE STREET PARRAMATTA NSW 2150 PHONE (02) 8837-0802 FACSIMILE (02) 8837-0255</p> <p>CLIENT: PROJECT DEVELOPMENT 27 ARGYLE STREET PARRAMATTA NSW 2150 PHONE (02) 8648-2294 FACSIMILE (02) 8837-2817</p>
---	---

PREPARED	CHECKED	SKETCH No
DESIGN		KD980CONS
DRAWING	DC	BRIDGE NUMBER
SENIOR BRIDGE ENGINEER (NEW DESIGN)		ISSUE STATUS: PRELIMINARY
SHEET No		1 ISSUE 1

CAD No: KD980CONS_A_1.dgn © COPRIGHT ROADS AND MARITIME SERVICES 2012

K:\Bridge\Current\Projects\Design\98001_Hwy2\Campbelltown\98001_Sketches\K9800CONS_A_1.dgn 16/12/2012 9:31:46 AM

SOUTHERN SIDE

NORTHERN SIDE

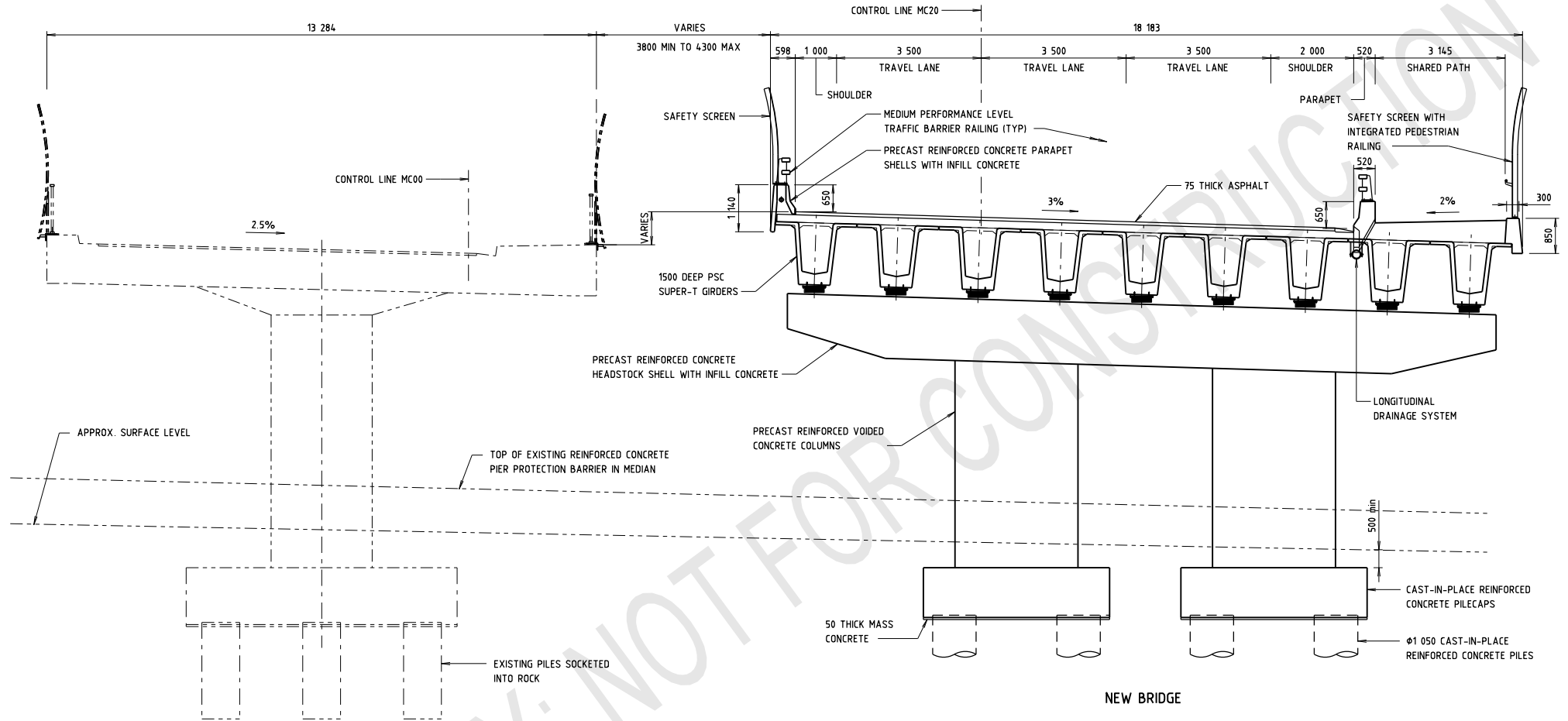

EXISTING BRIDGE - 1974 (BRIDGE No B286)
 REGN No OF PLANS 6005 076 BC 0105

SECTION 1
 1

NEW BRIDGE

GENERAL NOTES

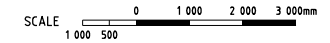

FOR OTHER GENERAL NOTES RELATING TO THIS SHEET, SEE SHEET No 1.

ISSUE	DATE	REVISION	PREP	CHECK	AUTH
HIGHWAY No 2 CITY OF LIVERPOOL					
BRIDGE OVER HIGHWAY No 2					
AT MAIN ROAD No 177					
CONCEPT SKETCH - SHEET B					
Transport Roads & Maritime Services			PREPARED BY BRIDGE AND STRUCTURAL ENGINEERING BRANCH 110 GEORGE STREET PARRAMATTA NSW 2150 PHONE (02) 8837-0802 FACSIMILE (02) 8837-0056 CLIENT: PROJECT DEVELOPMENT 27 ARGYLE STREET PARRAMATTA NSW 2150 PHONE (02) 8649-2294 FACSIMILE (02) 8837-2817		
PREPARED	CHECKED	SKETCH No			
DESIGN		KD980CONS			
DRAWING	DC	BRIDGE NUMBER			
ISSUE STATUS: PRELIMINARY					
SENior BRIDGE ENGINEER (NEW DESIGN)					
SHEET No 2 ISSUE					

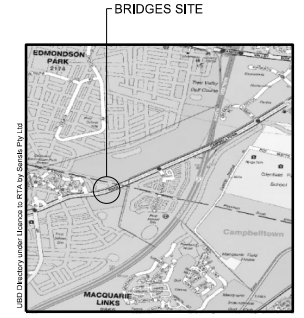
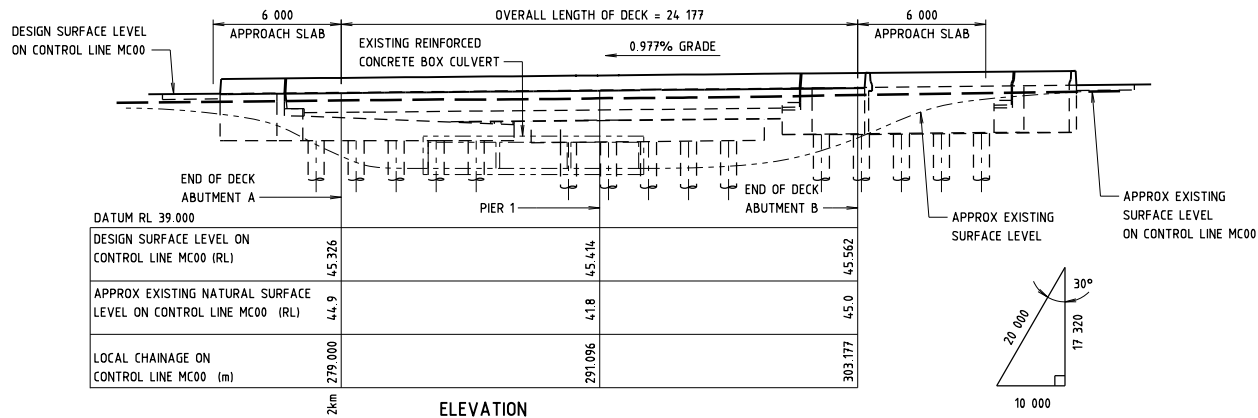

LOCALITY PLAN
THE BRIDGES SITE IS APPROXIMATELY 45 km BY ROAD FROM SYDNEY

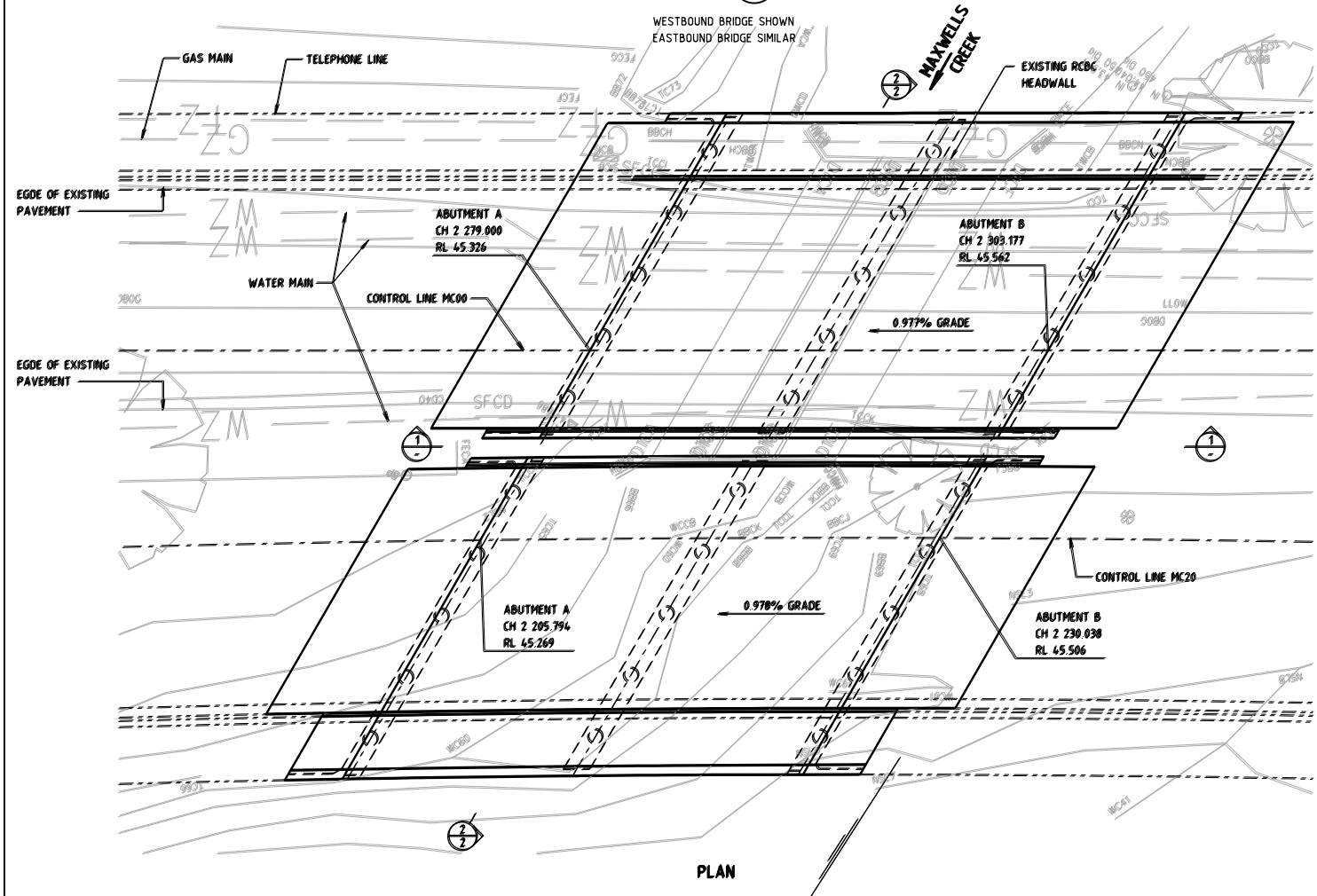

GENERAL NOTES



- DIMENSIONS ARE IN MILLIMETRES.
- CHAINAGES AND REDUCED LEVELS ARE IN METRES.
- REDUCED LEVELS ARE RELATED TO AUSTRALIAN HEIGHT DATUM.
- TP DENOTES TANGENT POINT.
- CL DENOTES CONTRACT LEVEL.
- E DENOTES EXPANSION BEARING.
- F DENOTES FIXED BEARING.
- R DENOTES RESTRAINED BEARING.
- CONCRETE BRIDGE DECK WATERPROOFING MEMBRANE SHALL CONFORM TO RMS SPECIFICATION B344 OR BPC2005/02.
- WATERPROOFING MEMBRANE SHALL BE OVERLAYED WITH 75mm THICK ASPHALT.

ISSUE	DATE	REVISION	PREP	CHECK	AUTH
MAIN ROAD No 177 CITY OF CAMPBELLTOWN					
TWO BRIDGES OVER MAXWELLS CREEK AT INGLEBURN GARDENS CONCEPT SKETCH - SHEET A					
		Transport Roads & Maritime Services			
PREPARED DESIGN _____ DRAWING _____		CHECKED _____		REGISTRATION No OF PLANS BRIDGE NUMBER _____ ISSUE STATUS: SHEET No _____ ISSUE _____	
SENIOR BRIDGE ENGINEER (NEW DESIGN)		PREPARED BY BRIDGE AND STRUCTURAL ENGINEERING BRANCH 110 GEORGE STREET PARRAMATTA NSW 2150 PHONE (02) 8837-0802 FACSIMILE (02) 8837-0055 CLIENT:			

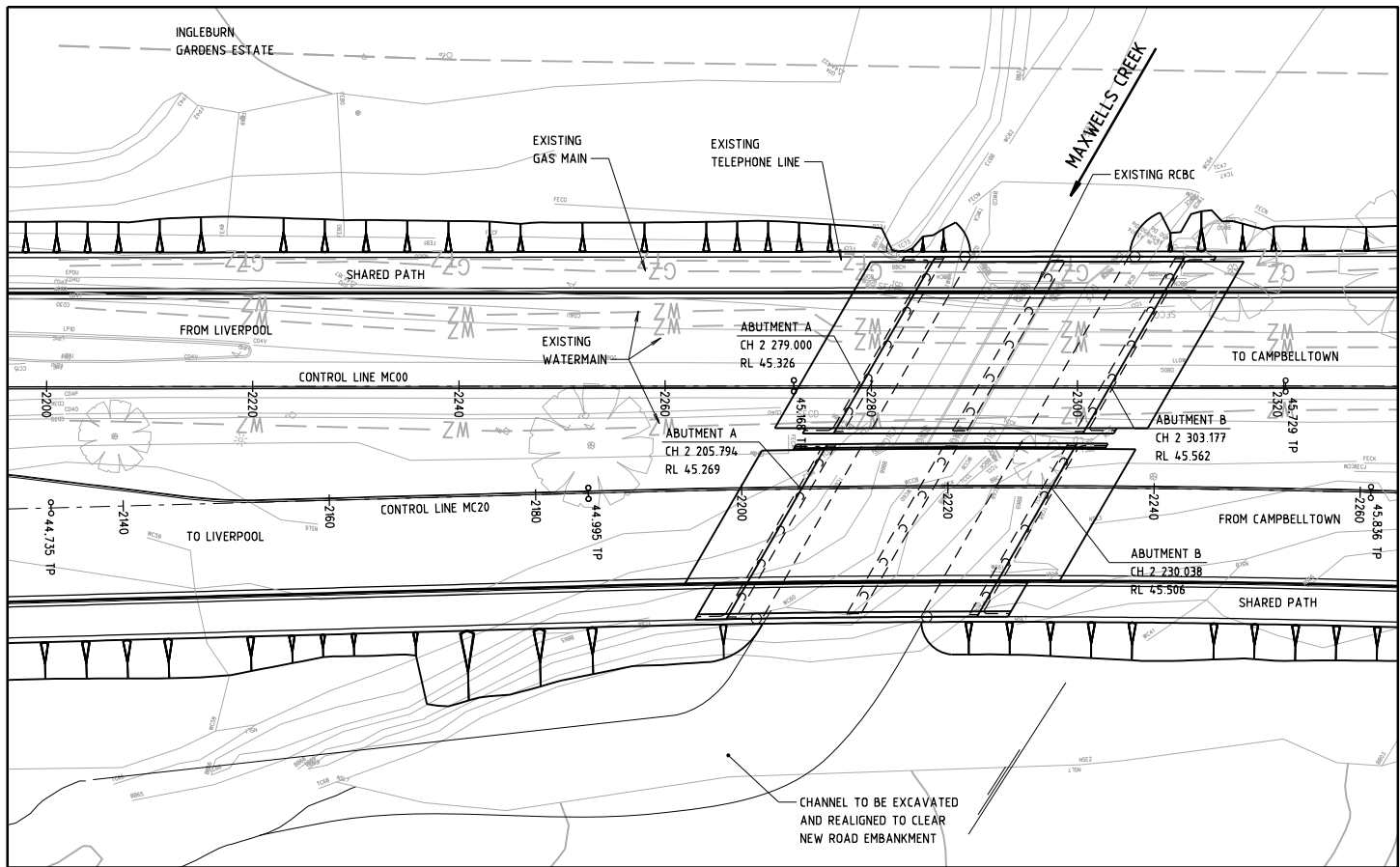
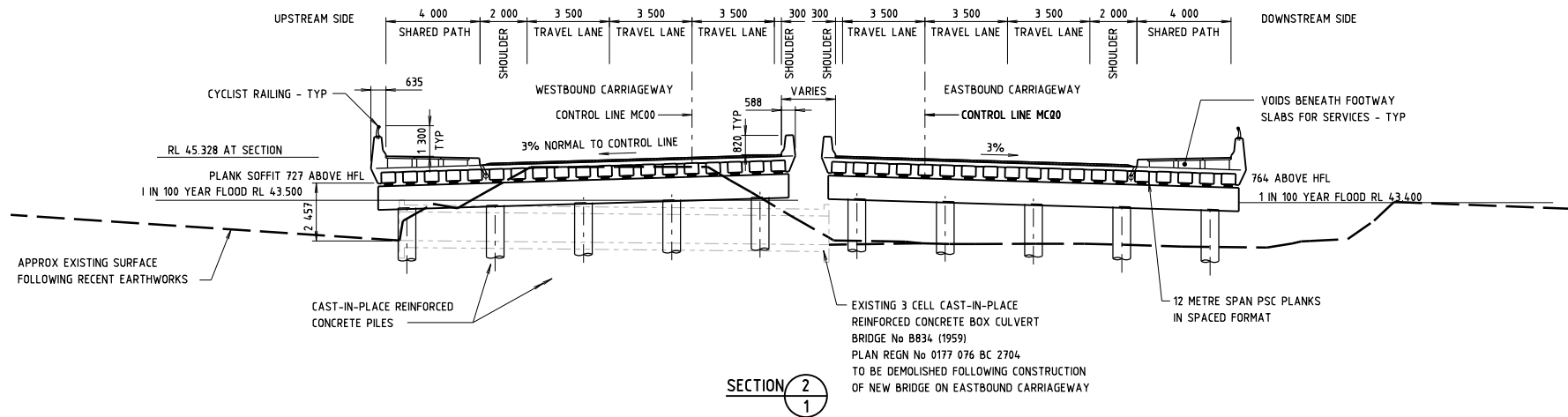

GENERAL NOTES

SCALE 1:0.5 OR AS SHOWN

FOR OTHER GENERAL NOTES RELATING TO THIS SHEET, SEE SHEET No 1

ISSUE	DATE	REVISION	PREP	CHECK	AUTH
MAIN ROAD No 177 CITY OF CAMPBELLTOWN					
TWO BRIDGES OVER MAXWELLS CREEK AT INGLEBURN GARDENS					
CONCEPT SKETCH - SHEET B					
Transport Roads & Maritime Services			PREPARED BY BRIDGE AND STRUCTURAL ENGINEERING BRANCH 110 GEORGE STREET PARRAMATTA NSW 2150 PHONE (02) 8837-0802 FACSIMILE (02) 8837-0956 CLIENT:		
PREPARED	CHECKED	REGISTRATION No OF PLANS			
DESIGN		BRIDGE NUMBER			
DRAWING		ISSUE STATUS:			
SENIOR BRIDGE ENGINEER (NEW DESIGN)		SHEET No	ISSUE		