



Showground Road, looking east towards Old Northern Road

Showground Road upgrade

September 2016

The NSW Government is upgrading Showground Road, between Carrington Road and Old Northern Road, Castle Hill to a four lane divided road to reduce congestion and increase traffic capacity to meet predicted growth from development in the area.

Following a competitive tendering process Roads and Maritime Services contracted Seymour Whyte Constructions Pty Ltd to upgrade 1.5 kilometres of Showground Road. Major construction started late May 2016.

Key benefits

The benefits of the project include:

- Reducing congestion
- Increasing traffic capacity to meet the predicted growth from development in the area
- Improving safety at several intersections.

Key features

- Widening of Showground Road to at least four lanes between Carrington Road and Old Northern Road with additional turning lanes at key intersections
- Upgrading the intersection of Showground Road and Pennant Street to include additional turning lanes and a bus priority measure
- Installing new traffic lights at the intersections of Showground Road with Rowallan Avenue and Cheriton Avenue
- Changing the intersection of Showground Road and Britannia Road to left-in/left-out access
- Installing a central concrete median with landscaped planter bays at a number of locations along the road
- Providing a concrete footpath to both sides of the road between Carrington Road and Pennant Street.

Changes to the project

Some changes to the project were made during the detailed design phase and an addendum Review of Environmental Factors (REF) was prepared. The following changes have been made to the project:

- Hills Shire Council has agreed that access between Showground Road and Kentwell Avenue be closed pending the future development of the Queensland Investment Corporation (QIC) land to the north. Changes to the southern end of Kentwell Avenue have also been made to allow garbage trucks and emergency services vehicles to turn around. The traffic lights at the intersection of Showground Road and Cheriton Avenue will still allow access into and out of Cheriton Avenue
- Access from Cecil Avenue into Rowallan Avenue is currently difficult due to the large volume of through traffic along Showground Road which limits the sharp turn movement through this intersection. This manoeuvre will be banned. The addition of a new westbound lane on Showground Road will make this movement unsafe. As a result, motorists are to use the intersection of Showground Road and Cheriton Avenue to access the right turn lane from Showground Road into Rowallan Avenue
- Removing bus priority measures in the eastbound direction at the intersections of Showground Road with Kentwell Avenue and Pennant Street pending the future development of the QIC land to the north
- Providing site office / compound locations including:
 - Castle Hill Showground will be used for a site office, worker amenities, storage of plant and equipment and minor stockpiling
 - QIC construction land near Kentwell Avenue pending the resolution of the Voluntary Planning Agreement between Roads and Maritime, Hills Shire Council and QIC.
- Any clean, excess spoil from construction will be stockpiled at 10 Balmoral Road, Kellyville for the Hills Shire Council to use at the site. Fourteen trees on the site will be removed to allow safe heavy vehicle access and for storage of material. Fencing will be installed to secure the site
- Due to the narrow corridor width, we will now be providing a two metre wide footpath instead of a 2.5 metre wide shared path on the northern side of Showground Road, between Carrington Road and Pennant Street. The Hills Shire Council will consider options for connectivity between their shared paths as development continues along the corridor which may allow for a wider pathway in the future
- Final bus stop locations have been moved slightly to allow buses to stop safely within the road shoulders. Two new temporary bus stops on Showground Road, west of Carrington Road will be installed during construction to improve access to bus services on the western part of Showground Road.

Bus stops will need to be consolidated during construction. Please refer to the map for the updated temporary bus stop locations

- Removal of 15 additional trees on private property likely to be affected by construction. Additional trees on Showground Road will require supervision by an arborist during construction and utility trenching to confirm if they can be retained
- Reconnection of power to nearby properties using private poles.

Further information on the design changes is available in the addendum REF which is available on the project website at rms.nsw.gov.au/projects/sydney-north/castle-hill-showground-road-upgrade/index.html.

What's happening now?

Major construction work for Showground Road started in May 2016, current activities include:

- Implementing a 40km/h speed limit during construction hours. As the concrete barriers are installed, the road corridor will be further narrowed and the lower speed limit will follow the barrier installation. During major construction, when all barriers are in place, the 40km/h speed limit will apply 24 hours a day. Motorists can expect delays and are asked to allow extra travel time
- Clearing of vegetation and trees
- Relocating utilities and services including electricity, water, gas and telecommunications
- Relocating temporary bus stops along Showground Road
- Closure of road shoulders
- Installing concrete barriers around the work areas to ensure safe separation of construction activity from traffic, pedestrians and cyclists
- Removing existing kerbs, footpaths, road barriers and median strips.

Managing impact during construction

There will be some disruption while we complete this work including changed traffic conditions, noise, vibration, dust, lighting during night work and access to property. Construction activities will be carried out in accordance with the project's Construction Environmental Management Plan. We will make every effort to minimise impact by:

- Notifying residents in advance of work
- Carrying out work during standard construction hours wherever possible
- Servicing and maintaining machinery and equipment to limit noise and emissions.



Bus stops

To minimise delays to bus services and ensure the safety of bus customers, some bus stops along Showground Road will be temporarily unavailable during construction. Bus stops will be relocated as construction progresses and we will notify you before any changes.

Pedestrian access

Pedestrian access will be maintained along Showground Road throughout construction.

Mobility scooters and cyclists

Mobility scooters and cyclists are encouraged to use Castle Street – which runs parallel and the north of Showground Road – to access Pennant Street and Old Northern Road.

Construction hours

Construction will generally be carried out during standard construction hours including:

- **7am to 6pm** Monday to Friday
- **8am to 1pm** Saturdays when required.

Work will need to be carried out at night to maintain safety, lessen impact on the road network and maintain the service continuity of utilities when they are being relocated. All work outside of standard construction hours will be carried out in accordance with the relevant approvals. Residents and businesses will be notified in advance of any night work.

HSC students

Students studying for the HSC who live near Showground Road upgrade work are encouraged to contact us to discuss study sensitivities and the road work schedule including noise, night work and traffic delays associated with the work. We will make every effort to minimise noise, including ensuring our work program allows opportunities for respite.

Traffic changes

Until January 2017, major traffic changes will be in place as construction work continues along Showground Road.

Traffic switch

We need to move traffic travelling westbound towards Castle Hill Showground, onto the eastbound lane of Showground Road.

Traffic will be moved onto the eastbound lane and shoulder of Showground Road between Carrington Road and Cecil Avenue starting from **9pm on Monday 19 September**, weather permitting. This will remain in place **24 hours a day, seven days a week** until January 2017. One lane will be maintained in each direction.

We have included a map to help explain the changes.

To prepare for the switch, we will continue night work for **up to five shifts** per week throughout September and October 2016, weather permitting. Our working hours will be from **8pm to 5am Sunday to Friday**.

Temporary road closures

Temporary closures of some local roads off Showground Road will be in place to relocate impacted utilities along the road corridor. Detours will be in place during this work. Electronic message signs and yellow, road work advisory signs will be placed in the vicinity of the work site to notify motorists of road closures and detours at least five days before work starts.

The following local roads will be closed for **up to five nights**, weather permitting:

- **Cecil Avenue** – from **9pm to 5am** between **Monday 29 August** and **Friday 9 September**
- **Britannia Road** – from **9pm to 5am** between **Monday 12 September** and **Friday 23 September**
- **Rowallan Avenue** – from **9pm to 5am** between **Monday 26 September** and **Friday 7 October**.

Cecil Avenue

Cecil Avenue will be temporarily closed at the intersection with Showground Road **24 hours a day, seven days a week** from **Monday 12 September to January 2017**, weather permitting.

Britannia Road

Access at Britannia Road has been permanently changed to left in, left out traffic only. No Right Turn signs have been installed at this intersection.

Rowallan Avenue

We need to temporarily close Rowallan Avenue at the intersection with Showground Road for up to three months to upgrade the intersection and install new traffic lights.

Further temporary road closures will need to be carried out as construction progresses. Dates of the closures will be confirmed with the community and stakeholders closer to the date.

Additional traffic changes

During this work, the following additional traffic changes will be in place to ensure the work zone is safe:

- The speed will be reduced to **40km/h** through the construction zone, **24 hours a day, seven days a week**. Traffic control and signage will be in place
- Barriers will be placed along Showground Road to provide a buffer between live traffic and construction workers
- Parking restrictions will also be in place with closures of the Showground Road shoulders.

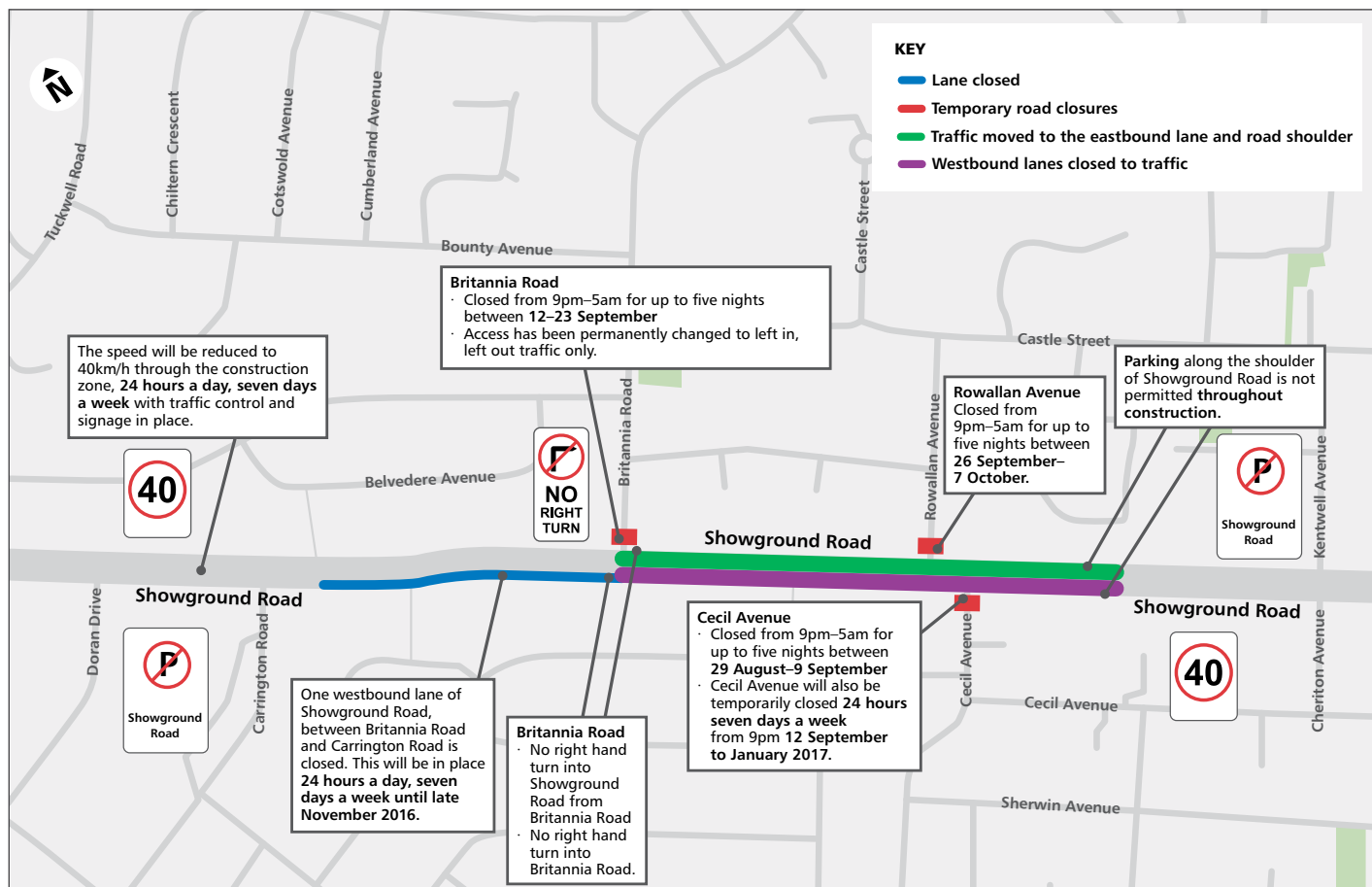

Traffic changes on Showground Road



This document contains important information about road projects in your area. If you require the services of an interpreter, please contact the Translating and Interpreting Service on **131 450** and ask them to call the project team on **1800 787 417**. The interpreter will then assist you with translation.

Further information

For further information, please contact the project team:

☎ 1800 787 417 in business hours

@ community@seymourwhyte.com.au

✉ Showground Road Upgrade,
Locked Bag 7513
McMahons Point NSW 2060

🖥 rms.nsw.gov.au/projects



September 2016
RMS 16.405



Privacy Roads and Maritime Services ("RMS") is subject to the Privacy and Personal Information Protection Act 1998 ("PIIP Act") which requires that we comply with the Information Privacy Principles set out in the PIIP Act. All information in correspondence is collected for the sole purpose of assisting in the administration of this project. The information received, including names and addresses of respondents, may be published in subsequent documents unless a clear indication is given in the correspondence that all or part of that information is not to be published. Otherwise RMS will only disclose your personal information, without your consent, if authorised by the law. Your personal information will be held by RMS at 27 Argyle Street, Parramatta NSW 2150. You have the right to access and correct the information if you believe that it is incorrect.