

# Foxground and Berry bypass

BERRY NORTH INTERCHANGE

JULY 2014

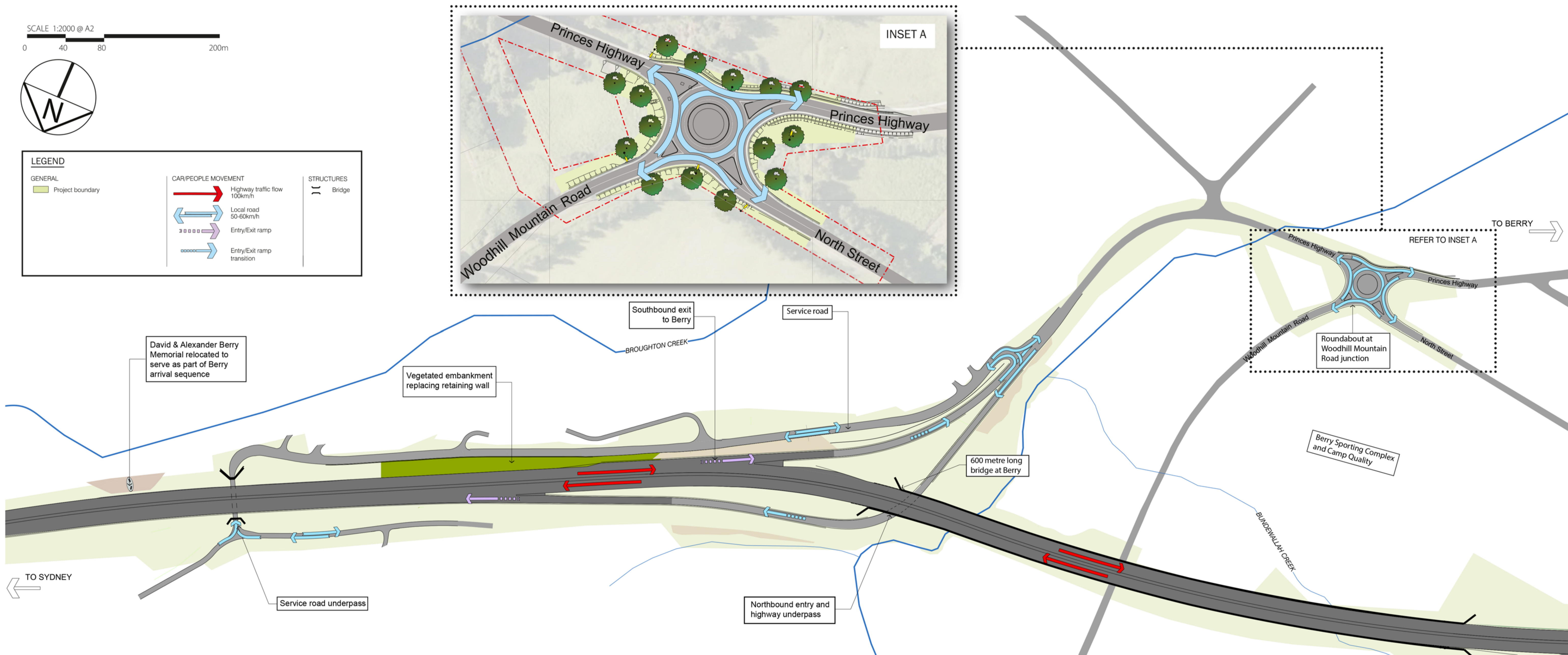

## Berry North Interchange

The Berry North interchange will connect the new bypass to the Berry township.

- Motorists travelling southbound into Berry will exit via a ramp to the Berry North roundabout to be built at the junction of Woodhill Mountain Road, North Street, Queen Street and the existing Princes Highway.

- Northbound entry to the bypass will be via an entry ramp passing under Berry Bridge. Local property access will be maintained via a service road and an associated underpass.

### Changes from Approved Concept Design:

No major changes have been proposed to the Approved Concept Design.

- The retaining wall on the northbound entry ramp on the eastern side of Berry Bridge will be replaced with a vegetated embankment to improve safety and visual impacts.