



Australian Government

**BUILDING OUR FUTURE**



November 2018

## Night work on Great Western Highway, Blackheath from Monday 12 November

The Australian and New South Wales governments are upgrading the Great Western Highway between Katoomba and Lithgow to improve traffic flow, safety and travel conditions.

Major work has now started at Blackheath. Work in Blackheath includes widening the highway shoulders and providing dedicated turn lanes and other safety work.

As part of this work, we will:

- install temporary road safety barriers along the Great Western Highway to mark out the site between Sutton Park and Sturt Street. This will ensure the safety of the local community and our workers. We will remove the barriers at the end of the project.
- carry out investigation work to find the location of underground utilities. Investigations will involve digging a series of small exploratory holes in the footpath, road and road reserve. Any disturbed areas will be temporarily restored to allow continued use.
- install project signage up to one kilometre on either side of the project area at Blackheath.

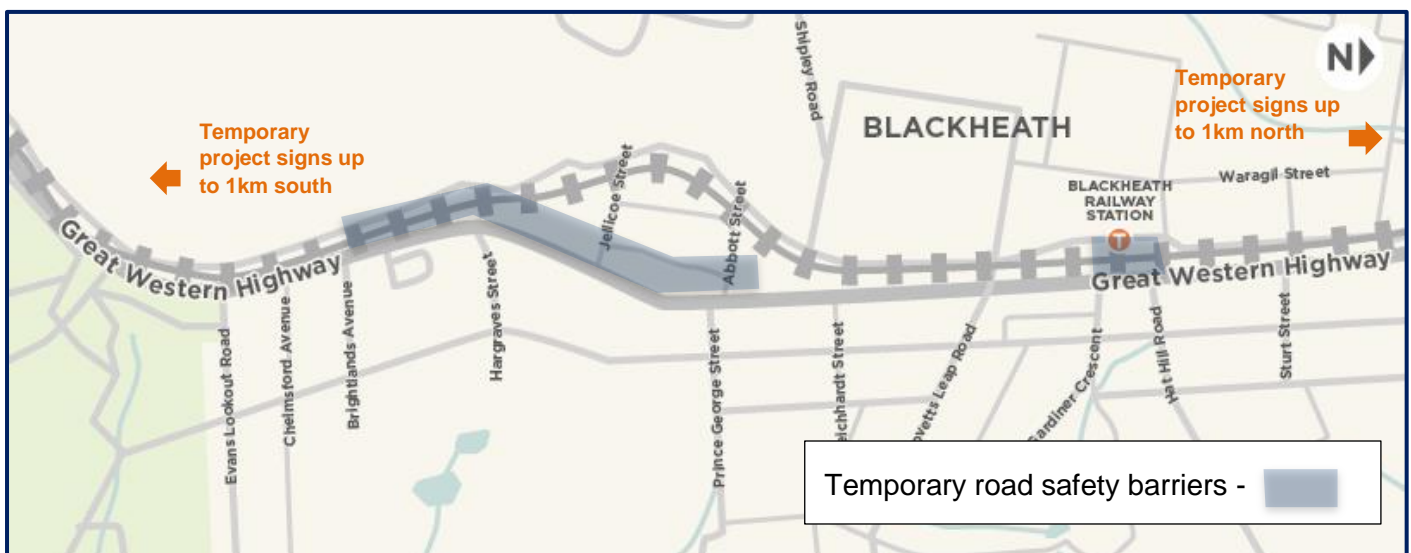

## Our work schedule

To minimise the impact to road users, we will carry out this work at night. There will be up to **18 shifts of work** between **Monday 12 November** and **Friday 7 December** 2018, weather permitting. Work hours will be between **8pm and 5am**.

### How will the work affect you?

This work will be noisy and there'll be an increase in vehicle movements. We will need to saw-cut the road surface and dig exploratory holes. Traffic control will ensure the safety of workers and the community while we are working. Lighting will be directed away from residential properties. Every effort will be made to minimise impacts on you.

### Traffic changes

There will be temporary traffic changes during our work hours to ensure the work zone is safe. Lane closures will be in place and may affect travel times.

As part of the work we will remove the overtaking lane between Sutton Park and Abbott Street, and highway access to Jellicoe Street. Residents in the area should use Abbott Street for access to and from the Great Western Highway.

There will also be reduced parking available at the War Memorial between Gardiner Crescent and Hat Hill Road.

Please keep to speed limits and follow signs and traffic controllers' directions. For the latest traffic updates, you can call 132 701, visit [livetraffic.com](http://livetraffic.com) or download the Live Traffic NSW App.

## Contact

If you have any questions, please contact our delivery partner, Diona Pty Ltd, on 1800 035 733 or email [K2Lupgrade@rms.nsw.gov.au](mailto:K2Lupgrade@rms.nsw.gov.au).

For more information on our projects, visit [rms.nsw.gov.au](http://rms.nsw.gov.au).

Thank you for your patience during this important work.