

OCTOBER 2013

M1 Pacific Motorway widening

Between the Tuggerah and Doyalson interchanges



Roads and Maritime Services is planning an upgrade of the M1 Pacific Motorway (formerly the F3 Freeway) between the Tuggerah and Doyalson interchanges to improve traffic flow and safety.

The proposed upgrade involves widening the motorway to provide three lanes in each direction, as well as rebuilding the roadway to provide a smoother and more durable surface.

Stakeholders and the community are invited to comment on the proposed upgrade by **29 November 2013**. Roads and Maritime will consider this feedback in finalising the concept design.

Background

The M1 Pacific Motorway is a critical link in the National Land Transport Network and is part of the Sydney to Brisbane corridor, which is one of the busiest transport corridors in Australia.

The 12 kilometre section between Wyong Road at Tuggerah and the Doyalson Link Road is currently two lanes in each direction and has the highest volume of traffic of the remaining four lane sections between Sydney and the end of the motorway at Beresfield. It is used by through traffic and traffic from north of Wyong accessing the Central Coast.

The proposed upgrade would cater for the expected increase in traffic forecast as a result of predicted growth in the Central Coast, Hunter Region and North Coast along with greater freight demand.



The proposal

The proposed upgrade includes:

- Widening a 12 kilometre section of the motorway to provide three lanes in each direction between Wyong Road at Tuggerah and the Doyalson Link Road
- Rebuilding a nine kilometre section of the motorway between Wyong River and the Doyalson interchange to improve the road surface
- Improving road drainage for greater wet weather safety
- Providing safety and capacity improvements to key motorway interchanges at Warnervale and Doyalson.

Benefits

Key benefits of the proposed upgrade include:

- Increased traffic capacity along the motorway for more reliable travel times
- Improved road safety through providing a smoother, more durable road surface, and improving drainage for stormwater runoff
- Improved safety for motorists at the entry and exit points to the interchanges
- Reduced maintenance costs in the future.

Proposed construction

The proposed upgrade involves widening the motorway into the median to provide the additional lane on each carriageway. Construction would require carriageway closures but two travel lanes in each direction would be maintained during peak periods.

During widening of the southern three kilometre section between the Tuggerah interchange and Deep Creek, traffic would be moved to the road shoulder and a construction zone established in the median. Both carriageways would remain open.

Construction of the remaining nine kilometres between Wyong River and the Doyalson interchange would require closure of one carriageway at a time in order to rebuild the road surface. Two lanes in each direction would be maintained during peak periods with traffic separated by a concrete barrier. This section of work could be carried out in at least two stages to reduce disruption to motorists, while ensuring safe and efficient construction.

An indicative four step process for carrying out the rebuilding and widening of the nine kilometre section is shown in **Diagram 1**.

Key impacts

The proposed construction activities would be disruptive for motorists, nearby residents and a range of stakeholders. Roads and Maritime will work with stakeholders during the planning process to understand and consider any issues of concern.

Construction impacts may include:

- Delays and disruptions to traffic flow due to lane and carriageway closures
- Changed traffic conditions including reduced speed limits during construction
- Night work would be required and may cause noise and lighting impacts for nearby residents
- Existing access to the service centres may be temporarily affected and alternative access arrangements would be made
- Disruption or temporary closure of informal parking areas at the Warnervale interchange
- Cyclists would be unable to use the motorway between the Tuggerah and Doyalson interchanges during construction. Roads and Maritime will work with the cycling community to identify alternative cycling routes.

Diagram 1: Wyong River to Doyalson interchange – Indicative traffic arrangements during construction

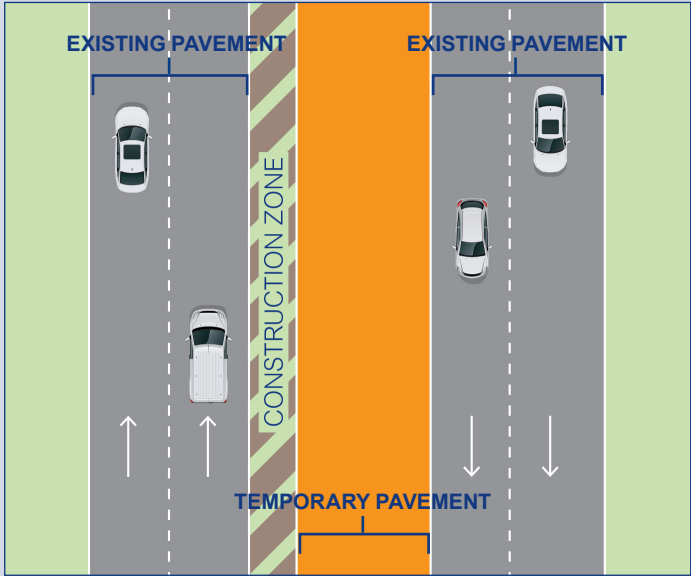

Step 1
Traffic in each direction would be moved over in two lanes. Temporary road widening would occur to widen one carriageway to safely carry four lanes of traffic.

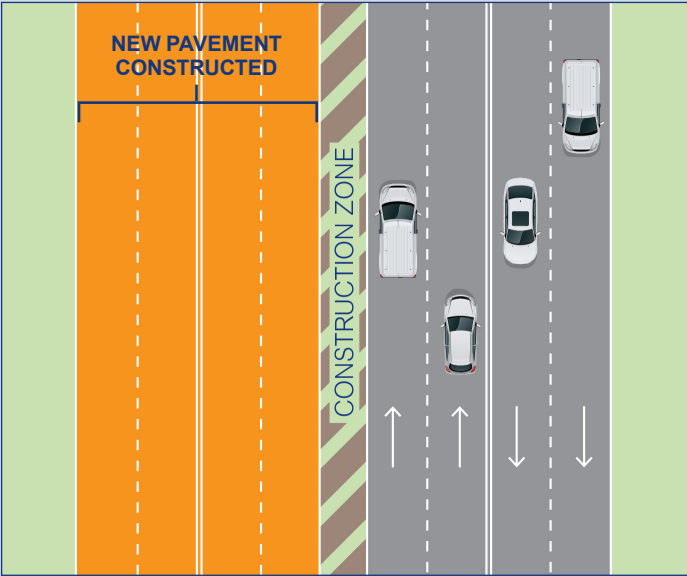

Step 2
A traffic switch would be carried out in order for all four lanes of traffic to operate on one carriageway. During this stage the other carriageway would be rebuilt.

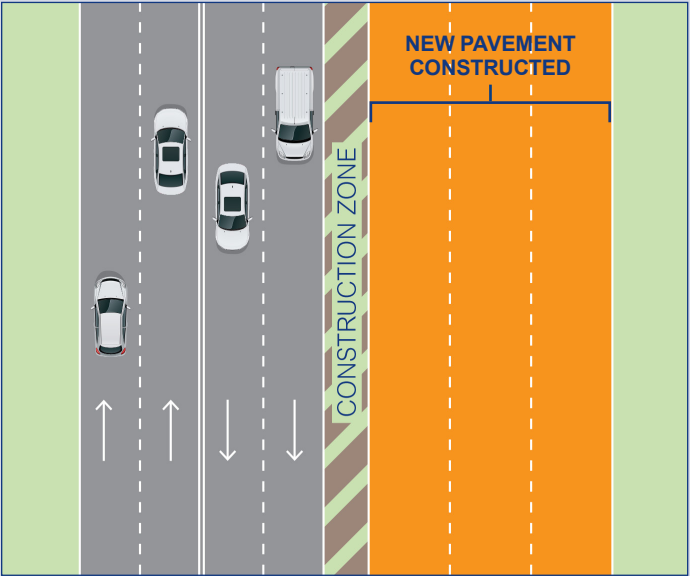

Step 3
All four lanes of traffic would be moved to the newly built carriageway. During this stage the construction contractor would rebuild the remaining carriageway.

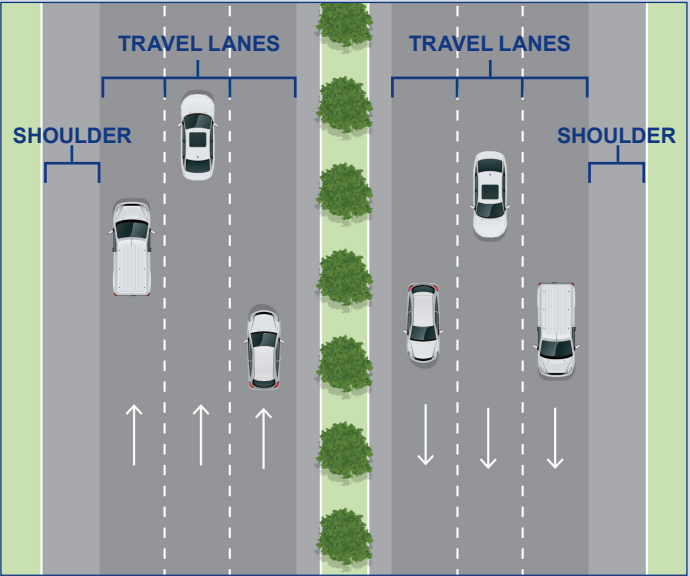

Step 4
Traffic would be returned to two carriageways, operating as three lanes in each direction.

Involving the community and stakeholders

Roads and Maritime will work with the community and stakeholders during the planning process to identify issues and minimise potential impacts of the proposed upgrade and construction activities.

Stakeholders and the community are invited to comment on the proposed upgrade by 29 November 2013.

Roads and Maritime will consider the feedback received when finalising the environmental assessment and concept design.

Next steps

Upcoming planning activities include:

- Community and stakeholder discussions
- Consultation with nearby residents
- Review of environmental factors

The timing of construction has not yet been confirmed.

Please send us your feedback by:

Phoning: Simon Cusack, Project Manager on (02) 4379 7001 (during business hours)

Emailing: Central.Coast.Office@rms.nsw.gov.au

Writing to: Simon Cusack, Project Manager
RMS Central Coast office
PO Box 766
Woy Woy NSW 2256

Information is also available on the website at rms.nsw.gov.au



This paper is • carbon neutral • Australian-made • recycled fibre • elemental chlorine free • pulp derived from sustainably managed sources



Privacy Your personal information in correspondence is collected for the sole purpose of assisting in the assessment of the proposal. All information received, including names and addresses of respondents, may be published in subsequent assessment documents unless a clear indication is given in the correspondence that such information is not to be published. Otherwise the RMS will only disclose your personal information, without your consent, if authorised by law. Your personal information will be held by the RMS at Central Coast Office, Upper Level, The Pavilion, 29-37 George Street, Woy Woy, NSW, 2256. You have the right to access and correct the information if you believe that it is incorrect.