

Back Creek Overtaking Lanes North of West Wyalong



Australian Government



Transport for NSW

December 2022

The Newell Highway Program Alliance (NHPA) is excited to announce the completion of overtaking lanes at Back Creek, about 19 kilometres north of West Wyalong. The completed work adds an additional three kilometres of northbound and southbound overtaking lanes on the Newell Highway.

The NHPA is jointly funded by the Australian Government and the NSW Government to deliver about 40 overtaking lanes over four years on the Newell Highway.

The NHPA has now completed 27 overtaking lanes

adding more than 40 kilometres of travel efficiency since it started in early 2019.

The overtaking lanes will improve safety, reduce travel times and improve freight efficiency as part of the \$1.7 billion Newell Highway upgrade.

Work on the Back Creek overtaking lanes started in November 2021 and through effective traffic management measures motorists experienced delays of less than two minutes during construction.

We thank you for your patience during these works.



Improving
safety



Increase
overtaking opportunities



Working with local
communities



Travel
time savings

Back Creek overtaking lanes



For more information about the NHPA or other overtaking lanes we are working on, please contact the project team on:

e info@newellhpa.com.au

t 1800 577 295

i For more information visit: nswroads.work/nhpa

Back Creek overtaking lanes and safety improvement works north of West Wyalong

Fast facts

- 185 total workers employed
- 51 local workers
- 21 Aboriginal workers
- 28 female workers
- 22 workers under 25
- 120 tonnes of carbon dioxide saved through on-site solar panels
- 12,500m³ of dirt excavated and reused on site equal to 5 Olympic swimming pools
- No potable water used for construction

Pub No. 22.335

Map showing the location of Back Creek overtaking lanes

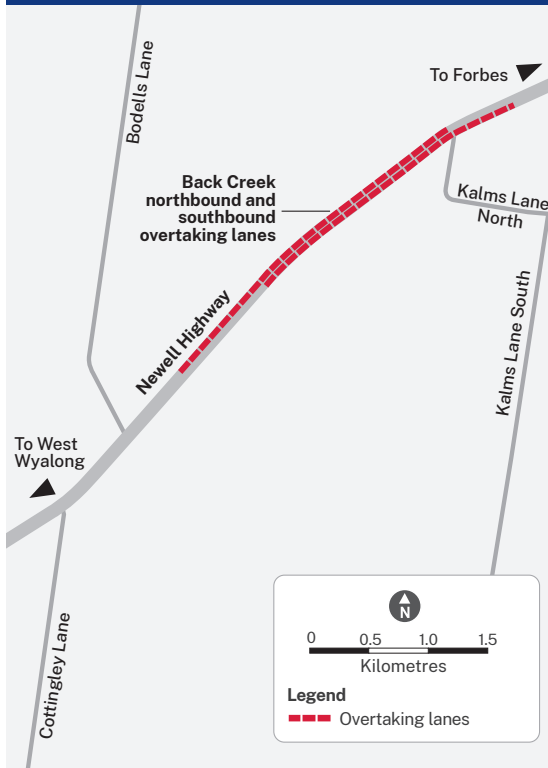

Back Creek site office with solar panels



Overtaking signage along Back Creek

