



FROM BLACKTOWN

TO RICHMOND

LEGEND

GENERAL

- SURVEY
- LOT 3 / DP106825
- CADASTRAL LOT AND DP NUMBER
- EXISTING CADASTRAL BOUNDARY
- PROPOSED ROAD BOUNDARY
- REF BOUNDARY
- CONSTRUCTION COMPOUND
- EXISTING PAVEMENT
- EXISTING STORMWATER PIT / PIPE / HEADWALL TO BE DECOMMISSIONED
- EXISTING STORMWATER PIT / PIPE / HEADWALL TO BE RETAINED
- NEW STORMWATER PIT / PIPE / HEADWALL

NEW UTILITIES

- EU NEW UNDERGROUND ELECTRICAL
- NEW OVERHEAD ELECTRICAL
- NEW ELECTRICAL POLE
- NEW STREET LIGHT
- HG NEW HIGH PRESSURE GAS
- TC NEW COMMUNICATIONS

EXISTING UTILITIES TO REMAIN

- E EXISTING OVERHEAD ELECTRICAL
- EU(B) EXISTING ELECTRICAL - UNDERGROUND
- EXISTING ELECTRICAL POLE
- EXISTING STREET LIGHT
- TC(B) EXISTING COMMUNICATIONS (TELEPHONE LINE)
- OC(B) EXISTING COMMUNICATIONS (OPTIC FIBRE)
- T(D) EXISTING TELEPHONE LINE OVERHEAD
- W(B) EXISTING WATER MAIN
- G(D) EXISTING GAS MAIN

EXISTING UTILITIES TO BE REMOVED

- E EXISTING OVERHEAD ELECTRICAL
- EU(B) EXISTING ELECTRICAL - UNDERGROUND
- EXISTING ELECTRICAL POLE
- EXISTING STREET LIGHT
- TC(B) EXISTING COMMUNICATIONS (TELEPHONE LINE)
- OC(B) EXISTING COMMUNICATIONS (OPTIC FIBRE)

TRAFFIC CONTROL SIGNAL

- TCS POST
- TCS CONTROLLER
- TCS PIT
- TCS LOOPDETECTOR
- MAST ARM
- TCS CABLE

RMD XX... UTILITY ASSET TAG - REFER TO UTILITY MANAGEMENT PLAN FOR TAG DESCRIPTIONS

NOTES

1. FOR GENERAL NOTES REFER SHEET GE-0031 TO GE-0032.
2. UTILITY LOCATION TO BE CONFIRMED BY FIELD POTHOLING PRIOR TO CONSTRUCTION.
3. (QL(x)) x DENOTES CLASSIFICATION OF SUB-SURFACE UTILITY INFORMATION STANDARDS AS 5488 QUALITY LEVEL.

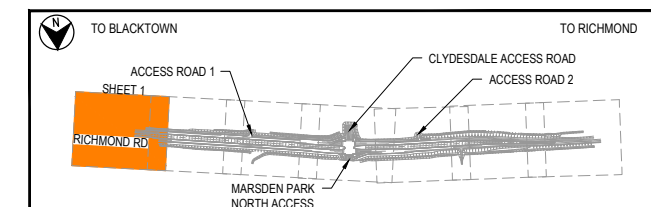

KEY PLAN
NTS

NOT FOR CONSTRUCTION

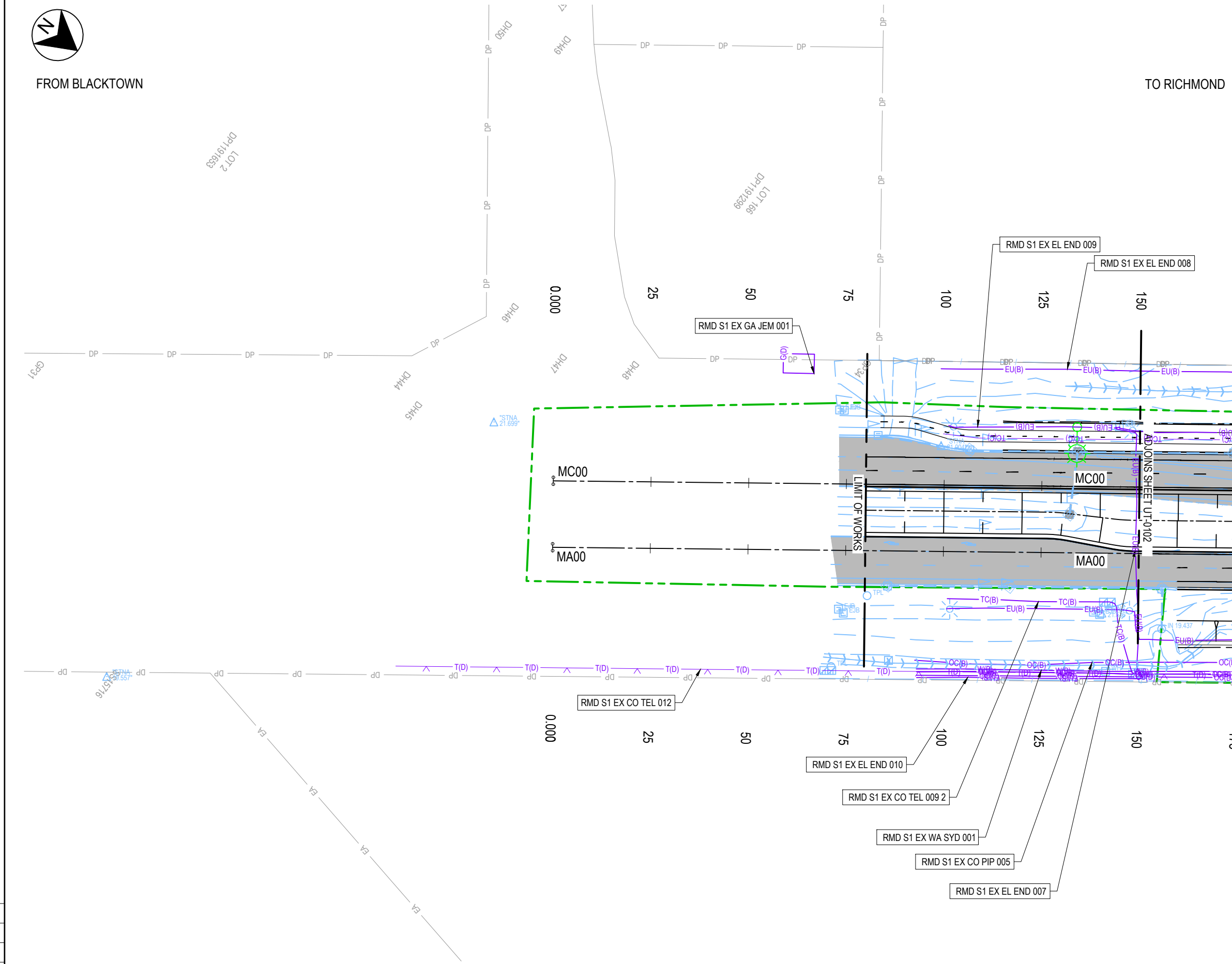

THIS DRAWING MAY BE PREPARED IN COLOUR AND MAY BE INCOMPLETE IF COPIED

DRAWING FILE LOCATION \ NAME C:\users\bojiss\appdata\local\projectwise\jacobs_anz_ie\d0362266\RRU-IA301400-DG-UT-0101-0107.dwg		PLOT DATE \ TIME 6/17/2020 4:55:02 PM		PLOT BY Bojiss		PROJECT BREAKDOWN STRUCTURE		JACOBS DOCUMENT NUMBER RRU-IA301400-DG-UT-0101		PLOT DATE / TIME 17/06/2020		PLOT BY Bojiss		CLIENT Transport for NSW		BLACKTOWN CITY COUNCIL MR537 - RICHMOND ROAD ELARA BOULEVARD TO ACCESS ROAD 2, MARSDEN PARK UTILITY COORDINATION PLAN		SHEET 1 OF 7							
DESIGN MODEL FILE(S) USED FOR DOCUMENTATION OF THIS DRAWING 12D_RRU_IA301400-DM-UT-0001_EXISTING.12da 12D_RRU_IA301400-DM-UT-0002_PROPOSED.12da		REV 0	DATE 18.06.2020	AMENDMENT / REVISION DESCRIPTION ISSUED FOR DESIGN FOR REF		APPROVAL K.LAU	SCALES ON A3 SIZE DRAWING SCALE 1:1000 		DRAWINGS / DESIGN PREPARED BY Jacobs Group (Australia) Pty Ltd Level 7, 171 Pacific Highway North Sydney, NSW 2060 AUSTRALIA Tel: +61 2 9928 2100 Fax: +61 2 9928 2500 Web: www.jacobs.com		TITLE DRAWN I.IMEDI 18.06.2020		NAME S.GALLOWAY 18.06.2020		DATE 18.06.2020		RMS REGISTRATION No. DS2020/000286		PART UT						
						CO-ORDINATE SYSTEM MGA ZONE 56		HEIGHT DATUM AHD		DESIGN CHECK S.RUSCHEINSKY 18.06.2020		DESIGN MNGR M.O'ROURKE 18.06.2020		PROJECT MNGR K.LAU 18.06.2020		PREPARED FOR REGIONAL PROJECT OFFICE ROADS AND MARITIME SERVICES		ISSUE STATUS DESIGN FOR REF		EDMS No.		SHEET No. UT-0101		REV 0	

A3

PART
UT

REV
0

© Transport for NSW



FROM BLACKTOWN

TO RICHMOND

LEGEND

- GENERAL**
- SURVEY
 - LOT 3 / DP106825
 - EXISTING CADASTRIAL BOUNDARY
 - PROPOSED ROAD BOUNDARY
 - REF BOUNDARY
 - CONSTRUCTION COMPOUND
 - EXISTING PAVEMENT
 - EXISTING STORMWATER PIT / PIPE / HEADWALL TO BE DECOMMISSIONED
 - EXISTING STORMWATER PIT / PIPE / HEADWALL TO BE RETAINED
 - NEW STORMWATER PIT / PIPE / HEADWALL
- NEW UTILITIES**
- NEW UNDERGROUND ELECTRICAL
 - NEW OVERHEAD ELECTRICAL
 - NEW ELECTRICAL POLE
 - NEW STREET LIGHT
 - NEW HIGH PRESSURE GAS
 - NEW COMMUNICATIONS
- EXISTING UTILITIES TO REMAIN**
- EXISTING OVERHEAD ELECTRICAL
 - EXISTING ELECTRICAL - UNDERGROUND
 - EXISTING ELECTRICAL POLE
 - EXISTING STREET LIGHT
 - EXISTING COMMUNICATIONS (TELEPHONE LINE)
 - EXISTING COMMUNICATIONS (OPTIC FIBRE)
 - EXISTING TELEPHONE LINE OVERHEAD
 - EXISTING WATER MAIN
 - EXISTING GAS MAIN
- EXISTING UTILITIES TO BE REMOVED**
- EXISTING OVERHEAD ELECTRICAL
 - EXISTING ELECTRICAL - UNDERGROUND
 - EXISTING ELECTRICAL POLE
 - EXISTING STREET LIGHT
 - EXISTING COMMUNICATIONS (TELEPHONE LINE)
 - EXISTING COMMUNICATIONS (OPTIC FIBRE)
- TRAFFIC CONTROL SIGNAL**
- TCS POST
 - TCS CONTROLLER
 - TCS PIT
 - TCS LOOPDETECTOR
 - MAST ARM
 - TCS CABLE
- UTILITY ASSET TAG - REFER TO UTILITY MANAGEMENT PLAN FOR TAG DESCRIPTIONS

NOTES

- FOR GENERAL NOTES REFER SHEET GE-0031 TO GE-0032.
- UTILITY LOCATION TO BE CONFIRMED BY FIELD POTHOLING PRIOR TO CONSTRUCTION.
- (QL(x)) x DENOTES CLASSIFICATION OF SUB-SURFACE UTILITY INFORMATION STANDARDS AS 5488 QUALITY LEVEL.

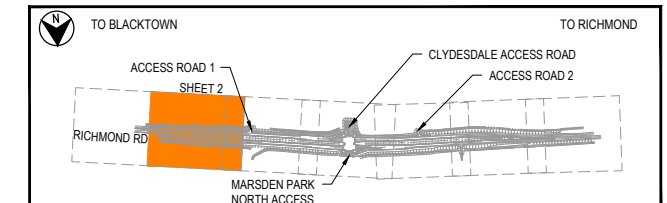

KEY PLAN
NTS

NOT FOR CONSTRUCTION

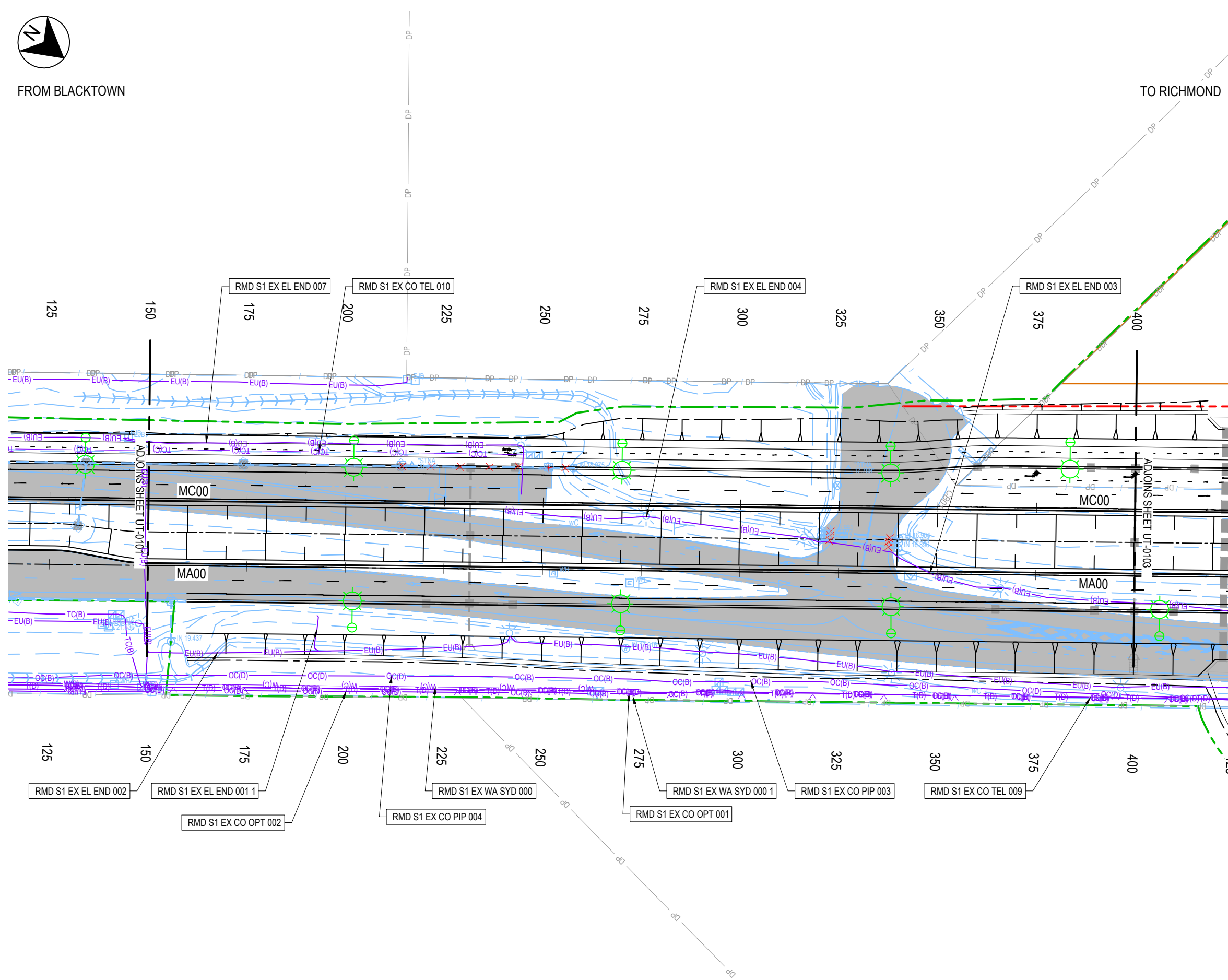

THIS DRAWING MAY BE PREPARED IN COLOUR AND MAY BE INCOMPLETE IF COPIED

50mm ON A3 SIZE ORIGINAL

DRAWING FILE LOCATION \ NAME C:\users\bojiss\appdata\local\projectwise\jacobs_anz_ie\0362266\RRU-IA301400-DG-UT-0101-0107.dwg		PLOT DATE \ TIME 6/17/2020 4:55:04 PM		PLOT BY Bojiss		PROJECT BREAKDOWN STRUCTURE		JACOBS DOCUMENT NUMBER RRU-IA301400-DG-UT-0102		PLOT DATE / TIME 17/06/2020		PLOT BY Bojiss		CLIENT 		BLACKTOWN CITY COUNCIL MR537 - RICHMOND ROAD ELARA BOULEVARD TO ACCESS ROAD 2, MARSDEN PARK UTILITY COORDINATION PLAN		A3			
DESIGN MODEL FILE(S) USED FOR DOCUMENTATION OF THIS DRAWING 12D_RRU_IA301400-DM-UT-0001_EXISTING.12da 12D_RRU_IA301400-DM-UT-0002_PROPOSED.12da		REV 0		DATE 18.06.2020		AMENDMENT / REVISION DESCRIPTION ISSUED FOR DESIGN FOR REF		APPROVAL K.LAU		SCALES ON A3 SIZE DRAWING SCALE 1:1000 AT A3		DRAWINGS / DESIGN PREPARED BY 		TITLE DRAWN I.JIMEDI 18.06.2020 DRG CHECK S.GALLOWAY 18.06.2020 DESIGN L.AGUNG 18.06.2020 DESIGN CHECK S.RUSCHINSKY 18.06.2020 DESIGN MNGR M.O'ROURKE 18.06.2020 PROJECT MNGR K.LAU 18.06.2020		PREPARED FOR REGIONAL PROJECT OFFICE ROADS AND MARITIME SERVICES		RMS REGISTRATION No. DS2020/000286		PART UT	
CO-ORDINATE SYSTEM MGA ZONE 56		HEIGHT DATUM AHD		JACOBS GROUP (AUSTRALIA) PTY LTD Level 7, 171 Pacific Highway North Sydney, NSW 2060 AUSTRALIA Tel: +61 2 9928 2100 Fax: +61 2 9928 2500 Web: www.jacobs.com		ISSUE STATUS DESIGN FOR REF		EDMS No.		SHEET No. UT-0102		REV 0		SHEET 2 OF 7		© Transport for NSW					



FROM BLACKTOWN

TO RICHMOND

LEGEND

GENERAL

- SURVEY
- CADASTRAL LOT AND DP NUMBER
- EXISTING CADASTRIAL BOUNDARY
- PROPOSED ROAD BOUNDARY
- REF BOUNDARY
- CONSTRUCTION COMPOUND
- EXISTING PAVEMENT
- EXISTING STORMWATER PIT / PIPE / HEADWALL TO BE DECOMMISSIONED
- EXISTING STORMWATER PIT / PIPE / HEADWALL TO BE RETAINED
- NEW STORMWATER PIT / PIPE / HEADWALL

NEW UTILITIES

- NEW UNDERGROUND ELECTRICAL
- NEW OVERHEAD ELECTRICAL
- NEW ELECTRICAL POLE
- NEW STREET LIGHT
- NEW HIGH PRESSURE GAS
- NEW COMMUNICATIONS

EXISTING UTILITIES TO REMAIN

- EXISTING OVERHEAD ELECTRICAL
- EXISTING ELECTRICAL - UNDERGROUND
- EXISTING ELECTRICAL POLE
- EXISTING STREET LIGHT
- EXISTING COMMUNICATIONS (TELEPHONE LINE)
- EXISTING COMMUNICATIONS (OPTIC FIBRE)
- EXISTING TELEPHONE LINE OVERHEAD
- EXISTING WATER MAIN
- EXISTING GAS MAIN

EXISTING UTILITIES TO BE REMOVED

- EXISTING OVERHEAD ELECTRICAL
- EXISTING ELECTRICAL - UNDERGROUND
- EXISTING ELECTRICAL POLE
- EXISTING STREET LIGHT
- EXISTING COMMUNICATIONS (TELEPHONE LINE)
- EXISTING COMMUNICATIONS (OPTIC FIBRE)

TRAFFIC CONTROL SIGNAL

- TCS POST
- TCS CONTROLLER
- TCS PIT
- TCS LOOPDETECTOR
- MAST ARM
- TCS CABLE

RMD XX... UTILITY ASSET TAG - REFER TO UTILITY MANAGEMENT PLAN FOR TAG DESCRIPTIONS

NOTES

1. FOR GENERAL NOTES REFER SHEET GE-0031 TO GE-0032.
2. UTILITY LOCATION TO BE CONFIRMED BY FIELD POTHOLING PRIOR TO CONSTRUCTION.
3. (QL(x)) x DENOTES CLASSIFICATION OF SUB-SURFACE UTILITY INFORMATION STANDARDS AS 5488 QUALITY LEVEL.

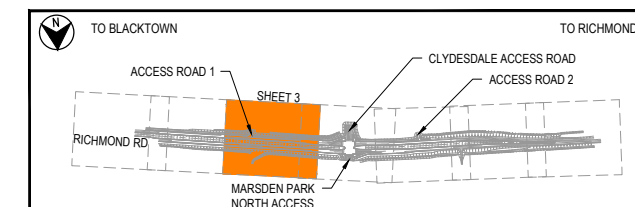

KEY PLAN
NTS

NOT FOR CONSTRUCTION

THIS DRAWING MAY BE PREPARED IN COLOUR AND MAY BE INCOMPLETE IF COPIED

150mm ON A3 SIZE ORIGINAL

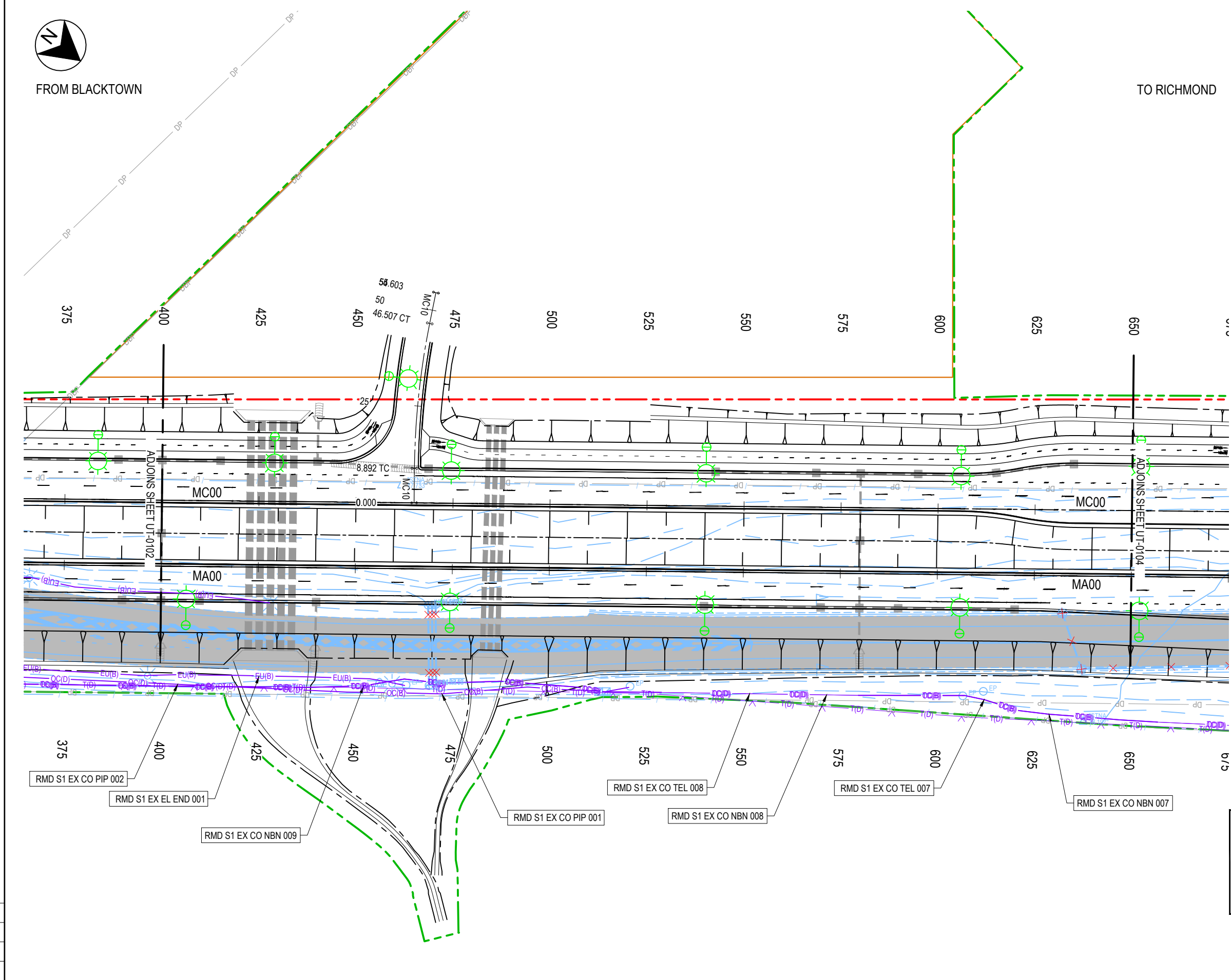

<p>DRAWING FILE LOCATION \ NAME: C:\users\bojiss\appdata\local\projectwise\jacobs_anz_id\0362266\RRU-IA301400-DG-UT-0101-0107.dwg</p> <p>PLOT DATE \ TIME: 6/17/2020 4:55:05 PM</p> <p>PLOT BY: Bojiss</p>	<p>PROJECT BREAKDOWN STRUCTURE</p> <p>RRU-IA301400-DG-UT-0103</p>	<p>JACOBS DOCUMENT NUMBER</p> <p>RRU-IA301400-DG-UT-0103</p>	<p>PLOT DATE / TIME</p> <p>17/06/2020</p> <p>PLOT BY</p> <p>Bojiss</p>	<p>CLIENT</p>	<p>BLACKTOWN CITY COUNCIL</p> <p>MR537 - RICHMOND ROAD</p> <p>ELARA BOULEVARD TO ACCESS ROAD 2,</p> <p>MARSDEN PARK</p> <p>UTILITY COORDINATION</p> <p>PLAN</p> <p>SHEET 3 OF 7</p>																					
<p>DESIGN MODEL FILE(S) USED FOR DOCUMENTATION OF THIS DRAWING</p> <p>12D_RRU_IA301400-DM-UT-0001_EXISTING.12da</p> <p>12D_RRU_IA301400-DM-UT-0002_PROPOSED.12da</p>	<p>REV</p> <p>0</p> <p>DATE</p> <p>18.06.2020</p> <p>AMENDMENT / REVISION DESCRIPTION</p> <p>ISSUED FOR DESIGN FOR REF</p>	<p>APPROVAL</p> <p>K.LAU</p>	<p>SCALES ON A3 SIZE DRAWING</p> <p>SCALE 1:1000</p> <p>AT A3</p> <p>CO-ORDINATE SYSTEM</p> <p>MGA ZONE 56</p> <p>HEIGHT DATUM</p> <p>AHD</p>	<p>DRAWINGS / DESIGN PREPARED BY</p> <p>Jacobs Group (Australia) Pty Ltd</p> <p>Level 7, 171 Pacific Highway</p> <p>North Sydney, NSW 2060</p> <p>AUSTRALIA</p> <p>Tel: +61 2 9928 2100</p> <p>Fax: +61 2 9928 2500</p> <p>Web: www.jacobs.com</p>	<table border="1" style="width: 100%; border-collapse: collapse;"> <thead> <tr> <th>TITLE</th> <th>NAME</th> <th>DATE</th> </tr> </thead> <tbody> <tr> <td>DRAWN</td> <td>I.JIMEDI</td> <td>18.06.2020</td> </tr> <tr> <td>DRG CHECK</td> <td>S.GALLOWAY</td> <td>18.06.2020</td> </tr> <tr> <td>DESIGN</td> <td>LAGUNG</td> <td>18.06.2020</td> </tr> <tr> <td>DESIGN CHECK</td> <td>S.RUSCHEINSKY</td> <td>18.06.2020</td> </tr> <tr> <td>DESIGN MNGR</td> <td>M.O'ROURKE</td> <td>18.06.2020</td> </tr> <tr> <td>PROJECT MNGR</td> <td>K.LAU</td> <td>18.06.2020</td> </tr> </tbody> </table>	TITLE	NAME	DATE	DRAWN	I.JIMEDI	18.06.2020	DRG CHECK	S.GALLOWAY	18.06.2020	DESIGN	LAGUNG	18.06.2020	DESIGN CHECK	S.RUSCHEINSKY	18.06.2020	DESIGN MNGR	M.O'ROURKE	18.06.2020	PROJECT MNGR	K.LAU	18.06.2020
TITLE	NAME	DATE																								
DRAWN	I.JIMEDI	18.06.2020																								
DRG CHECK	S.GALLOWAY	18.06.2020																								
DESIGN	LAGUNG	18.06.2020																								
DESIGN CHECK	S.RUSCHEINSKY	18.06.2020																								
DESIGN MNGR	M.O'ROURKE	18.06.2020																								
PROJECT MNGR	K.LAU	18.06.2020																								
<p>PREPARED FOR</p> <p>REGIONAL PROJECT OFFICE</p> <p>ROADS AND MARITIME SERVICES</p>			<p>RMS REGISTRATION No. DS2020/000286</p> <p>ISSUE STATUS</p> <p>DESIGN FOR REF</p>		<p>PART</p> <p>UT</p> <p>REV</p> <p>0</p>																					

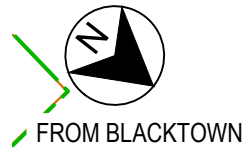

TO RICHMOND

LEGEND

- GENERAL**
- SURVEY
 - LOT 3 / DP106825 CADASTRAL LOT AND DP NUMBER
 - EXISTING CADASTRAL BOUNDARY
 - PROPOSED ROAD BOUNDARY
 - REF BOUNDARY
 - CONSTRUCTION COMPOUND
 - EXISTING PAVEMENT
 - EXISTING STORMWATER PIT / PIPE / HEADWALL TO BE DECOMMISSIONED
 - EXISTING STORMWATER PIT / PIPE / HEADWALL TO BE RETAINED
 - NEW STORMWATER PIT / PIPE / HEADWALL
- NEW UTILITIES**
- EU NEW UNDERGROUND ELECTRICAL
 - NEW OVERHEAD ELECTRICAL
 - NEW ELECTRICAL POLE
 - NEW STREET LIGHT
 - HG NEW HIGH PRESSURE GAS
 - TC NEW COMMUNICATIONS
- EXISTING UTILITIES TO REMAIN**
- E EXISTING OVERHEAD ELECTRICAL
 - EU(B) EXISTING ELECTRICAL - UNDERGROUND
 - EXISTING ELECTRICAL POLE
 - EXISTING STREET LIGHT
 - TC(B) EXISTING COMMUNICATIONS (TELEPHONE LINE)
 - OC(B) EXISTING COMMUNICATIONS (OPTIC FIBRE)
 - T(D) EXISTING TELEPHONE LINE OVERHEAD
 - W(B) EXISTING WATER MAIN
 - G(D) EXISTING GAS MAIN
- EXISTING UTILITIES TO BE REMOVED**
- E EXISTING OVERHEAD ELECTRICAL
 - EU(B) EXISTING ELECTRICAL - UNDERGROUND
 - EXISTING ELECTRICAL POLE
 - EXISTING STREET LIGHT
 - TC(B) EXISTING COMMUNICATIONS (TELEPHONE LINE)
 - OC(B) EXISTING COMMUNICATIONS (OPTIC FIBRE)
- TRAFFIC CONTROL SIGNAL**
- TCS POST
 - TCS CONTROLLER
 - TCS PIT
 - TCS LOOPDETECTOR
 - MAST ARM
 - TCS CABLE
- UTILITY ASSET TAG - REFER TO UTILITY MANAGEMENT PLAN FOR TAG DESCRIPTIONS

NOTES

1. FOR GENERAL NOTES REFER SHEET GE-0031 TO GE-0032.
2. UTILITY LOCATION TO BE CONFIRMED BY FIELD POTHOLING PRIOR TO CONSTRUCTION.
3. (QL(x)) x DENOTES CLASSIFICATION OF SUB-SURFACE UTILITY INFORMATION STANDARDS AS 5488 QUALITY LEVEL.

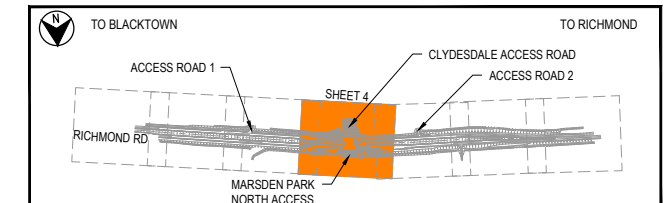

KEY PLAN
NTS

NOT FOR CONSTRUCTION

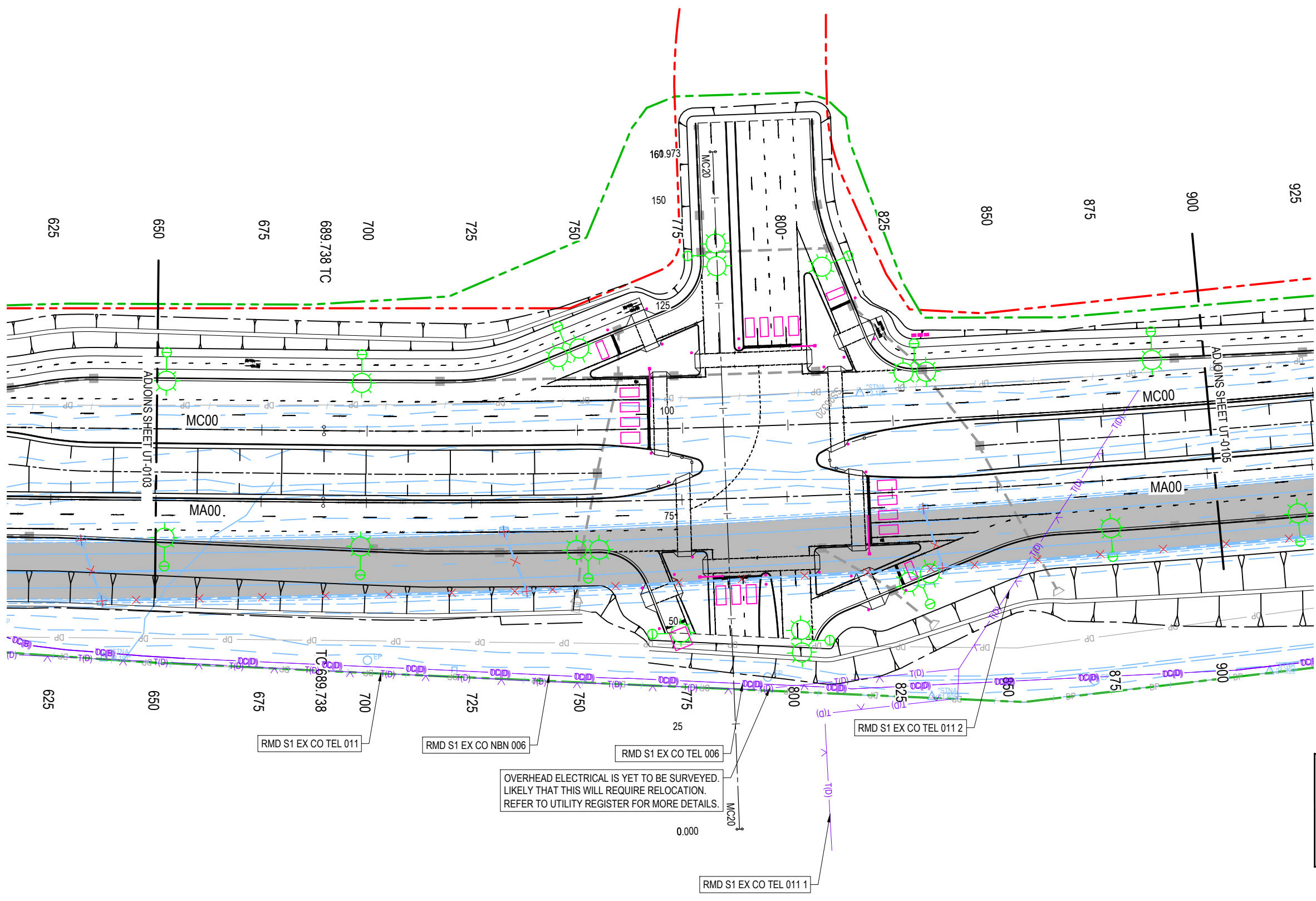

THIS DRAWING MAY BE PREPARED IN COLOUR AND MAY BE INCOMPLETE IF COPIED

150mm ON A3 SIZE ORIGINAL

DRAWING FILE LOCATION \ NAME C:\users\bojiss\appdata\local\projectwise\jacobs_anz_ie\d0362266\RRU-IA301400-DG-UT-0101-0107.dwg	PLOT DATE \ TIME 6/17/2020 4:55:06 PM	PLOT BY Bojiss	PROJECT BREAKDOWN STRUCTURE RRU-IA301400-DG-UT-0104	JACOBS DOCUMENT NUMBER RRU-IA301400-DG-UT-0104	PLOT DATE / TIME 17/06/2020	PLOT BY Bojiss	CLIENT 	BLACKTOWN CITY COUNCIL MR537 - RICHMOND ROAD ELARA BOULEVARD TO ACCESS ROAD 2, MARSDEN PARK UTILITY COORDINATION PLAN	A3																							
DESIGN MODEL FILE(S) USED FOR DOCUMENTATION OF THIS DRAWING 12D_RRU_IA301400-DM-UT-0001_EXISTING.12da 12D_RRU_IA301400-DM-UT-0002_PROPOSED.12da	REV 0	DATE 18.06.2020	AMENDMENT / REVISION DESCRIPTION ISSUED FOR DESIGN FOR REF	APPROVAL K.LAU	SCALES ON A3 SIZE DRAWING 	DRAWINGS / DESIGN PREPARED BY 	<table border="1" style="width: 100%; border-collapse: collapse;"> <thead> <tr> <th>TITLE</th> <th>NAME</th> <th>DATE</th> </tr> </thead> <tbody> <tr> <td>DRAWN</td> <td>I.JIMEDI</td> <td>18.06.2020</td> </tr> <tr> <td>DRG CHECK</td> <td>S.GALLOWAY</td> <td>18.06.2020</td> </tr> <tr> <td>DESIGN</td> <td>LAGUNG</td> <td>18.06.2020</td> </tr> <tr> <td>DESIGN CHECK</td> <td>S.RUSCHEINSKY</td> <td>18.06.2020</td> </tr> <tr> <td>DESIGN MNGR</td> <td>M.O'ROURKE</td> <td>18.06.2020</td> </tr> <tr> <td>PROJECT MNGR</td> <td>K.LAU</td> <td>18.06.2020</td> </tr> </tbody> </table>	TITLE	NAME	DATE	DRAWN	I.JIMEDI	18.06.2020	DRG CHECK	S.GALLOWAY	18.06.2020	DESIGN	LAGUNG	18.06.2020	DESIGN CHECK	S.RUSCHEINSKY	18.06.2020	DESIGN MNGR	M.O'ROURKE	18.06.2020	PROJECT MNGR	K.LAU	18.06.2020		PREPARED FOR REGIONAL PROJECT OFFICE ROADS AND MARITIME SERVICES	RMS REGISTRATION No. DS2020/000286	PART UT
TITLE	NAME	DATE																														
DRAWN	I.JIMEDI	18.06.2020																														
DRG CHECK	S.GALLOWAY	18.06.2020																														
DESIGN	LAGUNG	18.06.2020																														
DESIGN CHECK	S.RUSCHEINSKY	18.06.2020																														
DESIGN MNGR	M.O'ROURKE	18.06.2020																														
PROJECT MNGR	K.LAU	18.06.2020																														
								ISSUE STATUS DESIGN FOR REF	EDMS No.	SHEET No. UT-0104	REV 0																					



FROM BLACKTOWN

TO RICHMOND

LEGEND

- GENERAL**
- SURVEY
 - LOT 3 / DP106825
 - EXISTING CADASTRIAL BOUNDARY
 - PROPOSED ROAD BOUNDARY
 - REF BOUNDARY
 - CONSTRUCTION COMPOUND
 - EXISTING PAVEMENT
 - EXISTING STORMWATER PIT / PIPE / HEADWALL TO BE DECOMMISSIONED
 - EXISTING STORMWATER PIT / PIPE / HEADWALL TO BE RETAINED
 - NEW STORMWATER PIT / PIPE / HEADWALL
- NEW UTILITIES**
- NEW UNDERGROUND ELECTRICAL
 - NEW OVERHEAD ELECTRICAL
 - NEW ELECTRICAL POLE
 - NEW STREET LIGHT
 - NEW HIGH PRESSURE GAS
 - NEW COMMUNICATIONS
- EXISTING UTILITIES TO REMAIN**
- EXISTING OVERHEAD ELECTRICAL
 - EXISTING ELECTRICAL - UNDERGROUND
 - EXISTING ELECTRICAL POLE
 - EXISTING STREET LIGHT
 - EXISTING COMMUNICATIONS (TELEPHONE LINE)
 - EXISTING COMMUNICATIONS (OPTIC FIBRE)
 - EXISTING TELEPHONE LINE OVERHEAD
 - EXISTING WATER MAIN
 - EXISTING GAS MAIN
- EXISTING UTILITIES TO BE REMOVED**
- EXISTING OVERHEAD ELECTRICAL
 - EXISTING ELECTRICAL - UNDERGROUND
 - EXISTING ELECTRICAL POLE
 - EXISTING STREET LIGHT
 - EXISTING COMMUNICATIONS (TELEPHONE LINE)
 - EXISTING COMMUNICATIONS (OPTIC FIBRE)
- TRAFFIC CONTROL SIGNAL**
- TCS POST
 - TCS CONTROLLER
 - TCS PIT
 - TCS LOOPDETECTOR
 - MAST ARM
 - TCS CABLE
- UTILITY ASSET TAG - REFER TO UTILITY MANAGEMENT PLAN FOR TAG DESCRIPTIONS

NOTES

- FOR GENERAL NOTES REFER SHEET GE-0031 TO GE-0032.
- UTILITY LOCATION TO BE CONFIRMED BY FIELD POTHOLING PRIOR TO CONSTRUCTION.
- (QL(x)) x DENOTES CLASSIFICATION OF SUB-SURFACE UTILITY INFORMATION STANDARDS AS 5488 QUALITY LEVEL.

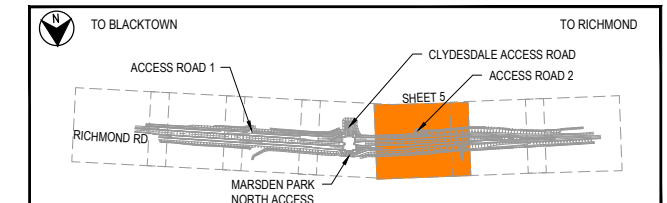

KEY PLAN
NTS

NOT FOR CONSTRUCTION

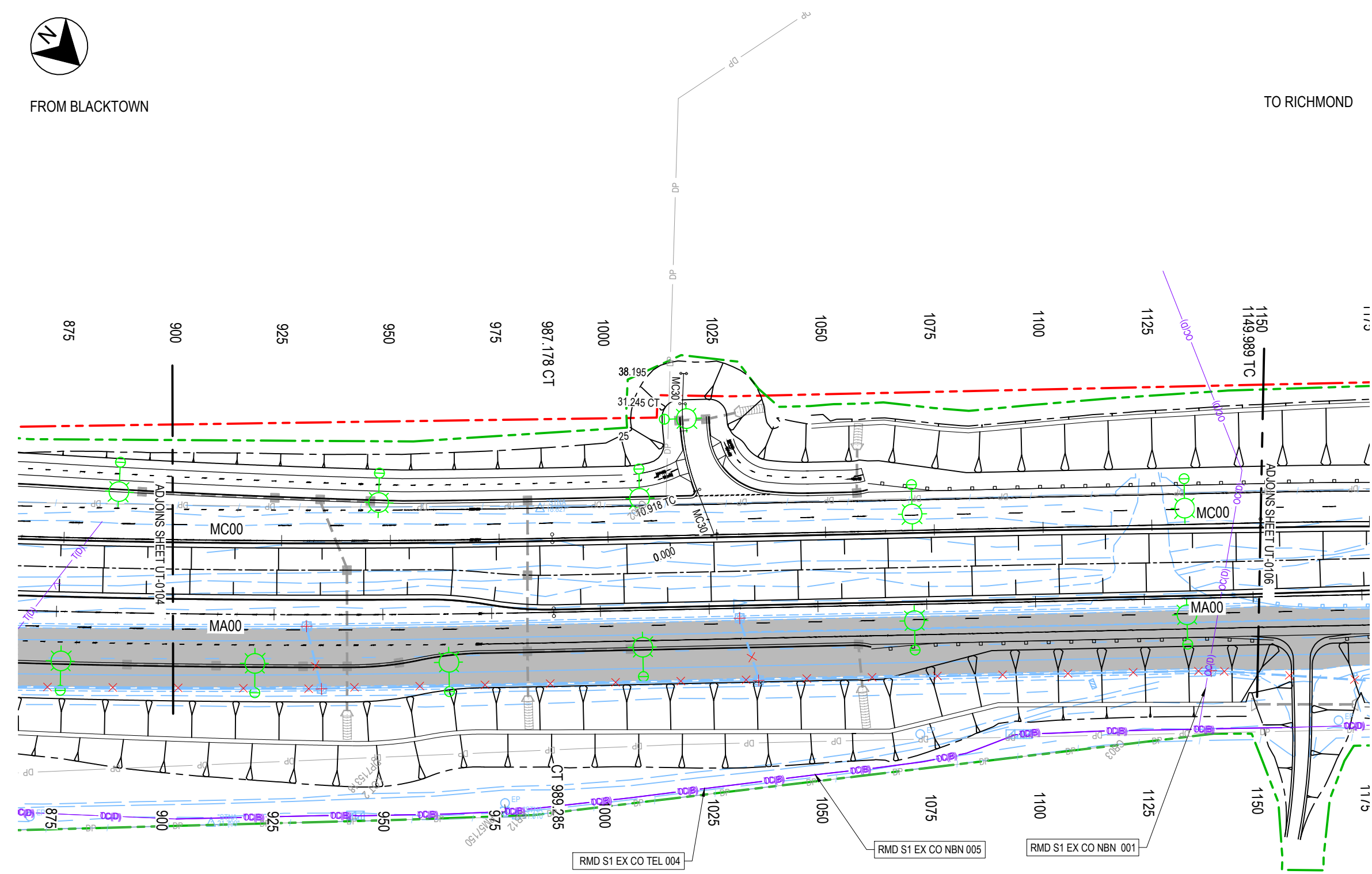

THIS DRAWING MAY BE PREPARED IN COLOUR AND MAY BE INCOMPLETE IF COPIED

150mm ON A3 SIZE ORIGINAL

DRAWING FILE LOCATION \ NAME C:\users\bojiss\appdata\local\projectwise\jacobs_anz_ie\d0362266\RRU-IA301400-DG-UT-0101-0107.dwg		PLOT DATE \ TIME 6/17/2020 4:55:08 PM		PLOT BY Bojiss		PROJECT BREAKDOWN STRUCTURE		JACOBS DOCUMENT NUMBER RRU-IA301400-DG-UT-0105		PLOT DATE / TIME 17/06/2020		PLOT BY Bojiss		CLIENT Transport for NSW		BLACKTOWN CITY COUNCIL MR537 - RICHMOND ROAD ELARA BOULEVARD TO ACCESS ROAD 2, MARSDEN PARK UTILITY COORDINATION PLAN		SHEET 5 OF 7							
DESIGN MODEL FILE(S) USED FOR DOCUMENTATION OF THIS DRAWING 12D_RRU_IA301400-DM-UT-0001_EXISTING.12da 12D_RRU_IA301400-DM-UT-0002_PROPOSED.12da		REV 0		DATE 18.06.2020		AMENDMENT / REVISION DESCRIPTION ISSUED FOR DESIGN FOR REF		APPROVAL K.LAU		SCALES ON A3 SIZE DRAWING SCALE 1:1000 		DRAWINGS / DESIGN PREPARED BY 		TITLE DRAWN I.JIMEDI 18.06.2020		NAME S.GALLOWAY 18.06.2020		DATE							
										DESIGN LAGUNG 18.06.2020		DESIGN CHECK S.RUSCHEINSKY 18.06.2020		DESIGN MNGR M.O'ROURKE 18.06.2020		PROJECT MNGR K.LAU 18.06.2020		PREPARED FOR REGIONAL PROJECT OFFICE ROADS AND MARITIME SERVICES		RMS REGISTRATION No. DS2020/000286		PART UT			
										CO-ORDINATE SYSTEM MGA ZONE 56		HEIGHT DATUM AHD						ISSUE STATUS DESIGN FOR REF		EDMS No.		SHEET No. UT-0105		REV 0	

A3

PART

UT

REV

0

© Transport for NSW



FROM BLACKTOWN

TO RICHMOND

LEGEND

GENERAL

- SURVEY
- LOT 3 / DP106825
- EXISTING CADASTRAL BOUNDARY
- PROPOSED ROAD BOUNDARY
- REF BOUNDARY
- CONSTRUCTION COMPOUND
- EXISTING PAVEMENT
- EXISTING STORMWATER PIT / PIPE / HEADWALL TO BE DECOMMISSIONED
- EXISTING STORMWATER PIT / PIPE / HEADWALL TO BE RETAINED
- NEW STORMWATER PIT / PIPE / HEADWALL

NEW UTILITIES

- NEW UNDERGROUND ELECTRICAL
- NEW OVERHEAD ELECTRICAL
- NEW ELECTRICAL POLE
- NEW STREET LIGHT
- NEW HIGH PRESSURE GAS
- NEW COMMUNICATIONS

EXISTING UTILITIES TO REMAIN

- EXISTING OVERHEAD ELECTRICAL
- EXISTING ELECTRICAL - UNDERGROUND
- EXISTING ELECTRICAL POLE
- EXISTING STREET LIGHT
- EXISTING COMMUNICATIONS (TELEPHONE LINE)
- EXISTING COMMUNICATIONS (OPTIC FIBRE)
- EXISTING TELEPHONE LINE OVERHEAD
- EXISTING WATER MAIN
- EXISTING GAS MAIN

EXISTING UTILITIES TO BE REMOVED

- EXISTING OVERHEAD ELECTRICAL
- EXISTING ELECTRICAL - UNDERGROUND
- EXISTING ELECTRICAL POLE
- EXISTING STREET LIGHT
- EXISTING COMMUNICATIONS (TELEPHONE LINE)
- EXISTING COMMUNICATIONS (OPTIC FIBRE)

TRAFFIC CONTROL SIGNAL

- TCS POST
- TCS CONTROLLER
- TCS PIT
- TCS LOOPDETECTOR
- MAST ARM
- TCS CABLE

UTILITY ASSET TAG - REFER TO UTILITY MANAGEMENT PLAN FOR TAG DESCRIPTIONS

NOTES

- FOR GENERAL NOTES REFER SHEET GE-0031 TO GE-0032.
- UTILITY LOCATION TO BE CONFIRMED BY FIELD POTHOLING PRIOR TO CONSTRUCTION.
- (QL(x)) x DENOTES CLASSIFICATION OF SUB-SURFACE UTILITY INFORMATION STANDARDS AS 5488 QUALITY LEVEL.

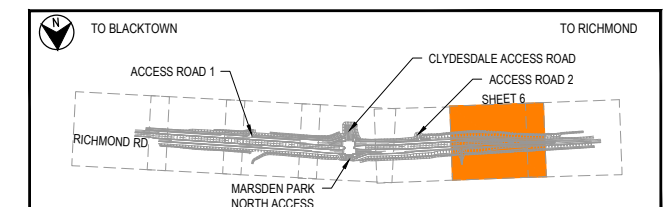

KEY PLAN NTS

NOT FOR CONSTRUCTION

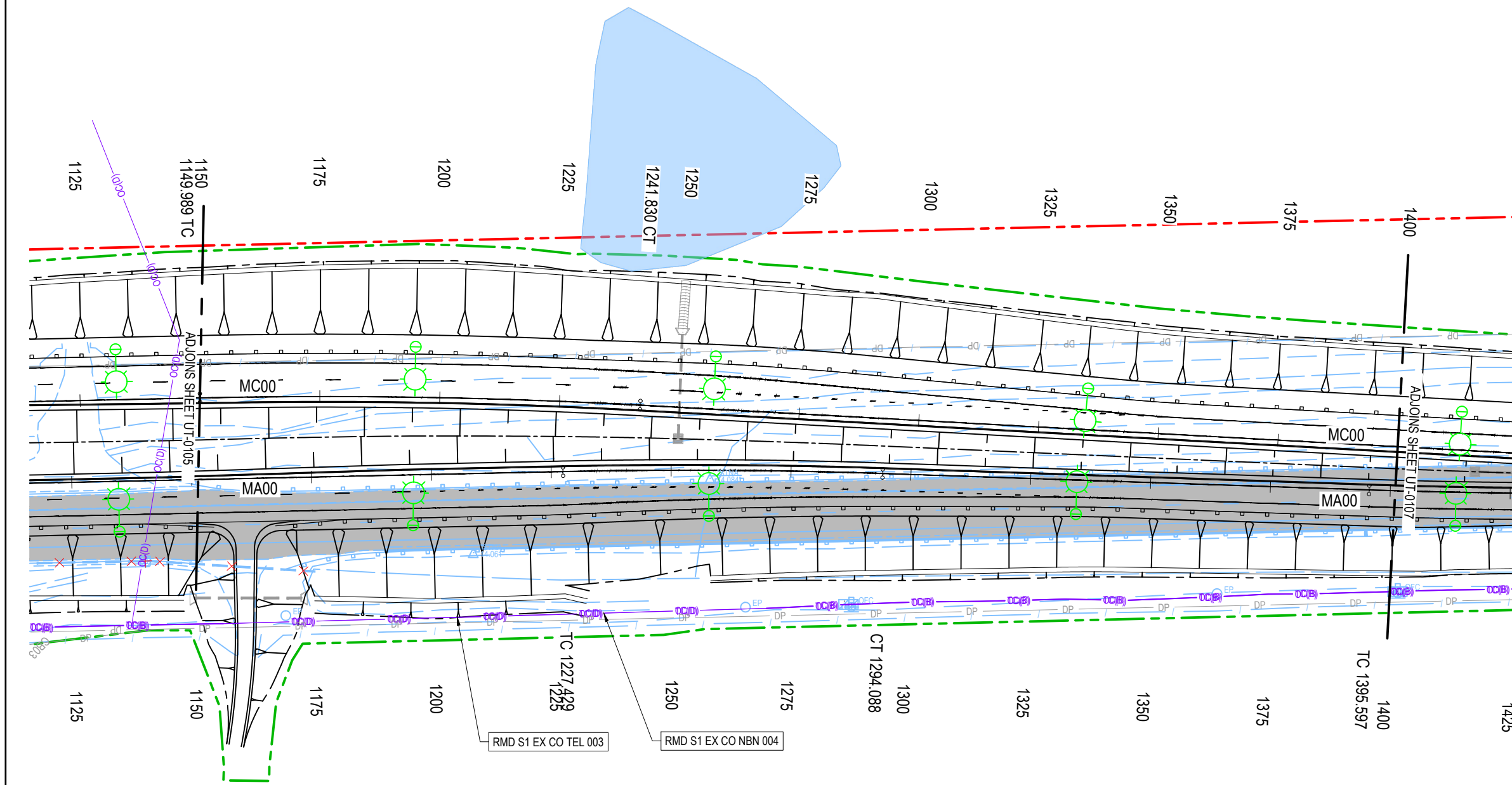

THIS DRAWING MAY BE PREPARED IN COLOUR AND MAY BE INCOMPLETE IF COPIED

DRAWING FILE LOCATION \ NAME C:\users\bojiss\appdata\local\projectwise\jacobs_anz_ie\0362266\RRU-IA301400-DG-UT-0101-0107.dwg		PLOT DATE \ TIME 6/17/2020 4:55:09 PM		PLOT BY Bojiss		PROJECT BREAKDOWN STRUCTURE		JACOBS DOCUMENT NUMBER RRU-IA301400-DG-UT-0106		PLOT DATE / TIME 17/06/2020		PLOT BY Bojiss		CLIENT Transport for NSW		BLACKTOWN CITY COUNCIL MR537 - RICHMOND ROAD ELARA BOULEVARD TO ACCESS ROAD 2, MARSDEN PARK UTILITY COORDINATION PLAN		SHEET 6 OF 7			
DESIGN MODEL FILE(S) USED FOR DOCUMENTATION OF THIS DRAWING 12D_RRU_IA301400-DM-UT-0001_EXISTING.12da 12D_RRU_IA301400-DM-UT-0002_PROPOSED.12da		REV 0		DATE 18.06.2020		AMENDMENT / REVISION DESCRIPTION ISSUED FOR DESIGN FOR REF		APPROVAL K.LAU		SCALES ON A3 SIZE DRAWING SCALE 1:1000 AT A3		DRAWINGS / DESIGN PREPARED BY 		TITLE DRAWN I.JIMEDI 18.06.2020 DRG CHECK S.GALLOWAY 18.06.2020 DESIGN L.AGUNG 18.06.2020 DESIGN CHECK S.RUSCHEINSKY 18.06.2020 DESIGN MNGR M.O'ROURKE 18.06.2020 PROJECT MNGR K.LAU 18.06.2020		PREPARED FOR REGIONAL PROJECT OFFICE ROADS AND MARITIME SERVICES		RMS REGISTRATION No. DS2020/000286		PART UT	
CO-ORDINATE SYSTEM MGA ZONE 56		HEIGHT DATUM AHD		JACOBS GROUP (AUSTRALIA) PTY LTD Level 7, 177 Pacific Highway North Sydney, NSW 2060 AUSTRALIA Tel: +61 2 9928 2100 Fax: +61 2 9928 2500 Web: www.jacobs.com		ISSUE STATUS DESIGN FOR REF		EDMS No.		SHEET No. UT-0106		REV 0		© Transport for NSW							



FROM BLACKTOWN

TO RICHMOND

LEGEND

GENERAL

- SURVEY
- CADASTRAL LOT AND DP NUMBER
- EXISTING CADASTRAL BOUNDARY
- PROPOSED ROAD BOUNDARY
- REF BOUNDARY
- CONSTRUCTION COMPOUND
- EXISTING PAVEMENT
- EXISTING STORMWATER PIT / PIPE / HEADWALL TO BE DECOMMISSIONED
- EXISTING STORMWATER PIT / PIPE / HEADWALL TO BE RETAINED
- NEW STORMWATER PIT / PIPE / HEADWALL

NEW UTILITIES

- EU NEW UNDERGROUND ELECTRICAL
- NEW OVERHEAD ELECTRICAL
- NEW ELECTRICAL POLE
- NEW STREET LIGHT
- NEW HIGH PRESSURE GAS
- TC NEW COMMUNICATIONS

EXISTING UTILITIES TO REMAIN

- EXISTING OVERHEAD ELECTRICAL
- EXISTING ELECTRICAL - UNDERGROUND
- EXISTING ELECTRICAL POLE
- EXISTING STREET LIGHT
- EXISTING COMMUNICATIONS (TELEPHONE LINE)
- EXISTING COMMUNICATIONS (OPTIC FIBRE)
- EXISTING TELEPHONE LINE OVERHEAD
- EXISTING WATER MAIN
- EXISTING GAS MAIN

EXISTING UTILITIES TO BE REMOVED

- EXISTING OVERHEAD ELECTRICAL
- EXISTING ELECTRICAL - UNDERGROUND
- EXISTING ELECTRICAL POLE
- EXISTING STREET LIGHT
- EXISTING COMMUNICATIONS (TELEPHONE LINE)
- EXISTING COMMUNICATIONS (OPTIC FIBRE)

TRAFFIC CONTROL SIGNAL

- TCS POST
- TCS CONTROLLER
- TCS PIT
- TCS LOOPDETECTOR
- MAST ARM
- TCS CABLE

RMD XX ... UTILITY ASSET TAG - REFER TO UTILITY MANAGEMENT PLAN FOR TAG DESCRIPTIONS

NOTES

1. FOR GENERAL NOTES REFER SHEET GE-0031 TO GE-0032.
2. UTILITY LOCATION TO BE CONFIRMED BY FIELD POTHOLING PRIOR TO CONSTRUCTION.
3. (QL(x)) x DENOTES CLASSIFICATION OF SUB-SURFACE UTILITY INFORMATION STANDARDS AS 5488 QUALITY LEVEL.

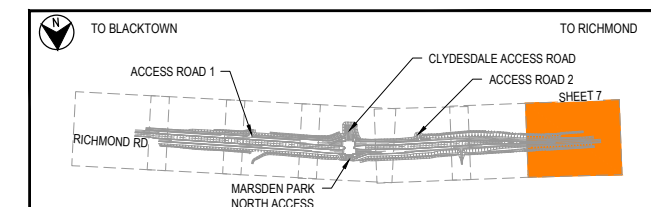

KEY PLAN
NTS

NOT FOR CONSTRUCTION

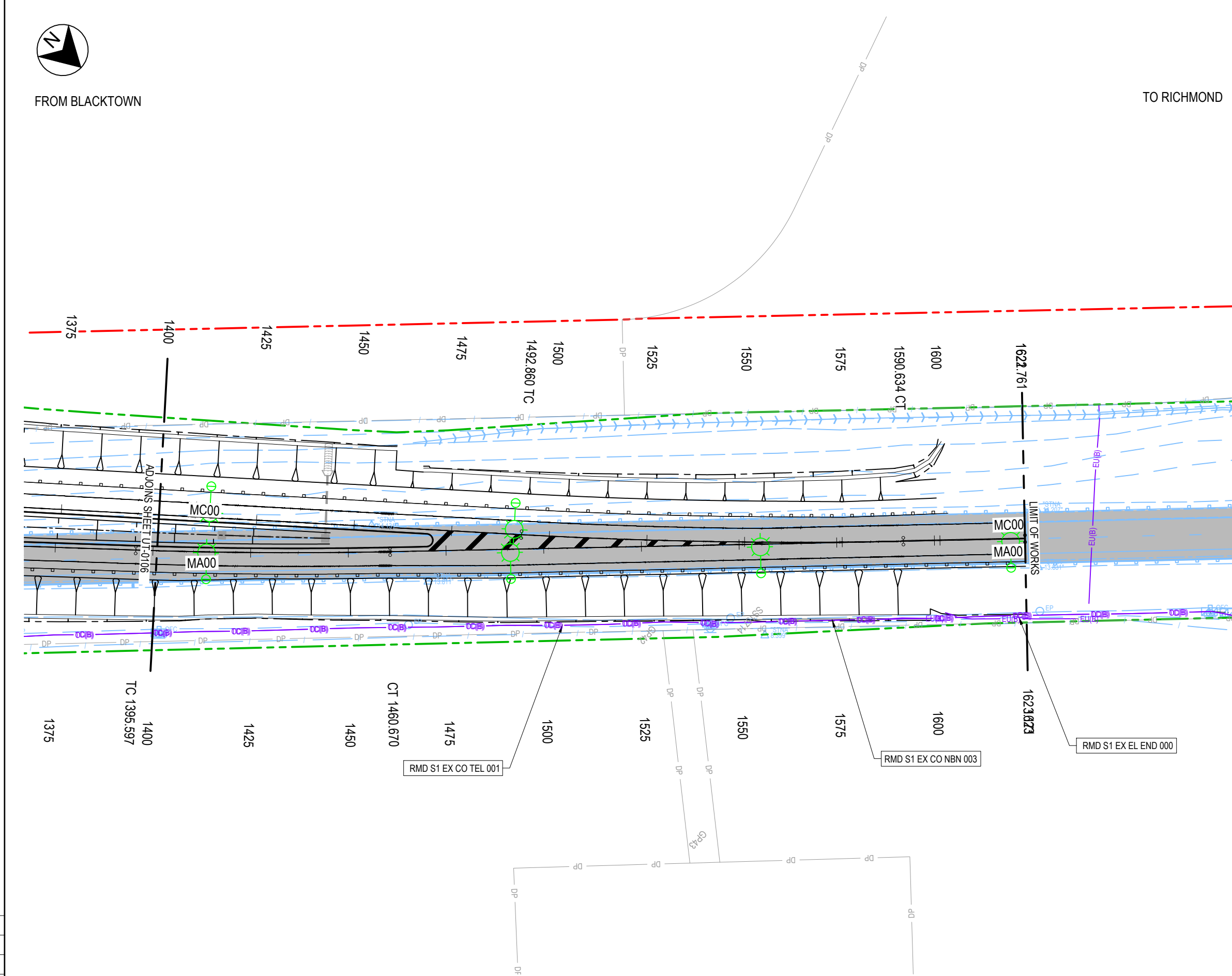

THIS DRAWING MAY BE PREPARED IN COLOUR AND MAY BE INCOMPLETE IF COPIED FROM AN A3 SIZE ORIGINAL

DRAWING FILE LOCATION \ NAME C:\users\bojiss\appdata\local\projectwise\jacobs_anz_ie\0362266\RRU-IA301400-DG-UT-0101-0107.dwg		PLOT DATE \ TIME 6/17/2020 4:55:11 PM		PLOT BY Bojiss		PROJECT BREAKDOWN STRUCTURE		JACOBS DOCUMENT NUMBER RRU-IA301400-DG-UT-0107		PLOT DATE / TIME 17/06/2020		PLOT BY Bojiss		CLIENT 		BLACKTOWN CITY COUNCIL MR537 - RICHMOND ROAD ELARA BOULEVARD TO ACCESS ROAD 2, MARSDEN PARK UTILITY COORDINATION PLAN		SHEET 7 OF 7			
DESIGN MODEL FILE(S) USED FOR DOCUMENTATION OF THIS DRAWING 12D_RRU_IA301400-DM-UT-0001_EXISTING.12da 12D_RRU_IA301400-DM-UT-0002_PROPOSED.12da		REV 0		DATE 18.06.2020		AMENDMENT / REVISION DESCRIPTION ISSUED FOR DESIGN FOR REF		APPROVAL K.LAU		SCALES ON A3 SIZE DRAWING		DRAWINGS / DESIGN PREPARED BY 		TITLE DRAWN I.JIMEDI 18.06.2020 DRG CHECK S.GALLOWAY 18.06.2020 DESIGN L.AGUNG 18.06.2020 DESIGN CHECK S.RUSCHINSKY 18.06.2020 DESIGN MNGR M.O'ROURKE 18.06.2020 PROJECT MNGR K.LAU 18.06.2020		PREPARED FOR REGIONAL PROJECT OFFICE ROADS AND MARITIME SERVICES		RMS REGISTRATION No. DS2020/000286		PART UT	
SCALE 1:1000 		CO-ORDINATE SYSTEM MGA ZONE 56		HEIGHT DATUM AHD		Tel: +61 2 9928 2100 Fax: +61 2 9928 2500 Web: www.jacobs.com		EDMS No.		SHEET No. UT-0107		REV 0		© Transport for NSW							