

SCALE 1: 1500 AT A1

SCALE 1: 3000 AT A3

Sportsmans Creek new bridge

July 2013



FOR INFORMATION

Aerial Image Supplied By RMS

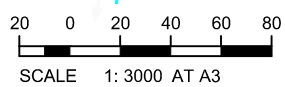
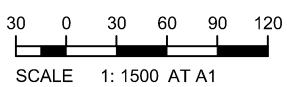

Sportsmans Creek new bridge
July 2013



FOR INFORMATION

Aerial Image Supplied By RMS

30 0 30 60 90 120
SCALE 1: 1500 AT A1

20 0 20 40 60 80
SCALE 1: 3000 AT A3

Sportsmans Creek new bridge
July 2013





FOR INFORMATION

Aerial Image Supplied By RMS

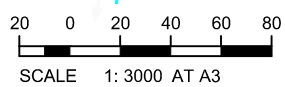
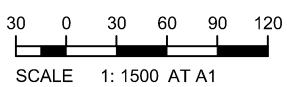

Sportsmans Creek new bridge
July 2013





FOR INFORMATION

Aerial Image Supplied By RMS

30 0 30 60 90 120
SCALE 1: 1500 AT A1

20 0 20 40 60 80
SCALE 1: 3000 AT A3

Sportsmans Creek new bridge
July 2013



FOR INFORMATION

Aerial Image Supplied By RMS

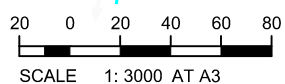
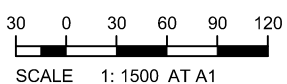

Sportsmans Creek new bridge
July 2013





FOR INFORMATION

Aerial Image Supplied By RMS

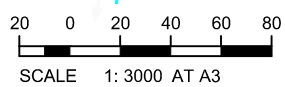
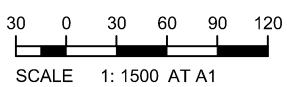

Sportsmans Creek new bridge
July 2013



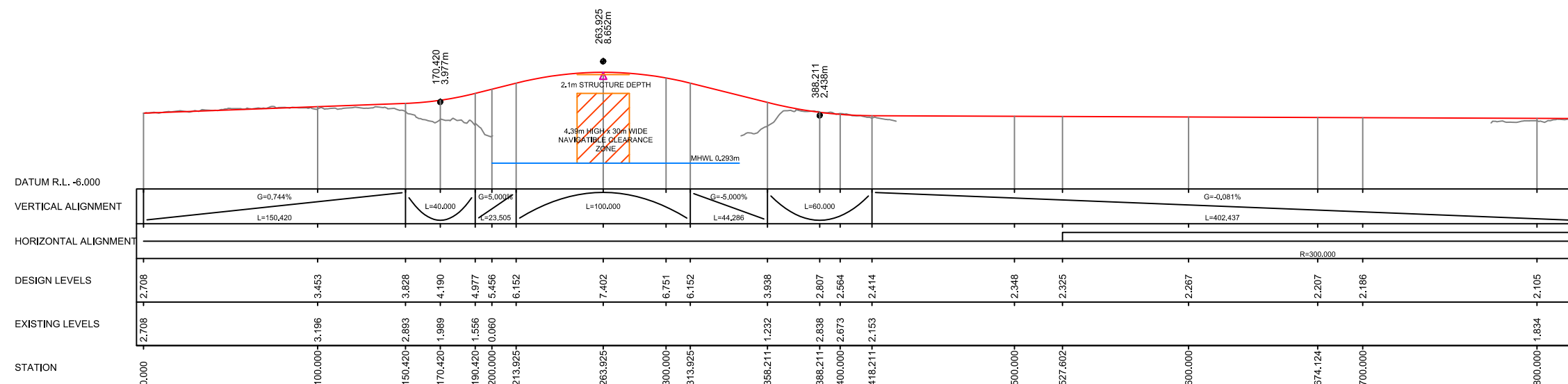

LONGITUDINAL SECTION ALONG OPTION 1
SCALE 1:3000 HORIZ. 1:600 VERT.

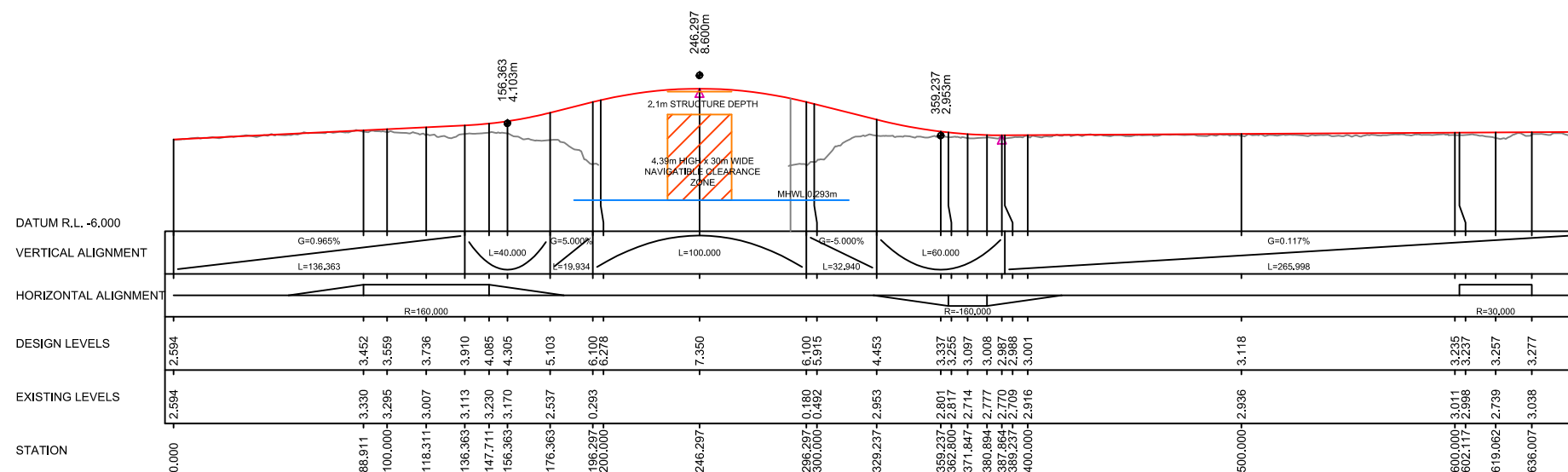

LONGITUDINAL SECTION ALONG OPTION 2
SCALE 1:3000 HORIZ. 1:600 VERT.

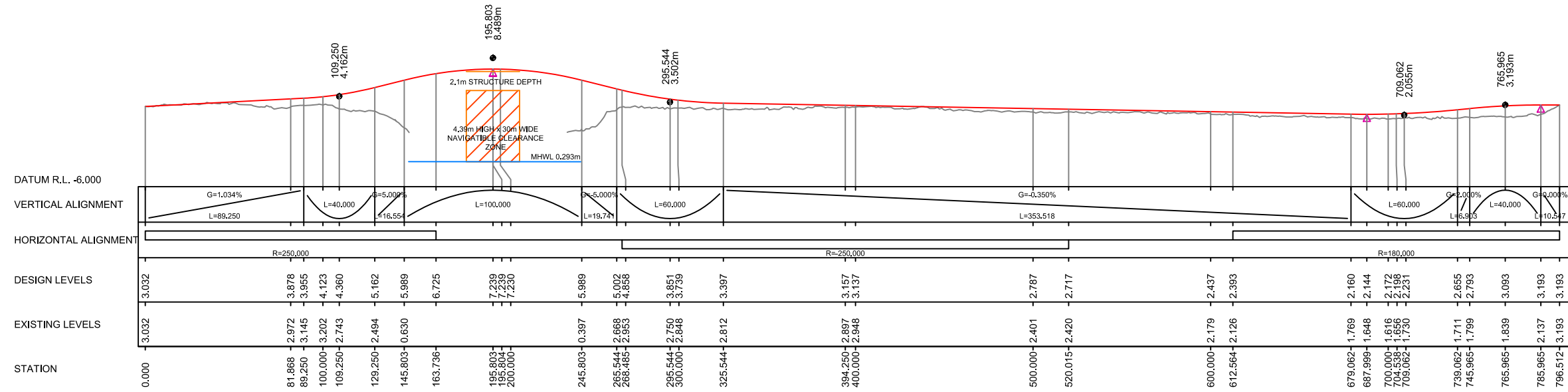

LONGITUDINAL SECTION ALONG OPTION 3

SCALE 1:3000 HORIZ. 1:600 VERT.

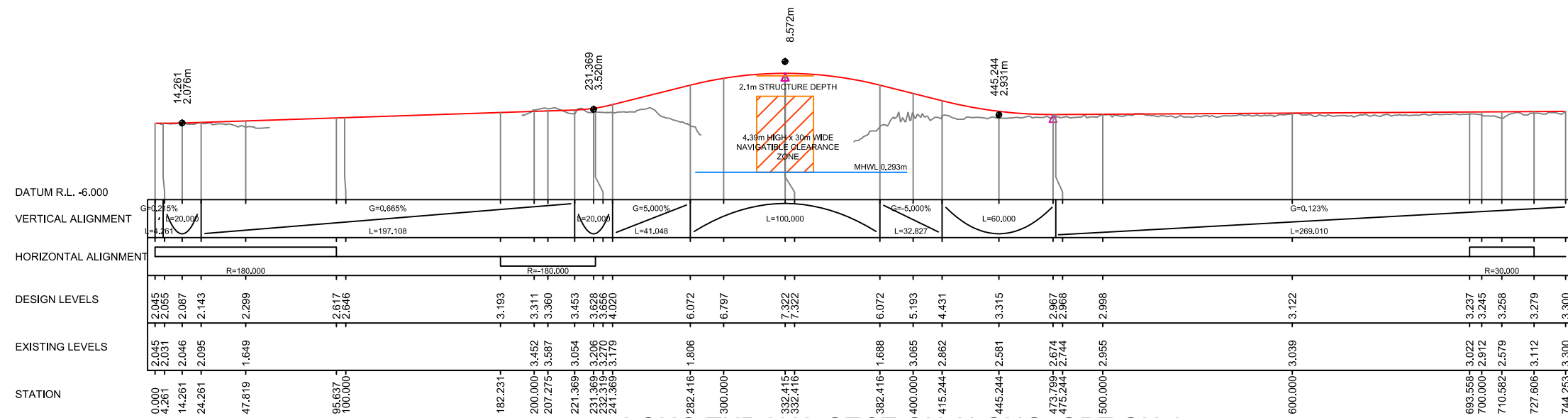

LONGITUDINAL SECTION ALONG OPTION 4

SCALE 1:3000 HORIZ. 1:600 VERT.

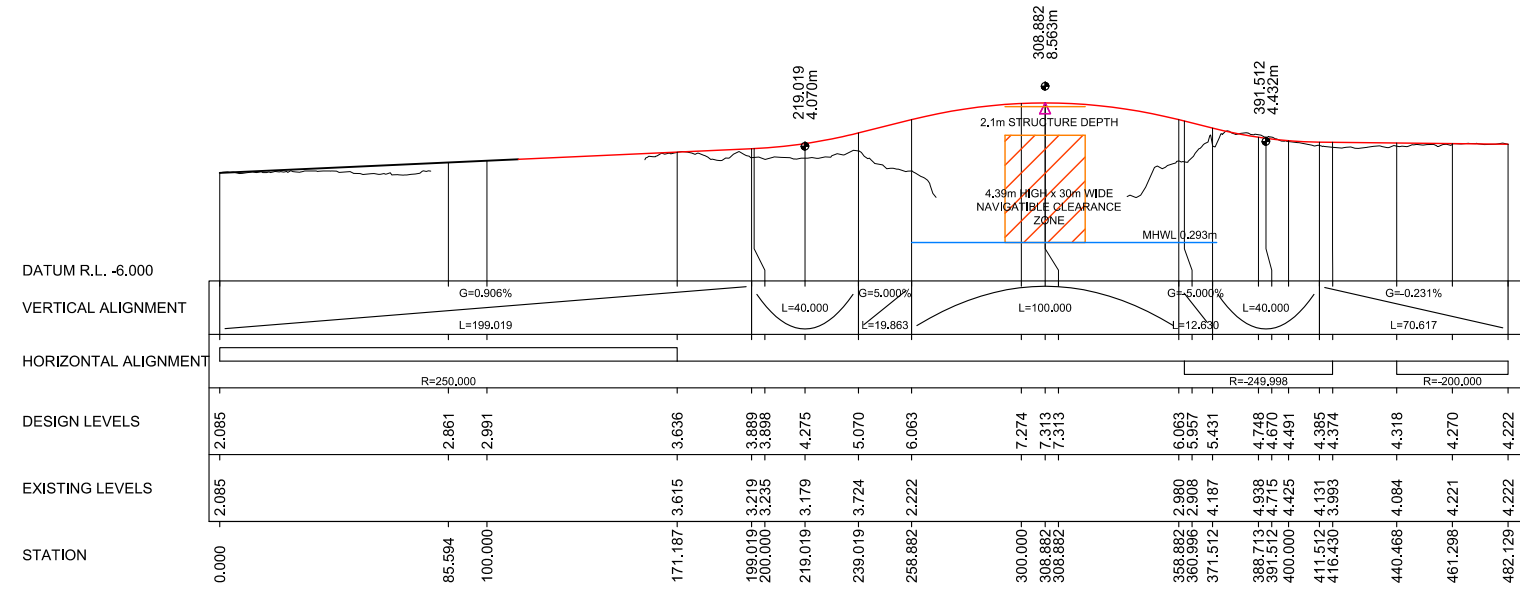

LONGITUDINAL SECTION ALONG OPTION 5

SCALE 1:3000 HORIZ. 1:600 VERT.

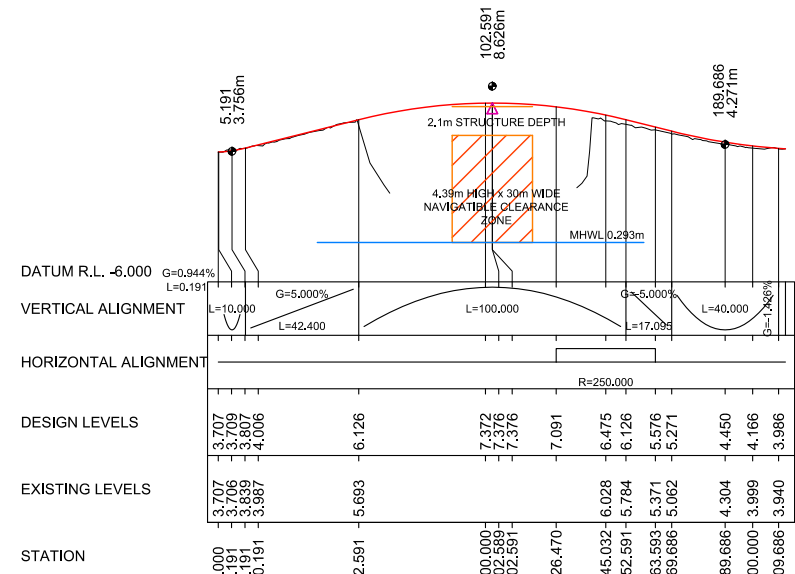

LONGITUDINAL SECTION ALONG OPTION 6

SCALE 1:3000 HORIZ. 1:600 VERT.



THE CADASTRAL BOUNDARY INFORMATION SHOWN ON THIS DRAWING HAS BEEN MANUALLY LOCATED AND IS FOR INFORMATION ONLY.

FOR INFORMATION

Aerial Image Supplied By RMS

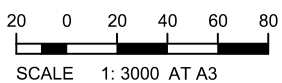

Sportsmans Creek new bridge

October 2013





INSET 2
OPTION A NORTH

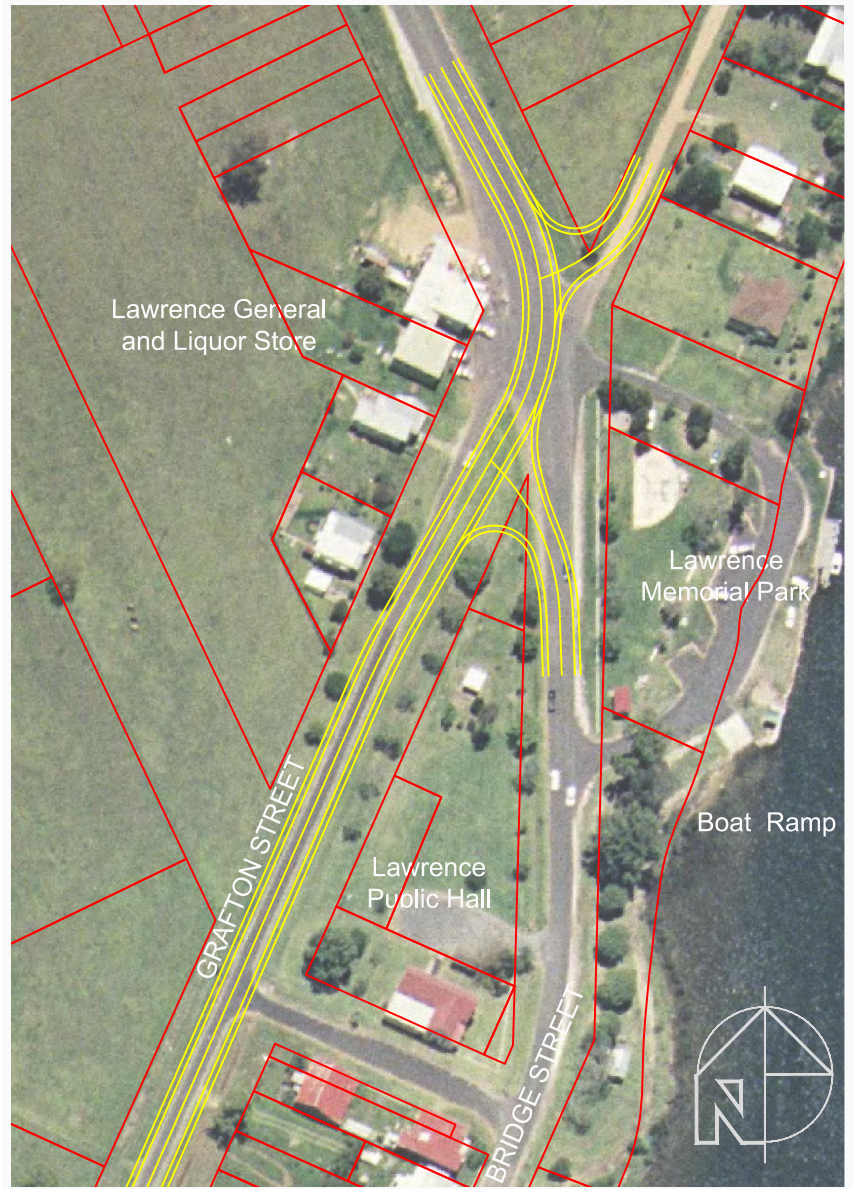

INSET 2
OPTION B NORTH

THE CADASTRAL BOUNDARY INFORMATION SHOWN ON THIS DRAWING HAS BEEN MANUALLY LOCATED AND IS FOR INFORMATION ONLY.



INSET 1



INSET 3

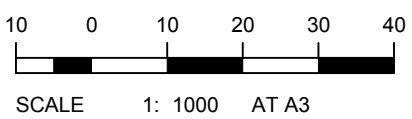

Sportsmans Creek new bridge

October 2013

FOR INFORMATION

Aerial Image Supplied By RMS

