



Australian Government

BUILDING OUR FUTURE



Transport for NSW

Nowra Bridge project

Project update



Artists impression of the new Nowra Bridge



Site establishment

The Nowra Bridge project office has now been established and is located on the corner of Moss Street and the Princes Highway, Nowra. The project office will include project staff and a community display centre.

The main construction compound will be established in June on Scenic Drive where the Riverhaven Motel used to be. The cul-de-sac, playground and a section of the southern foreshore footpath near this location are now closed.

Two smaller construction compounds will be established beside Bomaderry Creek, Bomaderry, and near Lyrebird Drive, Nowra. These sites will be used for staff facilities and material storage.



Work hours

Standard work hours will be:

- 7am to 6pm, Monday to Friday
- 8am to 1pm on Saturday.

The community will be notified in advance of any out of hours work that may be required to reduce impact to motorists or to carry out utility relocations.



What we've been doing

Early work started in February 2020. Work has included:

- Investigations to provide information about existing utilities below ground
- Geotechnical investigations on land and by barge across the Shoalhaven River to inform the detailed design
- Demolition of the motel on Scenic Drive to make room for the construction compound
- Demolition of houses along Illaroo Road to make room for the future widened Illaroo Road
- Installing boundary fencing and temporary fencing around work areas.

The detailed design and Urban Design and Landscape Plan will be on display for community comment in the coming weeks.



Bridge construction and other upcoming work

Major construction work will be starting in the coming weeks with activities to prepare for bridge construction.

A temporary rock platform is being built from the southern side of the Shoalhaven River. This will provide a temporary base for the piling works.

Other work in the coming months will include:

- Power, water and telecommunications service relocation work from June. Utility work will continue at various locations during the project
- Removing vegetation south of the Princes Highway intersection at Bolong Road to start earthworks in July
- Removing vegetation at the eastern end of Illaroo Road in July to allow earthworks to start in August
- Work to build the foundations for the new bridge will start later in the year.



Community engagement

We are following social distancing guidelines in our interactions with the community and putting a hold on information sessions and limiting face-to-face meetings.

The community display centre on Moss Street is available for the community to view project information and talk to the project team. The display centre is currently by appointment only due to Covid-19 restrictions.

We are also looking at new online and digital ways to engage with the community.

Contact us:

If you have any questions or would like more on the Nowra Bridge project please contact our project team:



1800 331 713 (Toll Free)



NowraBridgeProject@fultonhogan.com.au



nswroads.work/NowraBridge



Nowra Bridge Project
14 Moss Street, Nowra NSW 2541.



Consultation on detailed design

Detailed design of the project has been progressing along with the Urban Design and Landscape Plan (UDLP). These will be available shortly and we will advise the community when consultation starts.

Location of works

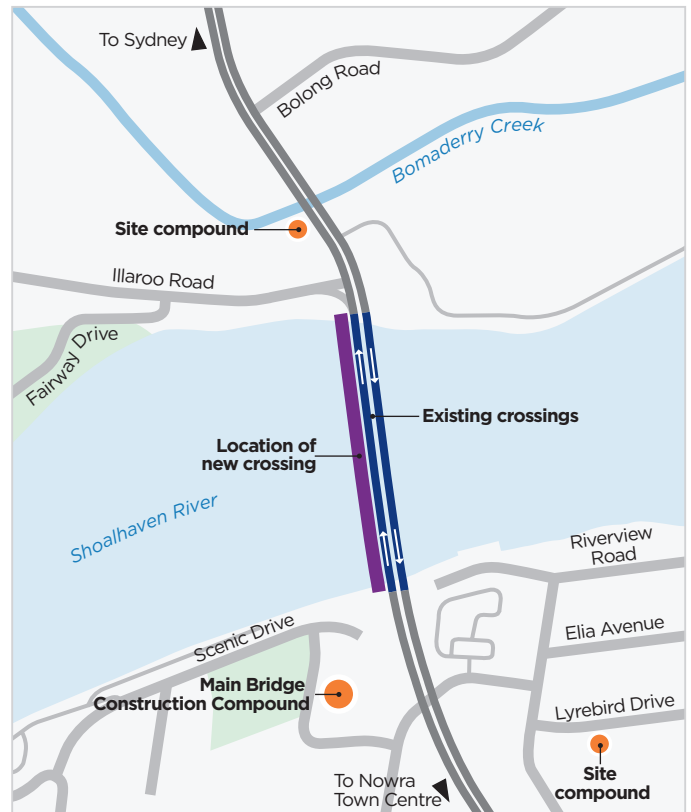

Improved connectivity:
Better pedestrian and cyclist links



Improved intersections:
Safer and more reliable access to local roads



Reduce traffic delays:
More lanes to improve traffic flow



Increase freight access:
Removing overheight and overmass restrictions



This document contains important information about Transport projects in your area. If you require the services of an interpreter, please contact the Translating and Interpreting Service on 131 450 and ask them to call Transport Projects on 1800 331 713. The interpreter will then assist you with translation.