

Traffic improvements on Old Northern Road, Castle Hill to Baulkham Hills

The NSW Government is funding this project as part of its \$121 million Clearways Program, which aims to reduce congestion and delays on Sydney's roads.

Roads and Maritime Services is extending bus lane hours and installing new and extended clearways on Old Northern Road which will be operational from **Monday 24 June 2019**.

In September 2018 Roads and Maritime asked for feedback on the alternative business parking arrangements for clearways on Old Northern Road. We have summarised all feedback and responses in an engagement report which we encourage you to view at rms.nsw.gov.au/clearways.

Following feedback from the community, Roads and Maritime is extending the clearway between Showground Road, Castle Hill and Windsor Road, Baulkham Hills. The new clearway hours are shown on the map.

Additionally, the 6am to 10am southbound bus lane on Old Northern Road between Raemot Lane and Windsor Road will be extended to operate 24 hours. This connects with the 24 hour southbound bus lane on Windsor Road, which will increase the capacity for buses to get through this intersection.

To complete this 24 hour bus lane, nine 1P parking spaces that are available after 10am on weekdays will be removed from Old Northern Road. Roads and Maritime has offered funding to The Hills Shire Council to reconfigure the public car parks to provide additional parking spaces for business customers.

Existing parking and bus lane restrictions along Old Northern Road will continue to apply.

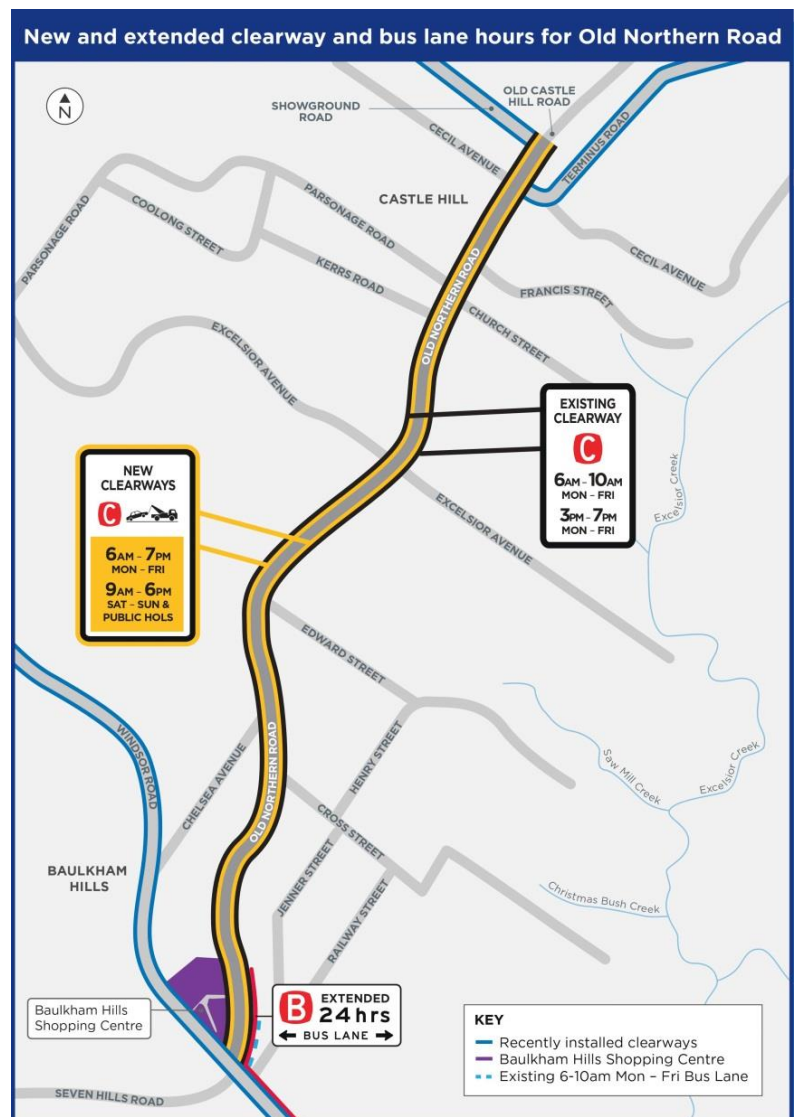

Our work schedule

The new clearways and bus lane signs will be installed between **Sunday 16 June and Sunday 23 June**, weather permitting.

Our working hours will be between **8pm and 5am**. There will be some noise associated with this work but we will do everything we can to minimise the impact, including completing noisier tasks by **11pm**.

Thank you for your patience during this important work.

Contact

If you have any questions about the project, please contact the clearways project team on 1300 706 232 or clearways@rms.nsw.gov.au

If you have any questions about the installation works, please contact our delivery partner, Downer EDI on 1300 776 069.

For more information on Roads and Maritime projects, visit rms.nsw.gov.au/clearways

How will this affect you?

The new clearways and bus lane hours will be open to traffic from **Monday 24 June 2019**. Clearways will allow illegally parked and broken down vehicles to be towed to ensure all lanes are available to move people and goods, helping to ease congestion, improve journey time reliability and safety.

Traffic changes

There will be temporary traffic changes while the signs are installed to ensure the work zone is safe. Please keep to speed limits and follow signs and traffic controller directions. For the latest traffic updates, you can call **132 701**, visit livetraffic.com or download the Live Traffic NSW App.

What is a clearway?

A clearway is a section of road where stopping and parking is not allowed during the times shown on the clearway sign. Clearways are put on key state roads where traffic is often heavy and congested. They help keep vehicles moving by making all lanes available to road users.

To report a vehicle parked or stopped in a clearway or if your vehicle has been towed from a clearway, please call the Transport Management Centre on **131 700**.



Translating and Interpreting Service

If you need an interpreter, please call the Translating and Interpreting Service (TIS National) on **131 450** and ask them to telephone Roads and Maritime Services on 1300 706 232.

Arabic

إذا كنتم بحاجة إلى مترجم، الرجاء الاتصال بخدمة الترجمة الخطية والشفهية (TIS National) على الرقم **131 450**. والطلب منهم الاتصال بوكالتكم على الرقم 1300 706 232.

Cantonese

若你需要口譯員，請致電 **131 450** 聯絡翻譯和口譯服務署 (TIS National)，要求他們致電 1300 706 232 聯絡 Roads and Maritime Services。

Mandarin

如果你需要口译员，请致电 **131 450** 联系翻译和口译服务署 (TIS National)，要求他们致电 1300 706 232 联系 Roads and Maritime Services。

Greek

Αν χρειάζεστε διερμηνέα, παρακαλείστε να τηλεφωνήσετε στην Υπηρεσία Μετάφρασης και Διερμηνείας (Εθνική Υπηρεσία TIS) στο **131 450** και ζητήστε να τηλεφωνήσουν Roads and Maritime Services στο 1300 706 232.

Italian

Se desiderate l'assistenza di un interprete, prego telefonare al Servizio Interpreti e Traduttori (TIS National) al **131 450** chiedendo di contattare Roads and Maritime Services al 1300 706 232.

Korean

통역사가 필요하시면 번역통역서비스 (TIS National)에 **131 450**으로 연락하여 이들에게 1300 706 232 번으로 Roads and Maritime Services 에 전화하도록 요청하십시오.

Vietnamese

Nếu cần thông ngôn viên, xin quý vị gọi cho Dịch Vụ Thông Phiên Dịch (TIS Toàn Quốc) qua số **131 450** và nhờ họ gọi cho Roads and Maritime Services qua số 1300 706 232.