



Australian Government

BUILDING OUR FUTURE



March 2016

Night work and cyclist detour on The Northern Road Upgrade Stage 1, from The Old Northern Road, Narellan to Peter Brock Drive, Oran Park from Tuesday 29 March

The Australian and NSW governments are jointly funding this work as part of the \$1.6 billion The Northern Road Upgrade between Narellan and Penrith.

The Northern Road Upgrade Stage 1 is from The Old Northern Road, Narellan to Peter Brock Drive, Oran Park. Roads and Maritime Services will upgrade Stage 1 to increase capacity for future growth and improve safety and travel times.

Night work will be carried out from **Tuesday 29 March** to **Thursday 12 May 2016**, excluding **weekends** and **public holidays**, weather permitting. Our working hours will be from **6pm** to **7am**.

Night work locations	Activities	No. of shifts
The Northern Road and Fairwater Drive/ Porrende Street intersection	Removing the existing roundabout, installing temporary pavement and relocating utilities	12 nights
The Northern Road and Hillside Drive intersection		12 nights
The Northern Road near The Old Northern Road	Excavating and installing temporary pavement	10 nights
The Northern Road from The Old Northern Road to Peter Brock Drive	Installing signage, concrete barriers and line marking	10 nights

How will the work affect you?

There will be some noise associated with this work. We will make every effort to minimise noise by arranging the work in stages at different locations.

Traffic changes

There will be some temporary traffic changes to ensure the work zone is safe including reducing the speed to 60km/h. A cyclist detour will be in place for around 24 months to ensure the safety of cyclists. For the latest traffic updates, you can call 132 701, visit livetraffic.com or download the Live Traffic NSW App.

Contact

If you have any questions, please call our delivery partner, Georgiou Group on **1300 059 677** or email TNRStage1@georgiou.com.au. For more information on our projects, visit www.rms.nsw.gov.au.

Thank you for your patience during this important work.

The Northern Road Upgrade Stage 1 - Cyclist detour route

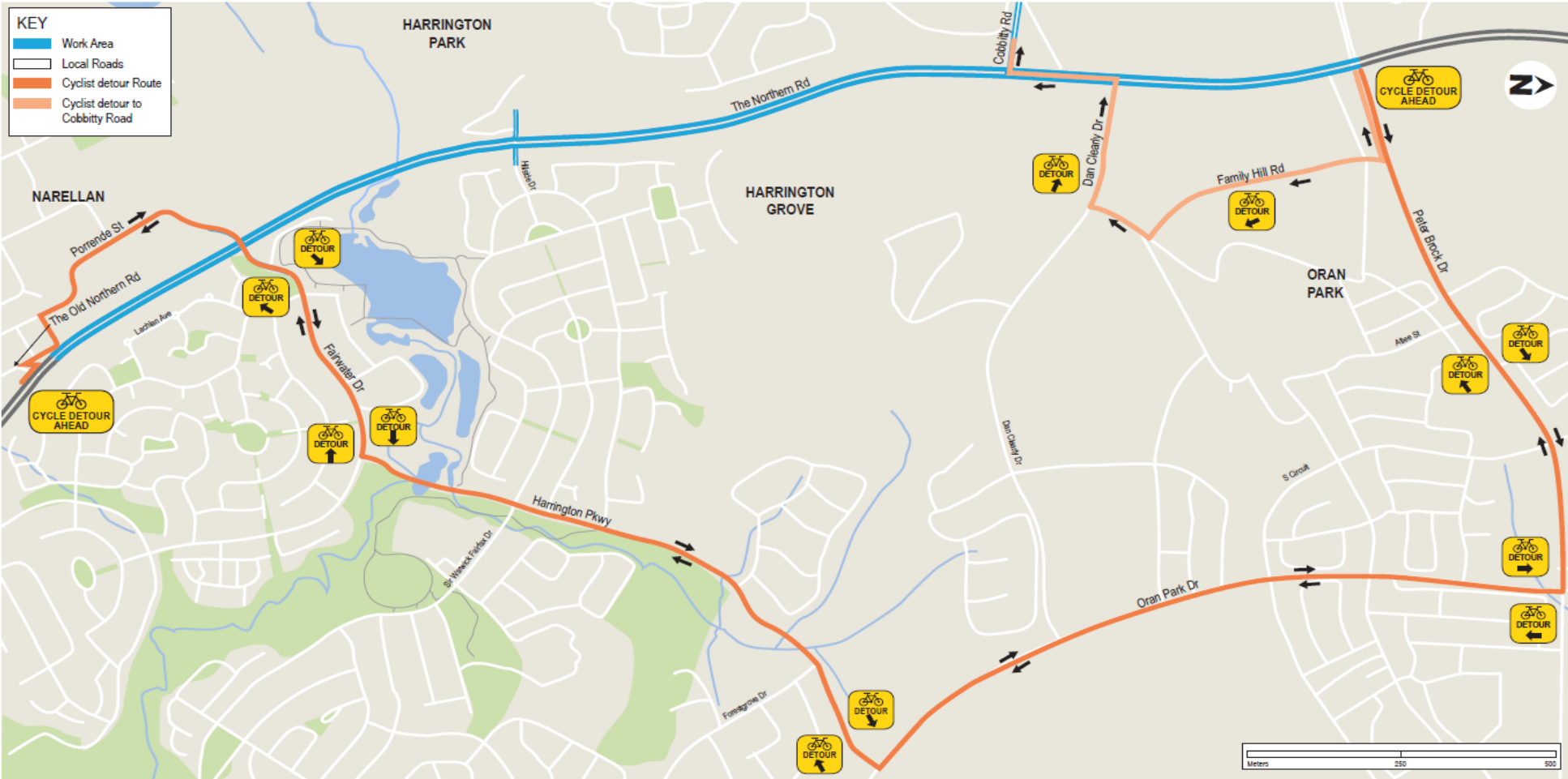

Translating and Interpreting Service



If you need an interpreter, please call the Translating and Interpreting Service (TIS National) on 131 450 and ask them to telephone Georgiou on 1300 059 677