



Australian Government

BUILDING OUR FUTURE



March 2017

Night work to prepare for traffic switch onto new lanes for The Northern Road Upgrade, Harrington Park from Thursday, 20 April

The Australian and NSW governments are jointly funding this work as part of the \$1.6 billion The Northern Road Upgrade between Narellan and Penrith.

Roads and Maritime Services is upgrading The Northern Road between The Old Northern Road, Narellan, and Peter Brock Drive, Oran Park to increase capacity for future growth and improve safety and travel times.

Due to wet weather, work to move traffic onto the first section of the newly built northbound carriageway between The Old Northern Road and Cobbitty Road will now be on **Thursday, 20 April 2017 at 5am**, weather permitting.

In preparation to open the new northbound carriageway, night work will take place on Porrende Street on **Tuesday, 28 March 2017** and Dan Cleary Drive on **Tuesday, 18 April 2017** between **6pm and 7am**, weather permitting.

Dan Cleary Drive will remain permanently restricted to left-in / left-out only, which will remain in place after The Northern Road Upgrade project is completed. Right turn movements to and from The Northern Road can be made at Peter Brock Drive.

We have included a map to show the location of this work.

How will the work affect you?

There may be some noise associated with this work. We will make every effort to minimise impacts on residents.

Traffic changes

Temporary traffic changes will be in place to ensure the work zone is safe for workers and motorists. Electronic message signs will be in place to direct road users around the changes.

Please keep to the displayed speed limits and follow the direction of traffic controllers and signs. For the latest traffic updates please call 132 701, visit livetraffic.com or download the Live Traffic NSW App.

Contact

If you have any questions, please contact our delivery partner, Georgiou Group on **1300 059 677** or TNRStage1@georgiou.com.au. For more information on our projects, visit www.rms.nsw.gov.au.

Thank you for your patience during this important work.

Location Map - changed traffic conditions on The Northern Road

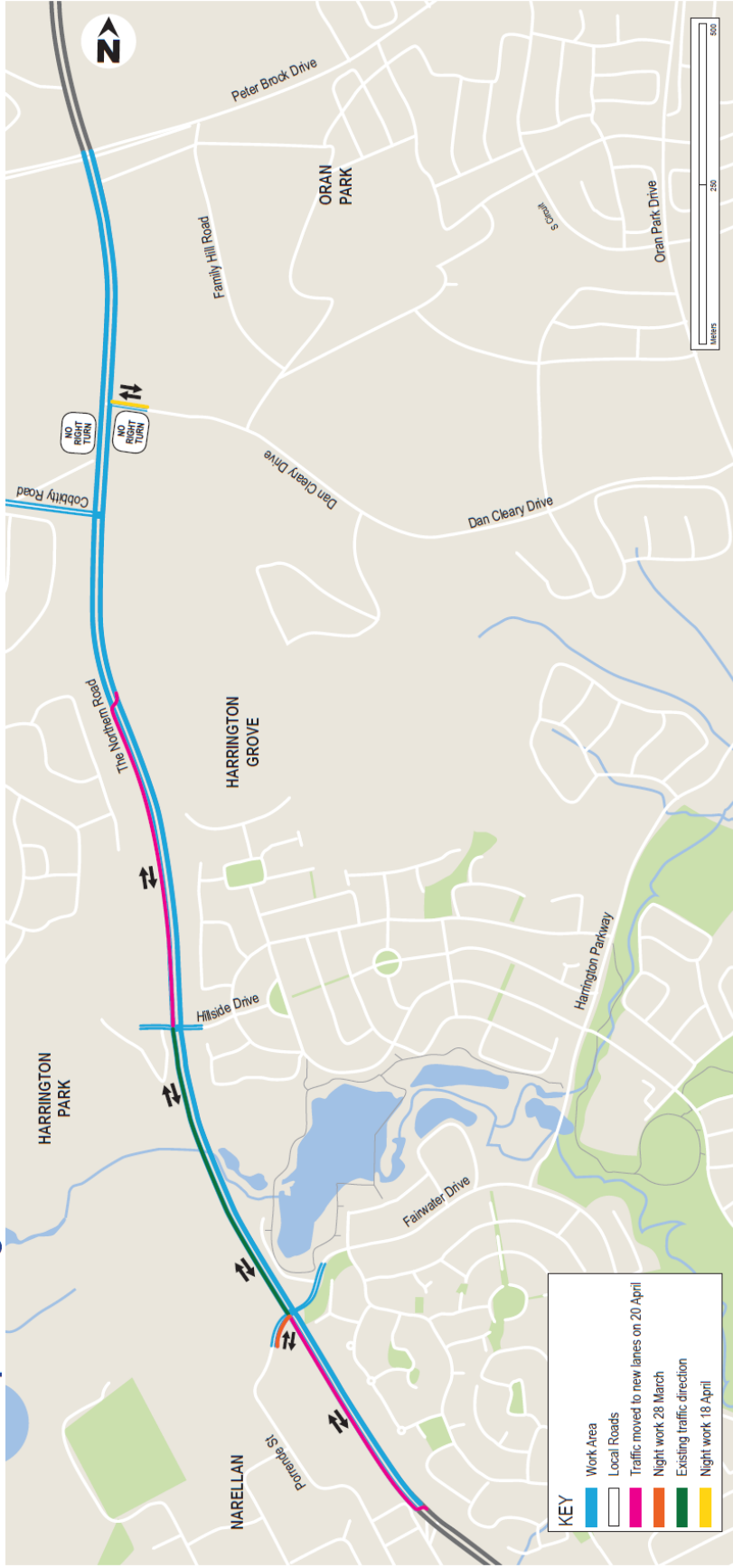

Translating and Interpreting Service

If you need an interpreter, please call the Translating and Interpreting Service (TIS National) on 131 450 and ask them to telephone Georgiou on 1300 059 677

