



Australian Government

**BUILDING OUR FUTURE**



July 2016

## Night work on The Northern Road Upgrade, The Old Northern Road, Narellan to Peter Brock Drive, Oran Park from Monday 1 August

**The Australian and NSW governments are jointly funding this work as part of the \$1.6 billion The Northern Road Upgrade between Narellan and Penrith.**

Roads and Maritime Services is upgrading The Northern Road between The Old Northern Road, Narellan and Peter Brock Drive, Oran Park to increase capacity for future growth and improve safety and travel times

Due to wet weather, night work to relocate services will take about four more weeks to complete from **Monday 1 August to Friday 26 August 2016**, weather permitting. Our work hours will be from **7pm to 6am**. No night work will be carried out on weekends. We have included a map to show the location of this work.

Work will also continue during standard construction hours from **7am to 6pm Mondays to Fridays** and from **8am to 1pm on Saturdays**. No work will be carried out on public holidays.

Night work locations	Number of shifts	Activities
The Northern Road, Fairwater Drive and Porrende Street intersection	8 nights	Installation and relocation of water services.
The Northern Road and Hillside Drive intersection	8 nights	
The Northern Road and Cobbitty Road intersection	8 nights	
The Northern Road and Dan Cleary Drive intersection	8 nights	

### How will the work affect you?

There will be some noise associated with this work. We will make every effort to minimise noise by arranging the work in stages at different locations.

### Traffic changes

There may be some temporary traffic changes to ensure the work zone is safe for workers and motorists. Please keep to the displayed speed limits and follow the direction of traffic controllers and signs. For the latest traffic updates, you can call 132 701, visit [livetraffic.com](http://livetraffic.com) or download the Live Traffic NSW App.

### Contact

If you have any questions, please call our delivery partner, Georgiou Group on **1300 059 677** or email [TNRStage1@georgiou.com.au](mailto:TNRStage1@georgiou.com.au). For more information on our projects, visit [www.rms.nsw.gov.au](http://www.rms.nsw.gov.au).



Thank you for your patience during this important work.

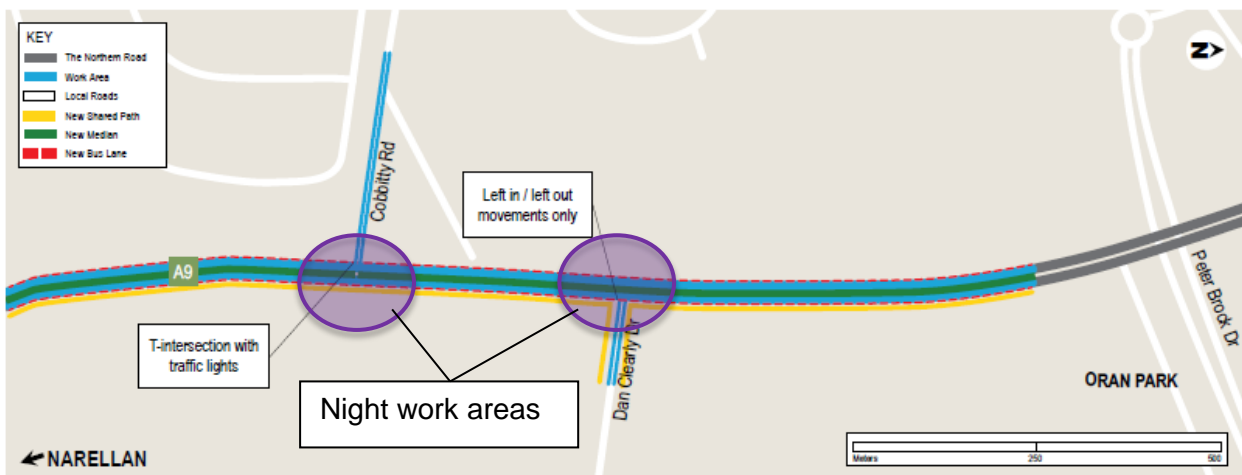
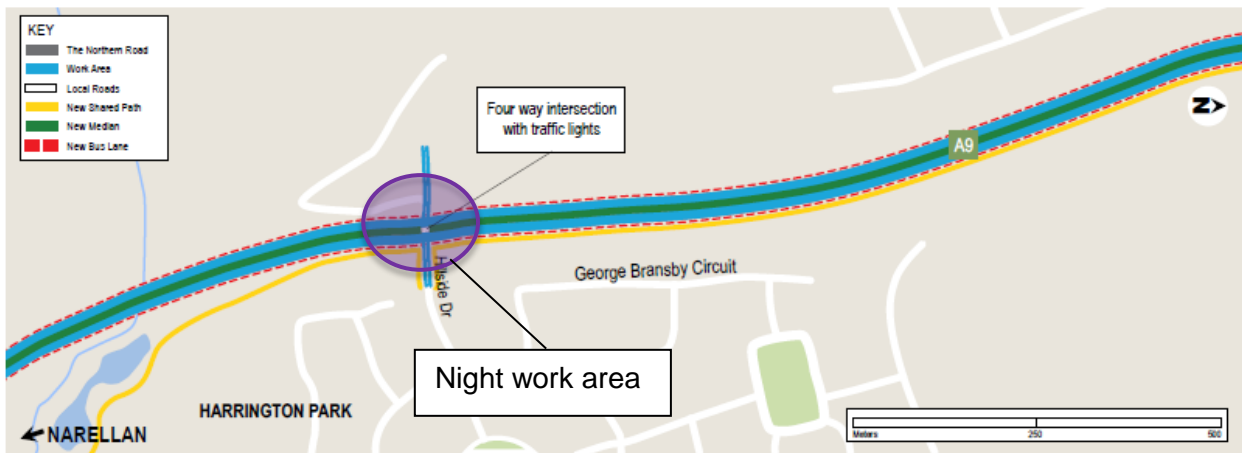
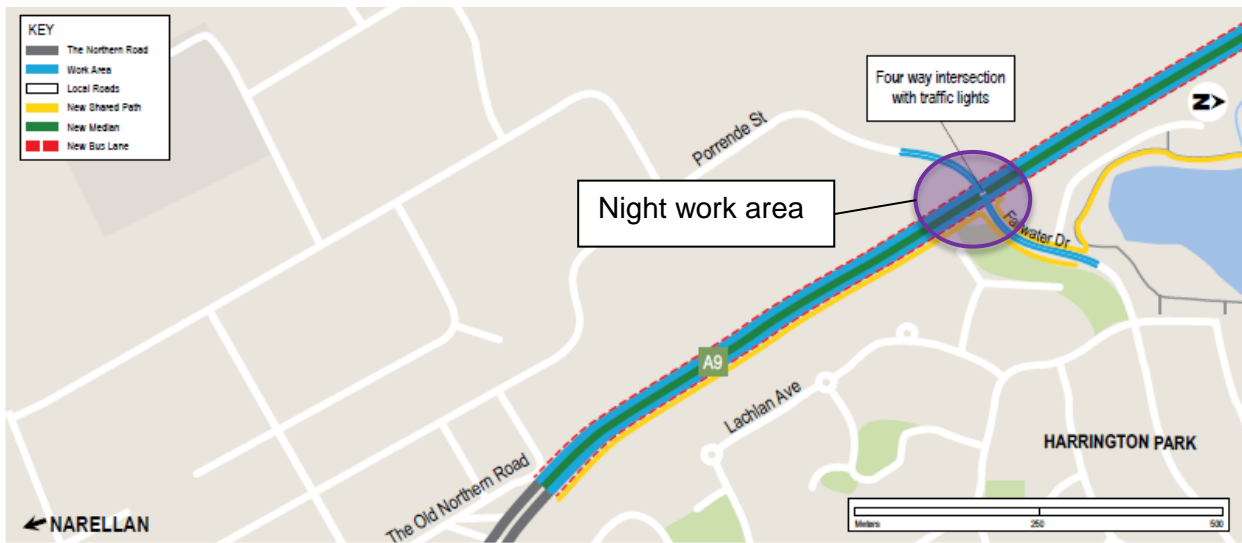

### Translating and Interpreting Service

If you need an interpreter, please call the Translating and Interpreting Service (TIS National) on 131 450 and ask them to telephone Georgiou on 1300 059 677

