



Australian Government

BUILDING OUR FUTURE



June 2017

Night work to prepare for a traffic switch on The Northern Road, Harrington Park from Thursday, 29 June 2017

The Australian and NSW governments are jointly funding this work as part of the \$1.6 billion The Northern Road Upgrade between Narellan and South Penrith.

Roads and Maritime Services is upgrading The Northern Road between The Old Northern Road, Narellan, and Peter Brock Drive, Oran Park to increase capacity for future growth and improve safety and travel times.

As part of this work, traffic will be moved onto a section of newly built southbound lanes between Hillside Drive and Peter Brock Drive, Harrington Park.

To minimise impact on motorists, preparation work for this traffic switch will take place at night between **6pm** and **7am** on **Thursday, 29 June 2017**, weather permitting. From **5am Friday, 30 June 2017** traffic will travel on the new lanes, weather permitting.

The attached map shows the location of the night work, traffic switch and detours.

How will the work affect you?

Our work may be noisy but every effort will be made to minimise impacts on residents.

Traffic changes

In preparation for the traffic switch, Cobbitty Road will be temporarily closed between **8pm on Thursday, 29 June 2017** and **5am on Friday 30 June 2017** from The Northern Road to Governor Drive, Harrington Park. A detour will be in place on Governor Drive.

For safety reasons left in access to Dan Cleary Drive from The Northern Road will also be temporarily closed from **6pm on Thursday, 29 June** to **6pm on Friday 14 July 2017**, weather permitting. During this work, traffic will be diverted via Peter Brock Drive. Once the work is complete, Dan Cleary Drive will remain as left in/left out movements only.

Temporary traffic changes will be in place to ensure the work zone is safe for workers and motorists. Electronic message signs will be in place to direct road users around the changes.

Please keep to the displayed speed limits and follow the direction of traffic controllers and signs. For the latest traffic updates please call 132 701, visit livetraffic.com or download the Live Traffic NSW App.

Contact

If you have any questions, please contact our delivery partner, Georgiou Group on **1300 059 677** or TNRStage1@georgiou.com.au. For more information on our projects, visit www.rms.nsw.gov.au/wsip. Thank you for your patience during this important work.

Location map - changed traffic conditions on The Northern Road

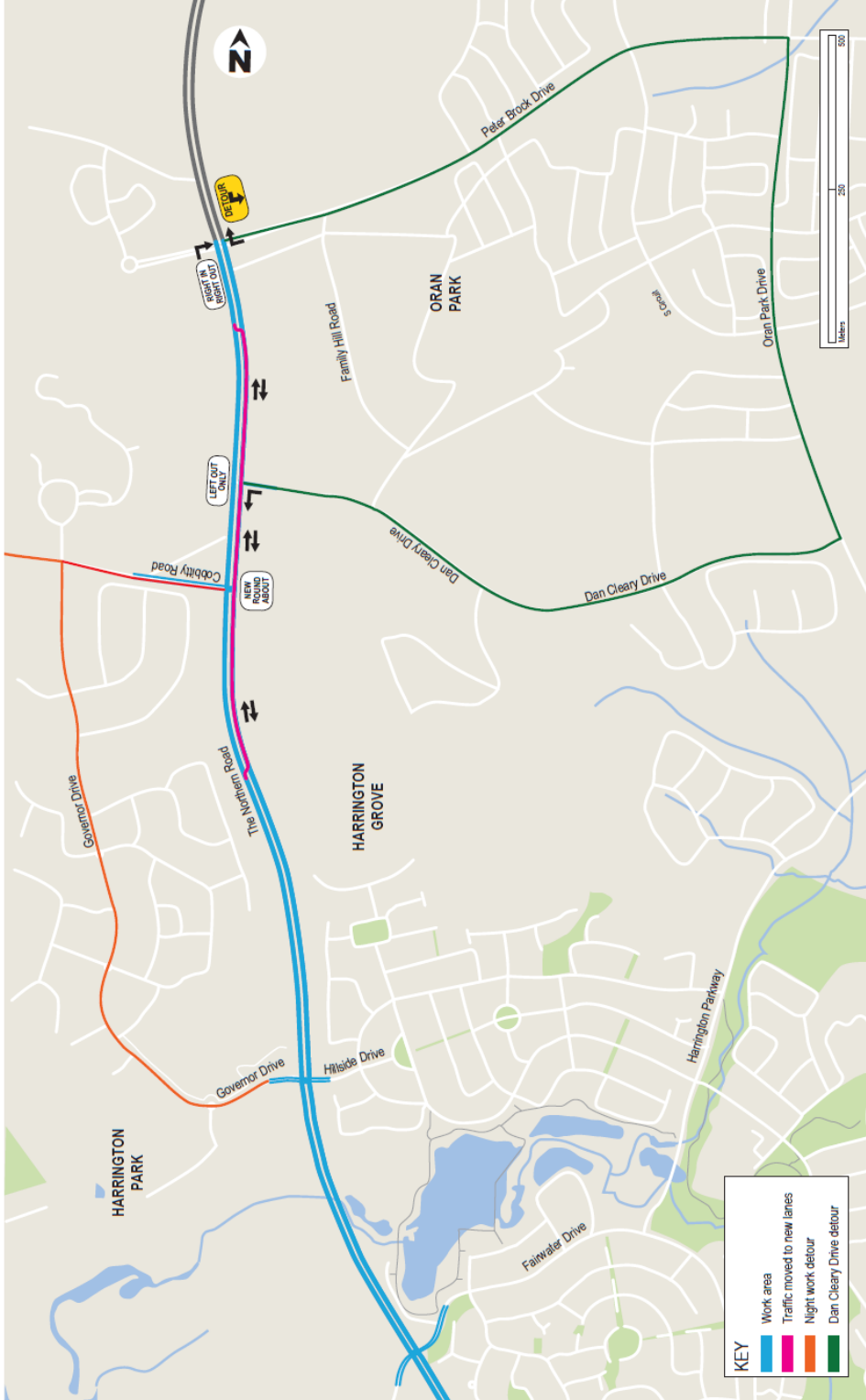

Translating and Interpreting Service

If you need an interpreter, please call the Translating and Interpreting Service (TIS National) on 131 450 and ask them to telephone Georgiou on 1300 059 677

