



Australian Government

BUILDING OUR FUTURE



September 2016

Night work on The Northern Road Upgrade, The Old Northern Road, Narellan to Peter Brock Drive, Oran Park from Monday 19 September

The Australian and NSW governments are jointly funding this work as part of the \$1.6 billion The Northern Road Upgrade between Narellan and Penrith.

Roads and Maritime Services is upgrading The Northern Road between The Old Northern Road, Narellan and Peter Brock Drive, Oran Park to increase capacity for future growth and improve safety and travel times.

Night work to construct temporary pavements and install new services will take six weeks to complete from **Monday 19 September** to **Friday 4 November 2016**, weather permitting. Our work hours will be from **7pm** to **6am**. No night work will be carried out on weekends. We have included a map to show the location of this work.

Work will also continue during standard construction hours from **7am** to **6pm Mondays** to **Fridays** and from **8am** to **1pm** on **Saturdays**. No work will be carried out on public holidays.

Night work locations	Number of shifts	Activities
The Northern Road, 150 metres north of The Old Northern Road Intersection	12 nights	Installing traffic management controls and constructing temporary pavements.
The Northern Road and Peter Brock intersection	12 nights	
The Northern Road and Porrende Street/Fairwater Drive intersection	12 nights	Installing and relocating water services.

How will the work affect you?

There will be some noise associated with this work. We will make every effort to minimise noise by arranging the work in stages at different locations.

Traffic changes

There may be some temporary traffic changes to ensure the work zone is safe for workers and motorists. Please keep to the displayed speed limits and follow the direction of traffic controllers and signs. For the latest traffic updates, you can call 132 701, visit livetraffic.com or download the Live Traffic NSW App.

Contact

If you have any questions, please call our delivery partner, Georgiou Group on **1300 059 677** or email TNRStage1@georgiou.com.au. For more information on our projects, visit www.rms.nsw.gov.au.

Thank you for your patience during this important work.

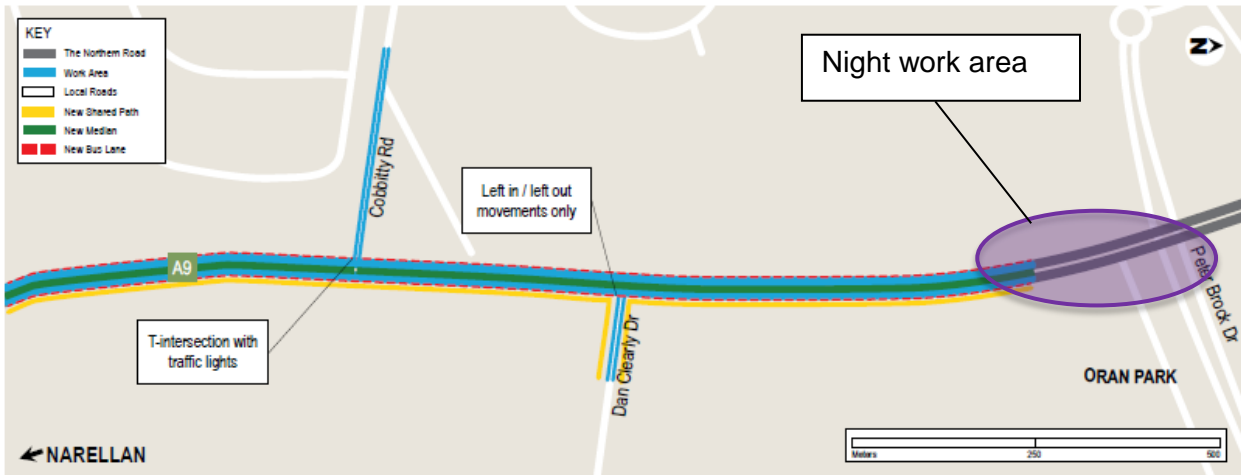
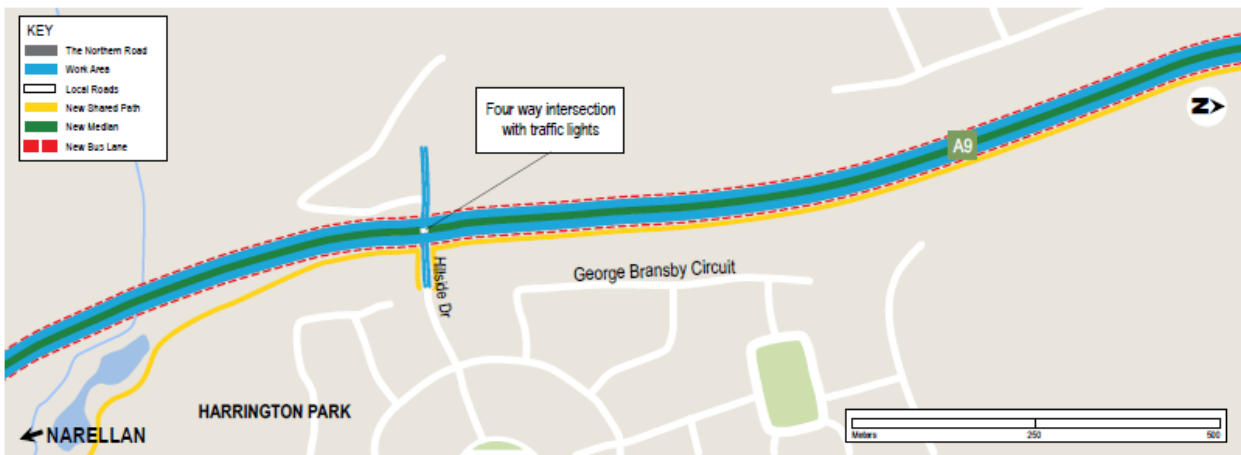
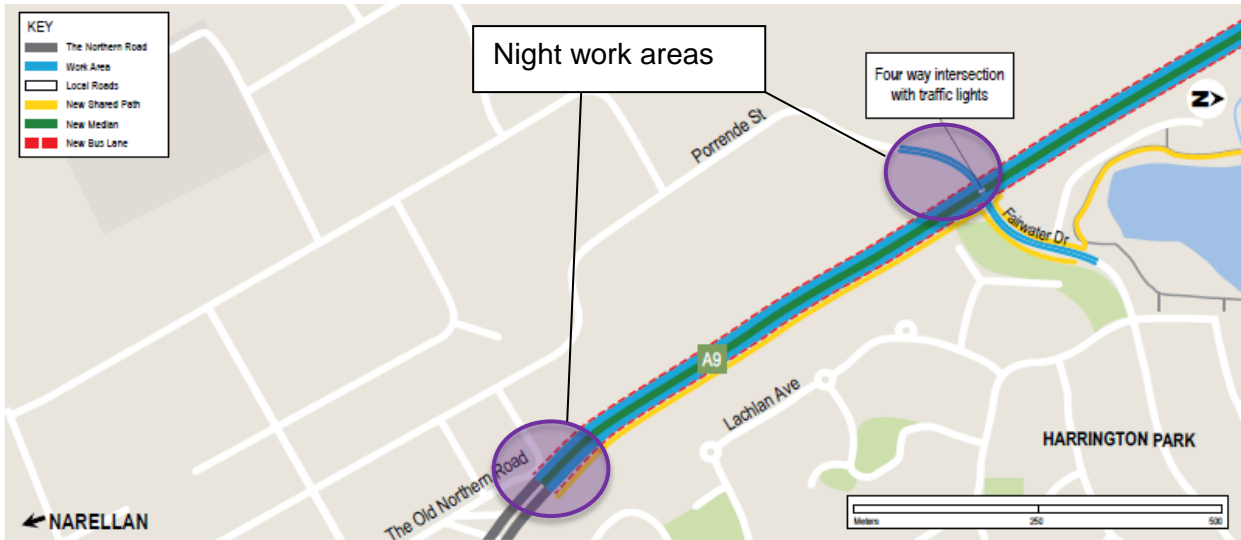

Translating and Interpreting Service

If you need an interpreter, please call the Translating and Interpreting Service (TIS National) on 131 450 and ask them to telephone Georgiou on 1300 059 677

