



Transport Access Program

Ashfield Commuter Car Park

COMMUNITY NOTIFICATION

FEBRUARY 2018

The Ashfield Commuter Car Park is part of the Transport Access Program, a NSW Government initiative to provide a better experience for public transport customers by delivering accessible, modern and integrated transport infrastructure.

Project overview

The Ashfield Commuter Car Park project will provide around 95 additional parking spaces on Brown Street, plus a range of features and facilities to make it safer and more accessible to commuters.

Key benefits of the project include:

- up to 95 extra parking spaces on Brown Street, bringing the total to approximately 235 parking spaces
- lift access for those with accessibility issues, parents with prams and customers carrying luggage
- new lighting and CCTV.

Construction update

The construction of the above-ground structure is progressing well with the upcoming installation of the car park façade and painting and finishing works. You may notice the following activities occurring on site and on Brown Street over February:

- installation of façade
- placement of concrete at the front of the car park
- removal of scaffolding
- painting and other finishes.

Night works – Thursday 15 February 2018

There are planned night works along Brown Street on **Thursday 15 February 2018 from 6pm to 7am the following morning** to allow Sydney Water to complete the final connection into the existing water main as part of the recent works. These works will involve temporary changes to vehicle movements on Brown Street. Modified driving conditions will be in place and traffic control personnel will be on duty to assist with vehicle movements and traffic flow. To facilitate these works, **approximately 7 parking spaces will be unavailable on Brown Street during this period**, as detailed in the diagram below. Signage will be installed to notify users prior to works commencing.

Due to the activities involved with these works, the water main will be temporarily isolated cutting off water to the local area. Impacted residents and businesses will be directly contacted by Sydney Water prior to these works being undertaken.

Equipment to be used includes an excavator, wacker packer, angle grinder and lighting tower as well as hand and power tools. It is not anticipated that significant noise will be generated by these works. Every effort will be made to minimise the impact on surrounding residents and businesses.

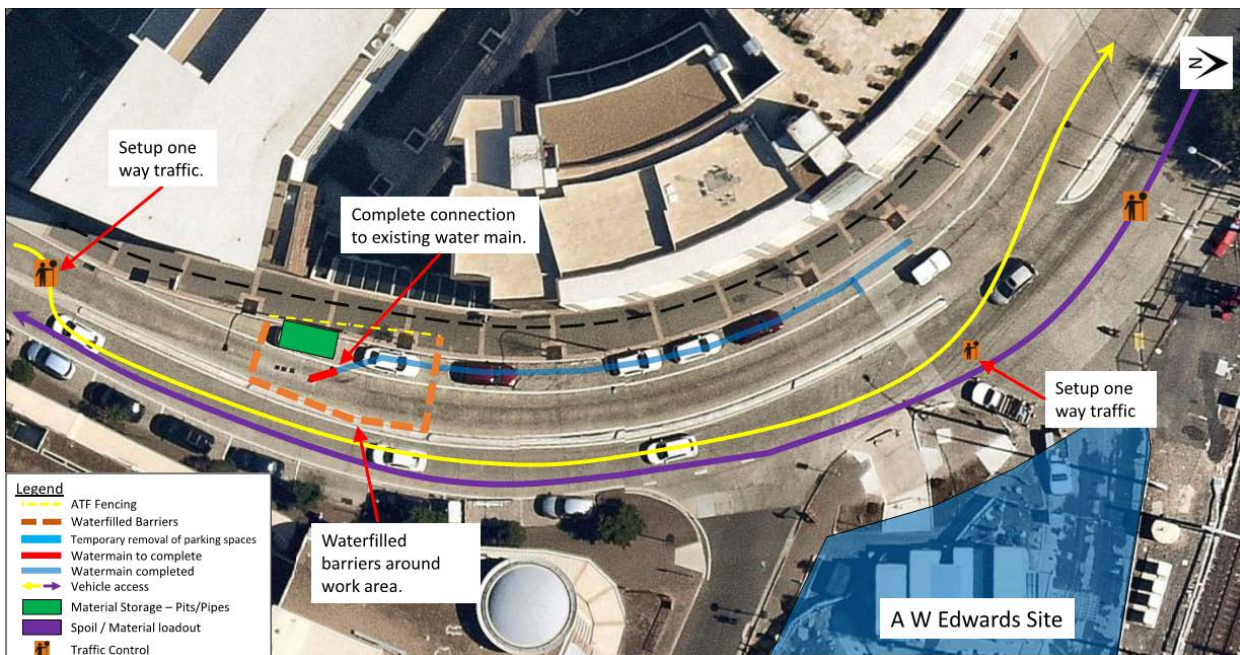

Standard construction hours

Work will continue during standard work hours, which are **Monday to Friday from 7am to 6pm** and **Saturday from 8am to 1pm**.

Continual surveillance of noise generation, dust control and traffic and pedestrian impacts is undertaken in order to improve techniques and minimise the impact on the surrounding community.

We apologise for any inconvenience caused and thank you for your patience and cooperation during these important works.



This document contains important information about public transport projects in your area. If you require the services of an interpreter, please contact the Translating and Interpreting Service on 131 450 and ask them to call Transport for NSW on (02) 9200 0200. The interpreter will then assist you with translation.

Arabic

إذا كنتم بحاجة .تتضمن هذه الوثيقة معلومات عن مشاريع النقل العام في منطقتكم إلى خدمات مترجم، الرجاء الإتصال بخدمة الترجمة الشفهية والخطية على رقم 131 450 عندها يساعدكم المترجم بالترجمة .(02) 9200 0200 واطلبوا منهم ان يتصلوا بقسم مشاريع النقل على رقم .

Croatian

Ovaj dokument sadrži važne informacije o projektima javnog prijevoza u vašem podru ju. Ukoliko su vam potrebne usluge tuma a molimo kontaktirajte Usluge Prevoditelja i Tuma a na 131450 i pitajte ih da nazovu Odjel za Planiranje Prometa - Transport Projects Division na (02) 9200 0200. Tuma ce vam tada pomo l u prevo enju.

Italian

Il presente documento contiene importanti informazioni sulle iniziative nel campo del trasporto pubblico nella vostra zona. Se desiderate i servizi di un interprete, contattate il Servizio traduzioni e interpreti al numero 131 450 indicando di voler parlare con la Transport Projects Division al numero (02) 9200 0200. L'interprete vi aiuterà a condurre la conversazione telefonica.

Chinese

这份文件包含你所在地区公共交通工程项目的重要信息。如果你需要传译服务，请致电翻译与传译服务机构，电话131450，要求他们为你接通交通工程部 (Transport Projects Division)，电话是 (02) 9200 0200。传译员会为你做翻译。

Filipino

Ang dokumentong ito ay naglalaman ng mahalagang impormasyon tungkol sa mga proyektong transportasyon na pampubliko sa inyong lugar. Kung kailangan ninyo ng serbisyo ng tagapagpaliwanag, makipag-ugnayan po sa Serbisyo ng Pagsasalin at Pagpapaliwanag sa 131 450 at hilingan silang tawagan ang Transport Projects Division (Sangay ng mga Proyektong Transportasyon) sa (02) 9200 0200. Tutulungan kayo ng tagapagpaliwanag sa pagsasalin.

Spanish

El presente documento contiene información importante sobre proyectos de transporte público en su área. Si requiere los servicios de un intérprete, llame al Translating and Interpreting Service al 131 450 y pídale que llamen a Transport Projects Division, teléfono: (02) 9200 0200. Luego el intérprete le ayudará con la traducción.