



Power Supply Upgrade Program

Hornsby and Asquith

COMMUNITY NOTIFICATION

OCTOBER 2019

Transport for NSW is upgrading electrical infrastructure as part of the Power Supply Upgrade Program, which is designed to meet expected power requirements for Sydney's future rail network and new fleet of air-conditioned trains.

Upcoming activities

Between 8pm Friday 25 October and 6am Monday 28 October, we will continue work installing power poles and new overhead wires that provide the power supply into the rail corridor between Bridge Road, Hornsby and Jersey Street North, Asquith. **Please note all times and dates are indicative and subject to change.**

Date	Time	Scope
Friday 25 October and Saturday 26 October	Night work 8pm – 8am	Installation of power poles on Bridge Road, Hornsby and Jersey Street North, Asquith. We will also be installing overhead wires between Bridge Road, Hornsby and Asquith Boys High School, Asquith. See following page for more details.
Sunday 27 October	Night work 6pm – 6am	These works will only take place in the event that works scheduled on Friday 25 October and Saturday 26 October are not completed.

Ausgrid work activities

Ausgrid will be temporarily disconnecting power to some properties during the works that take place overnight between:

- 9pm Friday 25 October and 10am Saturday 26 October
- 8.45pm Saturday 26 October and 9am Sunday 27 October

Ausgrid has directly contacted residents and properties likely to experience any power service interruptions during this work. If you experience any unexpected power interruptions please contact Ausgrid:

General enquiries: www.ausgrid.com.au/contactus

Emergencies: 13 13 88

Changes to traffic and access

There will be some traffic and access changes required to support these works. Temporary lane and road closures are essential for the safety of pedestrians and residents while the overhead wires are replaced and poles installed. Traffic control, signage and electronic signboards will also be in place to assist motorists and pedestrians. **Please note all times and dates are subject to change.**

Date/ time	Location	Scope
9pm Friday 25 October to 8am Saturday 26 October	Jersey Street North, Asquith 2 lanes closed	Two traffic lanes will be closed on Jersey Street North between Bridge Road, Hornsby and the intersection of Peats Ferry Road and Pacific Highway, Asquith. Two way traffic will be maintained, one lane in each direction. Traffic delays may be experienced. Traffic control, signage and electronic signboards will also be in place to assist motorists and pedestrians.
9pm Saturday 26 October to 5am Sunday 27 October	Full road closure Jersey Street North, Asquith and Bridge Road, Hornsby (between Peats Ferry Road and Railway Parade)	Jersey Street North, Asquith and Bridge Road (between Peats Ferry Road and Railway Parade) will be closed. Motor vehicle access to residential properties will be restricted along sections of Jersey Street North, Asquith and Bridge Road, Hornsby during these works for the safety of drivers and the community. See map on next page. Pedestrian access will be maintained so residents can access their properties. The roads will re-open to vehicles at 5am however only two lanes will be in operation until 8am. Two way traffic will be maintained, one lane in each direction. Traffic delays may be experienced. All four lanes will be returned by 8am Sunday 26 October.
Sunday 27 October to Monday 28 October (if required)	Single lane closure (8pm – 5am)	There will be a single lane closure along Jersey Street North, Asquith between Bridge Road, Hornsby and Pacific Highway (northbound traffic lane) and on Bridge Road (westbound traffic lane). Vehicle and pedestrian access to properties will be maintained at all times under traffic control.

Construction equipment

Equipment includes vacuum truck, excavators, cherry pickers, tip trucks, concrete truck, generators, light towers, crane truck, semi-trailer, chipper, drill rig, work vehicles and various hand tools.

Transport for NSW is committed to minimising noise impacts on the community. We switch off equipment when it is not being used, place equipment as far away from properties as possible and monitor our work activities to make sure noise levels are being managed effectively.

Road closure – 9pm Saturday 26 October to 5am Sunday 27 October

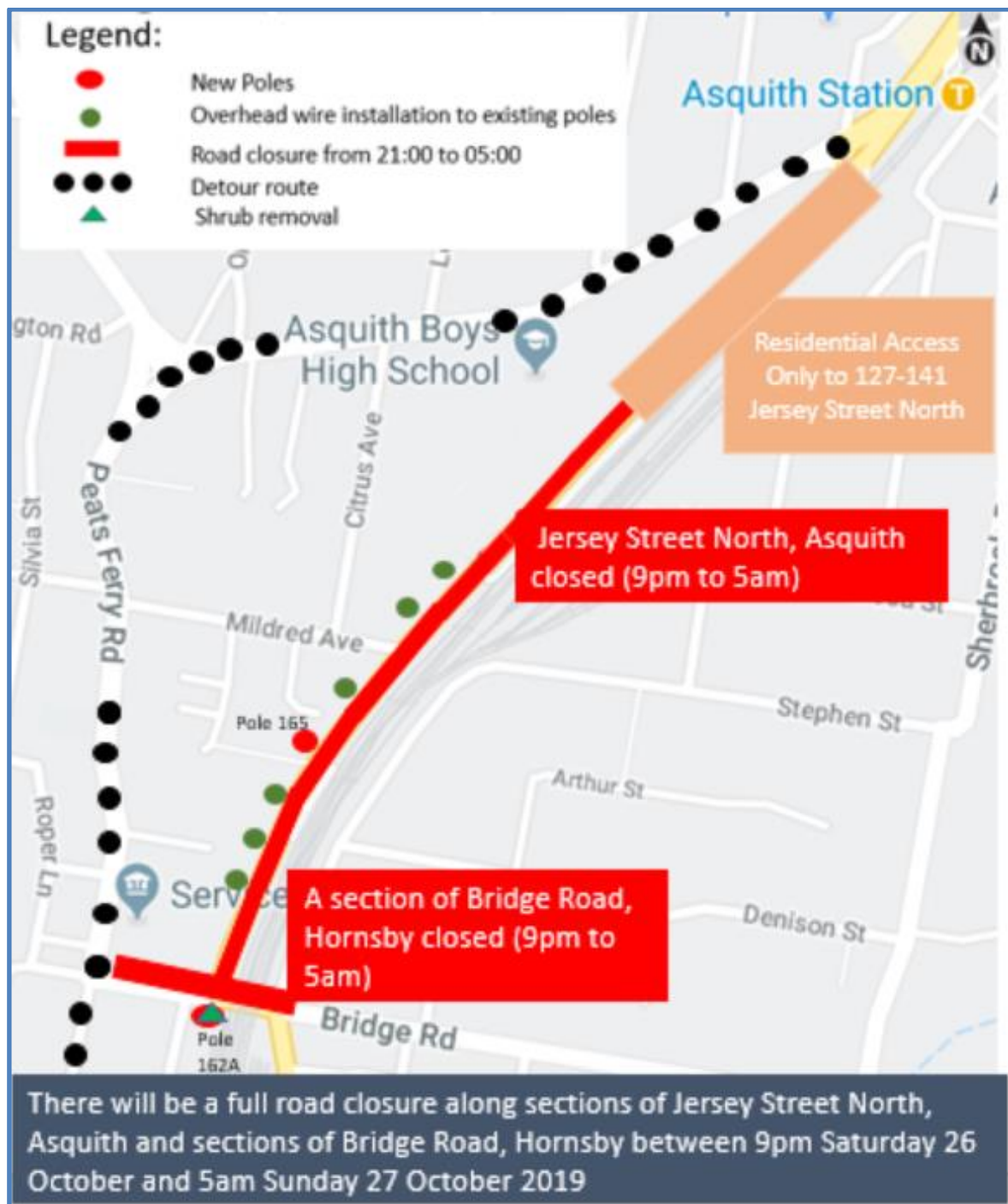

Keeping the community informed

If you would like to speak with the project team about these works, please contact us using the contact details provided below. Thank you for your understanding during this work.



This document contains important information about public transport projects in your area. If you require the services of an interpreter, please contact the Translating and Interpreting Service on **131 450** and ask them to call Transport for NSW on **(02) 9200 0200**. The interpreter will then assist you with translation.

For more information call **1800 684 490**,
Email projects@transport.nsw.gov.au or visit transport.nsw.gov.au/projects
For urgent enquiries or complaints regarding construction activities, please call 24 hours **1800 775 465**