

# New Intercity Fleet Maintenance Facility

## ENTERPRISE DRIVE INTERSECTION UPGRADE

The NSW Government is delivering a New Intercity Fleet to replace the trains carrying customers from Sydney to the Central Coast, Newcastle, the Blue Mountains and the South Coast.

The detailed design and construction of the new maintenance facility at Kangy Angy, which will service and maintain the New Intercity Fleet, is being delivered by John Holland on behalf of Transport for NSW.

### Changes to access - Old Chittaway Road

Construction of the new roundabout continues at the intersection of Enterprise Drive and Old Chittaway Road. Work has started on a temporary access into and out of Old Chittaway Road. This is to safely maintain motorists' access as construction of the roundabout progresses. We expect the new access to be operational from **Monday 14 October**.

Motorists should be aware of the changed traffic conditions, keep to reduced speed limits and follow the direction of traffic controllers and signs. Traffic safety barriers will be installed on both sides of the temporary access. We expect this new access to be in place until the next stage of roundabout construction.

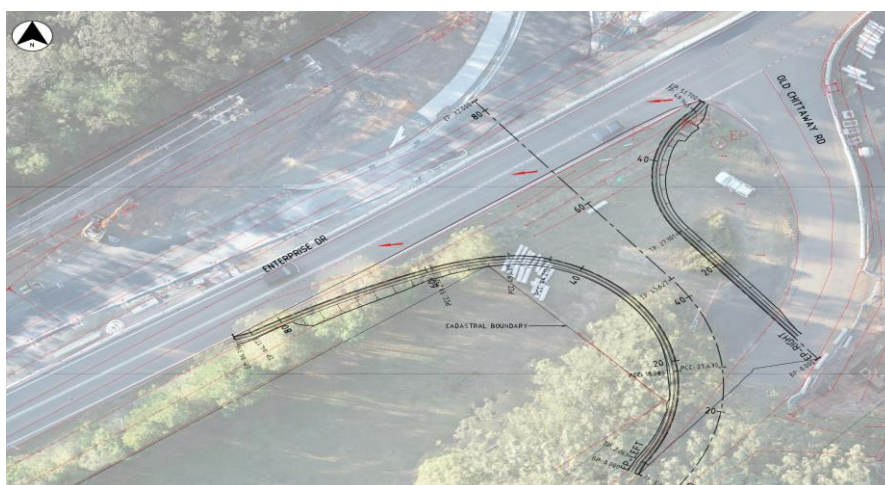

*Map showing the new temporary access into and out of Old Chittaway Road*

### Contact us

Working closely and effectively with the local community is a priority for Transport for NSW and John Holland. To provide us with feedback about the power outage, please call 1800 684 490, email [projects@transport.nsw.gov.au](mailto:projects@transport.nsw.gov.au) or visit [transport.nsw.gov.au/projects](https://transport.nsw.gov.au/projects). For urgent enquiries or complaints regarding construction activities, please call 24 hours 1800 775 465.