

Commuter Car Park Program

Edmondson Park

Project update

November 2020



Artist's impression of the new multi-storey car park, subject to detailed design

Transport for NSW is delivering more commuter car parking at Edmondson Park Station to provide you with more convenient access to public transport and reduce congestion on our roads.

The car park located south of the station will have approximately 1,000 additional commuter spaces and is expected to be completed and open to the community in mid-2021.

Progress update

In October, piling work for the car park lifts was completed (pictured right). Preparation work for two tower cranes being delivered and installed on site is currently underway. Removal of pile spoil and excavation material will be an ongoing task for the next few weeks.



Upcoming construction work

During November, the following work will occur on the new multi-storey car park:

- Excavation to remove top level asphalt
- Excavation, formwork and concreting for the lift and stair bases and footings
- Construction of tower crane foundations
- Delivery and installation of two tower cranes - the cranes will play an ongoing role in the construction of the new multi-storey commuter car park, lifting concrete, steel and materials to form the structure.

Work will take place between **7am to 6pm Monday to Friday and 8am to 1pm Saturdays**. Deliveries will be scheduled outside of peak times wherever possible to minimise disruption to pedestrians and motorists.

Temporary car park weekend closure

Work to complete the installation of lighting in the temporary commuter car park, north of the station, is expected to occur in November. This will require a weekend closure of the car park in order to complete the work safely. Signage will be in place ahead of time to inform customers about the work.

Parking options during construction

Commuter parking is available on the northern side of the station (see below map) during construction of the new multi-storey car park. View the map below for parking options.

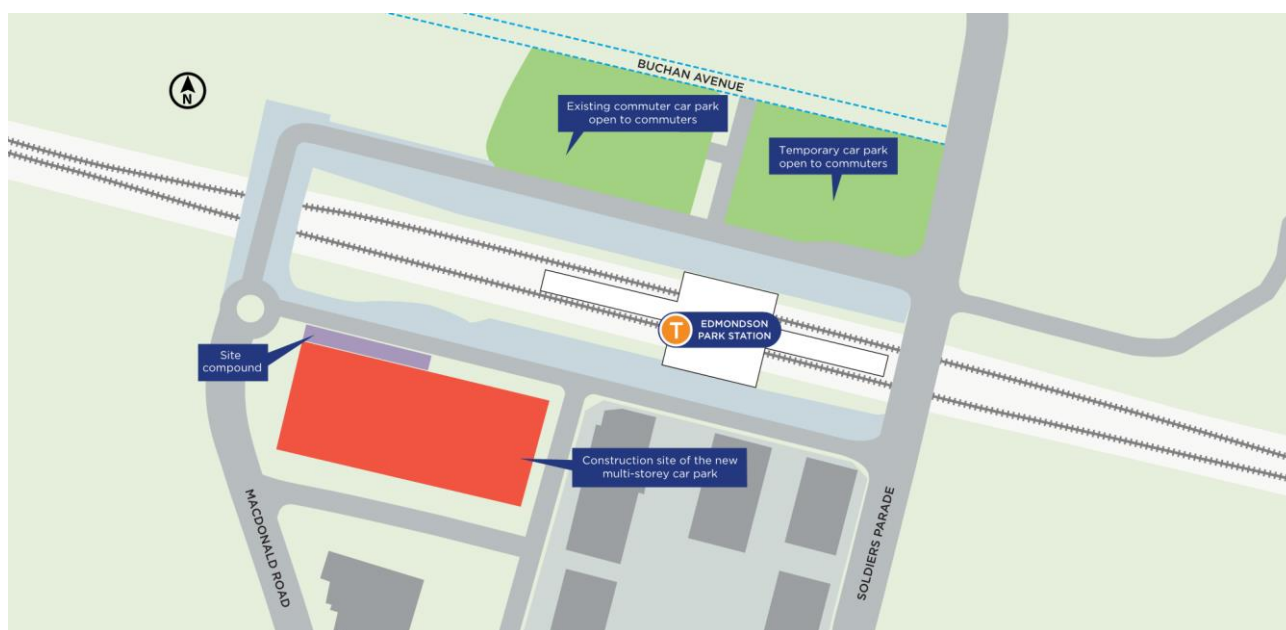

Keeping you up to date

We will continue to keep the community informed with regular project updates. More information about the project is available on our website www.transport.nsw.gov.au/edmondsonpark. If you would like to sign up to our project distribution list, please contact us on **1800 684 490** or email projects@transport.nsw.gov.au and we will email you regular updates.

For all urgent enquiries or complaints regarding construction activities, please call our **24-hour Construction Response Line** on **1800 775 465**.



This document contains important information about public transport projects in your area. If you require the services of an interpreter, please contact the Translating and Interpreting Service on **131 450** and ask them to call Transport for NSW on **(02) 9200 0200**. The interpreter will then assist you with translation.

For more information call **1800 684 490**

Email projects@transport.nsw.gov.au or visit www.transport.nsw.gov.au/edmondsonpark

For urgent enquiries or complaints regarding construction activities, please call 24 hours **1800 775 465**