

# Transport Access Program

## Wollstonecraft Station Upgrade

### Have your say



*Artist's impression of the proposed Wollstonecraft Station Upgrade, subject to change during detailed design*

## The NSW Government is improving accessibility at Wollstonecraft Station

Planning is underway to improve accessibility at Wollstonecraft Station. From **18 May – 1 June 2020** the community is invited to provide feedback on the Review of Environmental Factors. Community feedback will help Transport for NSW understand what is important to customers and the community.

## Why accessibility upgrades are needed at Wollstonecraft Station

Upgrading the station precinct will make Wollstonecraft accessible to those with a disability, limited mobility, parents/carers with prams and customers with luggage.

Key features include:

- two new lifts connecting to the station platforms
- new station entry ramps from Shirley Road and Telopea Street to provide accessible paths to the lifts
- platform raising work to bring platforms level with train carriages
- a covered boarding assistance zone on Platform 1
- a new accessible parking space on Shirley Road
- a new kiss and ride area on Shirley Road
- improved amenities such as a new male and female ambulant toilet and new family accessible toilet
- improved CCTV and lighting.

For more information call 1800 684 490

Email [projects@transport.nsw.gov.au](mailto:projects@transport.nsw.gov.au) or visit [transport.nsw.gov.au/wollstonecraft](https://transport.nsw.gov.au/wollstonecraft)

## Key features of the proposal

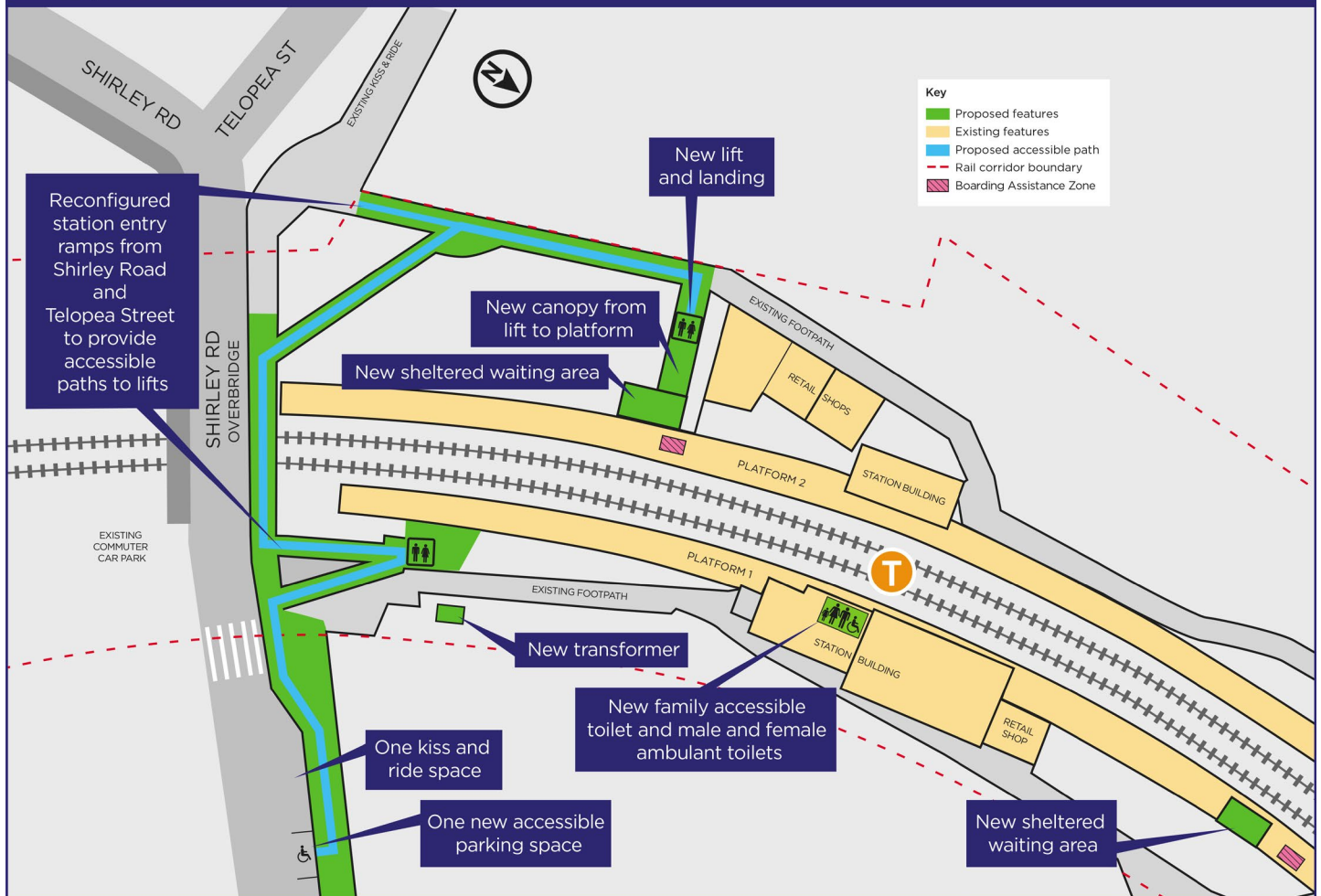

Indicative layout of Wollstonecraft Station Upgrade (subject to detailed design)

## Have your say

The Review of Environmental Factors is on public display from **Monday 18 May** until **Monday 1 June 2020**, and community feedback is invited during this time.

To view the REF, please scan the QR code or visit:



- [www.transport.nsw.gov.au/wollstonecraft](http://www.transport.nsw.gov.au/wollstonecraft)

Feedback can be submitted by:

- emailing [projects@transport.nsw.gov.au](mailto:projects@transport.nsw.gov.au)
- writing to **Transport Access Program – Wollstonecraft Station Upgrade**  
Associate Director, Planning – Transport for NSW  
Locked Bag 6501, St Leonards NSW 2065
- completing the feedback form at [www.transport.nsw.gov.au/wollstonecraft](http://www.transport.nsw.gov.au/wollstonecraft)

Please provide your feedback by **5pm 1 June 2020**.

**Your feedback will help Transport for NSW understand what is important to customers and the community.**

## COVID-19 social distancing measures

Under normal circumstances Transport for NSW would hold community information sessions at the station. We regret that due to COVID-19 social distancing measures, this is not possible. We are still available by phone and email and look forward to hearing your questions and feedback that way.

If you have any questions, please call the Project Infoline on **1800 684 490** or email [projects@transport.nsw.gov.au](mailto:projects@transport.nsw.gov.au).



## Next steps

Subject to planning approval, construction is expected to commence in late 2020 and take up to 18 months to complete.

Development of an initial concept design for the project.



**We are  
here**

Review of Environmental Factors prepared for public display and community feedback.



Transport for NSW reviews and responds to feedback from the community within a Determination Report.



Determination made whether project proceeds or not, detailing any changes to be made to the project scope.



Construction commences.

### Transport Access Program

This project is being delivered as part of the Transport Access Program, a NSW Government initiative to provide a better experience for public transport customers by delivering accessible, modern, secure and integrated transport infrastructure.

### Review of Environmental Factors

The Review of Environmental Factors is a planning document outlining the proposed work, potential impacts and mitigation measures.

The document includes comprehensive assessments on the existing environment, potential impacts of the project, and the proposed mitigation measures for things such as traffic and transport, biodiversity, noise and vibration, visual impacts and heritage.

### Remembering the station's history



There are two Wollstonecraft Railway Station signs at the station that have rail heritage significance. The signs are identified as a historical reminder of the 1930s-1940s era.

As part of our commitment to the station's heritage, the signs will remain in place and will continue to be maintained.



Artist's impression of the proposed Wollstonecraft Station Upgrade, subject to change during detailed design



This document contains important information about public transport projects in your area. If you require the services of an interpreter, please contact the Translating and Interpreting Service on **131 450** and ask them to call Transport for NSW on **(02) 9200 0200**. The interpreter will then assist you with translation.

#### Vietnamese

Tài liệu này có các thông tin quan trọng về các dự án giao thông công cộng trong khu vực của quý vị. Nếu quý vị cần sự giúp đỡ của thông dịch viên, xin vui lòng liên hệ với Dịch vụ Thông Phiên Dịch ở số điện thoại 131 450 và yêu cầu họ gọi cho Cơ quan Giao thông Tiểu bang NSW ở số điện thoại (02) 9200 0200. Sau đó thông dịch viên sẽ giúp thông dịch cho quý vị.

#### Arabic

تتضمن هذه الوثيقة معلومات عن مشاريع النقل العام في منطقتكم. إذا كنتم بحاجة إلى خدمات مترجم، الرجاء الاتصال بخدمة الترجمة الشفهية والخطية على رقم 131 450 واطلبوا منهم ان يتصلوا بقسم مشاريع النقل على رقم (02) 9200 0200. عندها يساعدكم المترجم بالترجمة.

#### Chinese

这份文件包含你所在地区公共交通工程项目的重要信息。如果你需要传译服务，请致电翻译与传译服务机构，电话 131 450，要求他们为你接通交通工程部(Transport for NSW)，电话是 (02) 9200 0200。传译员会为你做翻译。

For more information call 1800 684 490

Email [projects@transport.nsw.gov.au](mailto:projects@transport.nsw.gov.au) or visit [transport.nsw.gov.au/wollstonecraft](http://transport.nsw.gov.au/wollstonecraft)

