



Transport Access Program

East Hills Station Upgrade

Project update

March/April 2021



Artist's impression of East Hills Station Upgrade, subject to detailed design.

The NSW Government is improving accessibility at East Hills Station

Planning approval has been received for the upgrade of East Hills Station Upgrade

The approval follows public display of the Review of Environmental Factors from 25 November to 9 December 2020 and preparation of a Determination Report. The project team received 27 submissions during the public display period. Each submission was considered by the project team and responded to in a Determination Report. Transport for NSW would like to thank the community for their submissions.

The Determination Report and associated conditions of approval are available to view on the Transport for NSW website: www.transport.nsw.gov.au/easthills

Next steps

Investigations will commence on site soon, with site establishment scheduled to start in the second quarter of 2021, and construction expected to take around 12 months to complete.

The upgrade will include:

- two new lifts to provide access between the existing station underpass and the platforms
- upgrades to the existing station entrances on Park Road and Thompson Lane
- upgrade of the two accessible parking spaces in the Commuter Car Park along Park Road
- a new kiss and ride space on Park Road adjacent to the taxi zone
- upgrade of the pathway connecting MacLaurin Avenue to the Thompson Lane station entrance
- a new unisex family accessible toilet, and new male and female ambulant toilets
- electrical upgrades for new infrastructure
- new lighting, closed circuit television (CCTV) and wayfinding signage.

Upcoming site investigation work during March and April

To help inform the design for East Hills Station Upgrade, site and underground service investigations and service scanning will take place in the station precinct throughout March and April 2021. Work will commence **Monday 29 March 2021**, and will include:

- geotechnical investigation into the ground conditions (mainly in the rail corridor)
- surveys of the platform, station buildings and surrounding areas
- planning and investigation work.

Equipment to be used includes surveying equipment, excavator, hand auger, boring rig, vacuum truck, power and hand tools.

This work will take place during standard construction hours, which are **7am to 6pm Mondays to Fridays and Saturdays 8am to 1pm**. This work is expected to take five weeks to complete.

Design changes

Since the public display of the REF, the following design changes have been made to the project:

- extension of the existing station building to accommodate the new family accessible toilet
- the existing male toilet to be refurbished to a male ambulant toilet
- the existing female toilet to be refurbished to a female ambulant toilet.

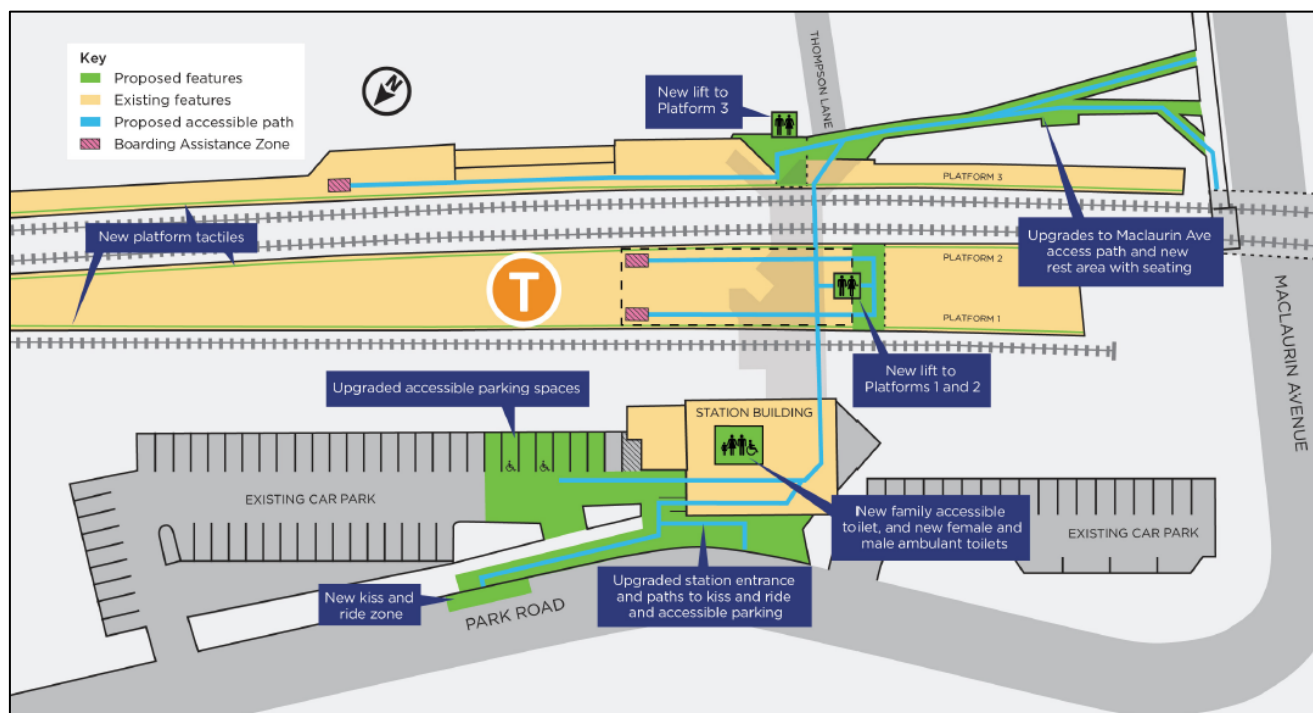

Key features of the East Hills Station Upgrade, subject to detailed design



Artist's impression of East Hills Station Upgrade, subject to detailed design.

Transport Access Program

This project is part of the Transport Access Program, a NSW Government initiative to provide a better experience for public transport customers by delivering accessible, modern, secure and integrated transport infrastructure.

The East Hills Station Upgrade will provide a station that is accessible to those with a disability, limited mobility, and parents/carers with prams and customers with luggage.

Keep in touch

We will continue to keep the community informed with regular project updates.

Further information is available on the project website transport.nsw.gov.au/easthills.

If you would like to be added to the project distribution list, or for more information on the East Hills Station Upgrade, please contact us on **1800 684 490** or email projects@transport.nsw.gov.au

For all urgent enquiries or complaints regarding construction activities, please call our 24-hour Construction Response Line on **1800 775 465**



This document contains important information about public transport projects in your area. If you require the services of an interpreter, please contact the Translating and Interpreting Service on **131 450** and ask them to call Transport for NSW on **1800 684 490**. The interpreter will then assist you with translation.

Chinese

这份文件包含你所在地区公共交通工程项目的重要信息。如果你需要传译服务，请致电翻译与传译服务机构，电话 131 450，要求他们为你接通交通部 (Transport for NSW)，电话是 1800 684 490。传译员会为你做翻译。

Greek

Το παρόν έγγραφο περιέχει σημαντικές πληροφορίες σχετικά με δημόσια έργα μεταφορών στην περιοχή σας. Αν χρειάζεστε τις υπηρεσίες διερμηνέα, παρακαλούμε επικοινωνήστε με την Υπηρεσία Μεταφράσεων και Διερμηνείας στο 131 450 και ζητήστε τους τηλεφωνήσουν στις Συγκοινωνίες στη ΝΝΟ στο 1800 684 490. Ο διερμηνέας θα σας βοηθήσει στη συνέχεια με τη μετάφραση.

Vietnamese

Tài liệu này có các thông tin quan trọng về các dự án giao thông công cộng trong khu vực của quý vị. Nếu quý vị cần sự giúp đỡ của thông dịch viên, xin vui lòng liên hệ với Dịch vụ Thông Phiên Dịch ở số điện thoại 131 450 và yêu cầu họ gọi cho Cơ quan Giao thông Tiểu bang NSW ở số điện thoại 1800 684 490. Sau đó thông dịch viên sẽ giúp thông dịch cho quý vị.

Arabic

تتضمن هذه الوثيقة معلومات عن مشاريع النقل العام منطقتكم. إذا كنتم بحاجة إلى خدمات مترجم، في الرجاء الإتصال بخدمة الترجمة الشفهية والخطية على رقم 131 450 واطلبوا منهم ان يتصلوا بمصلحة 1800 684 490 المواصلات في نيو ساوث ويلز على رقم عندها يساعدكم المترجم بالترجمة.