



Commuter Car Park Program

St Marys Station

Changes to commuter parking at St Marys Station

May 2021

What is happening at St Marys?

Transport for NSW is providing additional commuter parking at St Marys, a joint initiative of the Australian and NSW Governments. Additional commuter car parking at St Marys Station will provide the community with more convenient access to public transport and reduce congestion on our roads.

The project includes adding two levels to the existing multi-storey commuter car park to provide around 250 new spaces. The new spaces will support the proposed new metro station interchange at St Marys. The car park is expected to be complete and open to commuters in early 2022.

What does this mean for commuters?

From late May 2021 to early 2022, some parking spaces in the ground level Harris Street car park and levels two and three of the existing multi-storey car park will be temporarily unavailable in stages. This is to allow work to be carried out safely.

The ground level and level one of the multi-storey car park will remain available to commuters for the duration of construction. Please see map overleaf for details of site establishment work.

What is the timing for the work?

May

From late May site sheds and the site compound will be established. This will require the temporary removal of **approximately 30 spaces** in the Harris Street car park and ground level of the multi-storey car park.

June

From early June construction work will begin on the additional levels. In order to undertake this work safely, **level three (rooftop)** of the multi-storey car park will be **closed for approximately six months**.

July

From early July – **level two** of the multi-storey car park will be temporarily unavailable for **approximately four months** to enable construction work to safely occur on the rooftop for the additional levels.

Get in touch

We will continue to keep the community informed with regular project updates. More information about the project is available on our website www.transport.nsw.gov.au/stmarys.

If you have any questions about the project or would like to sign up to receive project updates via email, please contact us at 1800 684 490 or email projects@transport.nsw.gov.au.

Site map of St Marys Commuter Car Park project

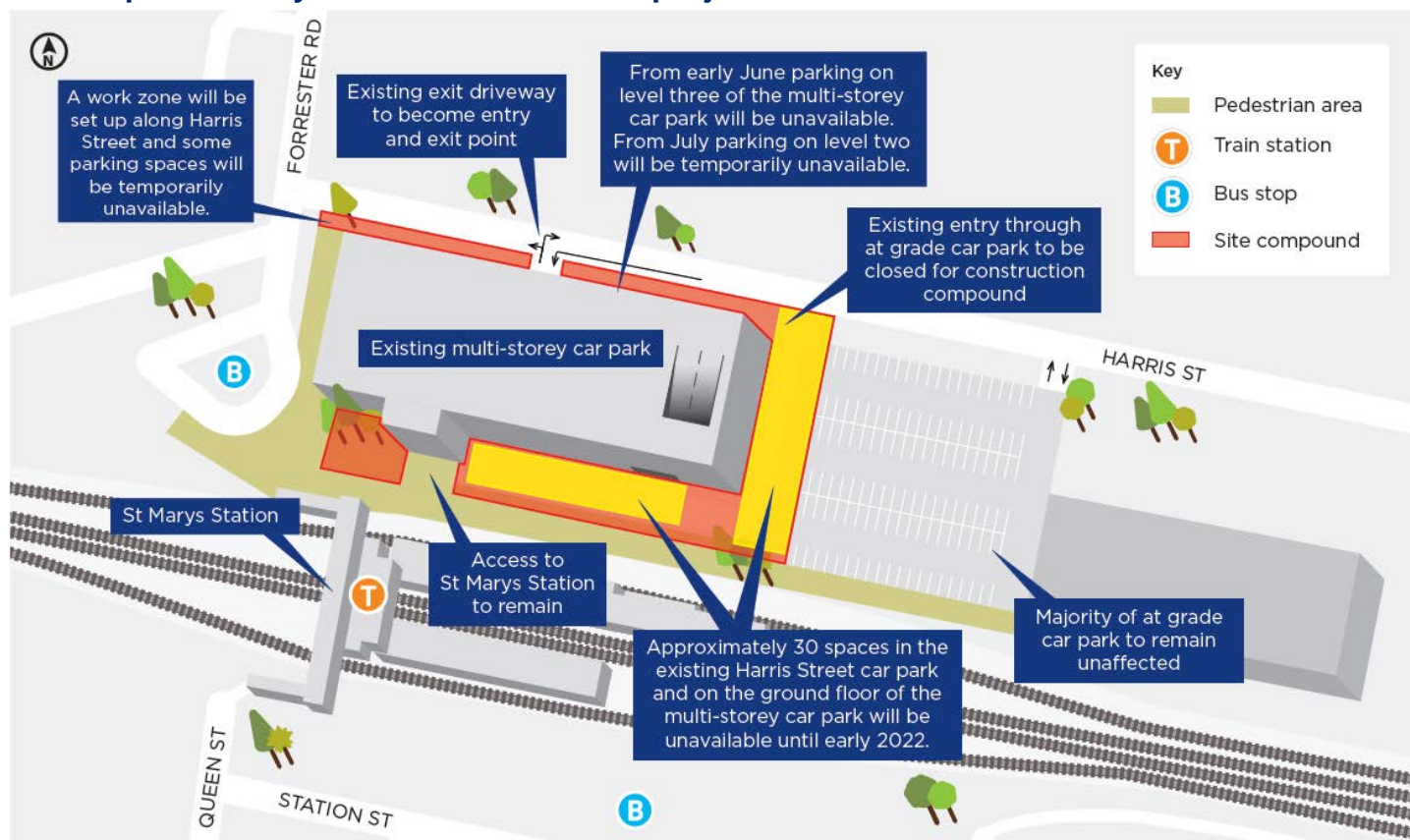

Alternative parking options

We understand commuters will need to use alternative parking options and apologise for any inconvenience caused as part of the extension work. We recommend commuters utilise available commuter parking at nearby stations including Werrington, Kingswood, Mt DrUITT and Rooty Hill. These nearby stations currently have parking available. Additional parking is also available in the Penrith Station multi-storey car park with express train services into the Sydney CBD.

It may take you longer than usual to find a parking space or you may need to go to a nearby station. Plan your journey ahead of time. If possible, please consider working from home.

Approximate travel time to drive from St Marys to nearby stations



Get to the station via the bus

Where possible, customers are encouraged to consider alternative modes of transport such as buses to get to St Marys Station. Visit transport.nsw.info to see if there is a bus services that could help get you to the station.

For more information call 1800 684 490

Email projects@transport.nsw.gov.au or visit www.transport.nsw.gov.au/stmarys

For urgent enquiries or complaints regarding construction activities, please call 24 hours 1800 775 465