

# Commuter Car Park Program

## St Marys Station

Project update

May 2021



*Artist's impression of St Mary's Commuter Car Park, subject to detailed design*

Transport for NSW is providing additional commuter parking at St Marys, a joint initiative of the Australian and NSW Governments. Additional commuter car parking at St Marys Station will provide the community with more convenient access to public transport and reduce congestion on our roads.

The project includes adding two levels to the existing multi-storey commuter car park to provide around 250 new spaces. The new spaces will support the proposed new metro station interchange at St Marys. The car park is expected to be complete and open to commuters in early 2022.

Planning approval for the project was granted in February following public display of the Review of Environmental Factors. A copy of the Determination Report, including responses to submissions is available on our website at [www.transport.nsw.gov.au/stmarys](http://www.transport.nsw.gov.au/stmarys).

## Site establishment and temporary removal of some commuter parking – from Thursday 27 May

From Thursday 27 May our contractor, A W Edwards will begin work on site in preparation for construction on the car park extension scheduled to begin from early June. In order to complete this work safely, some parking spaces in the Harris Street car park and on the ground level of the multi-storey car park will be closed temporarily for the duration of construction.

### Changes to entry and exit along Harris Street

As part of site establishment work, the site compound and site sheds will be installed in the Harris Street car park and on the ground floor of the multi-storey car park. As a result, the existing entry to the multi-storey car park will be closed for the duration of construction and moved to Harris Street. The existing exit on Harris Street will be modified to accommodate both entry and exit (see below map). Signage will be installed around the car park to help commuters with this change.

A work zone will also be established on Harris Street and will require the removal of some on-street parking.

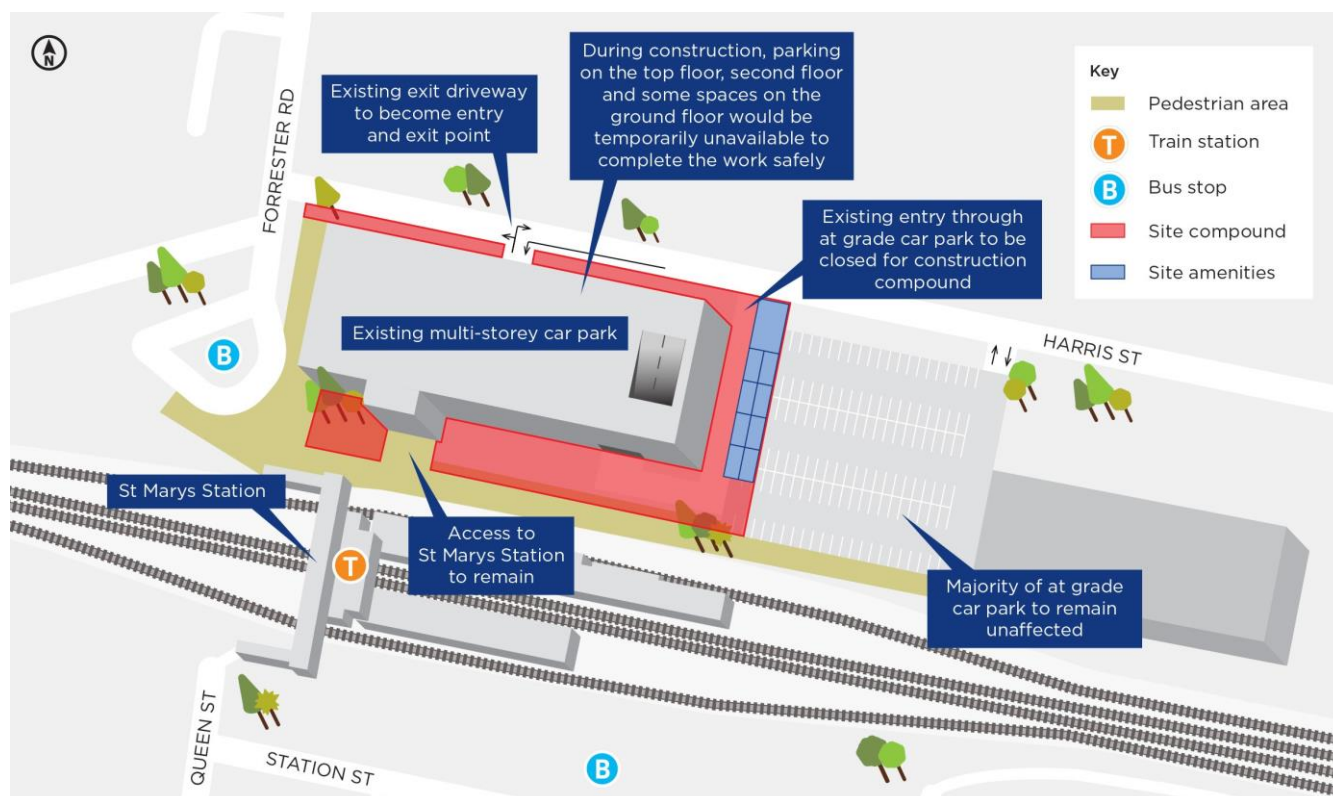

### Changes to parking from early June

From early June construction on level three of the multi-storey car park will commence. In order to complete this work safely, level three (rooftop) will close for approximately six months. From July, as construction work progresses, level two of the multi-storey car park will be closed for approximately four months. We apologise in advance for any inconvenience our work and these temporary changes may cause.

### Alternative commuter parking nearby

We understand commuters will need to use alternative parking options and apologise for any inconvenience caused as part of the extension works. We recommend commuters utilise available commuter parking at nearby stations including Werrington, Mt Druitt and Rooty Hill. These nearby stations currently have parking availability. Additional parking is also available in the Penrith Station multi storey car park with express train services into the Sydney CBD.

## Upcoming construction work

During May and June, the following work will occur on the new car park:

- Scanning around the outside of the car park to identify existing services
- Wayfinding signage on ground floor of the multi storey car park will be altered
- A site compound and site sheds will be established
- Fencing and shade cloth will be installed
- Perimeter scaffolding will begin to be constructed
- Hoardings will be installed at various points around the car park for the safety of the community and construction workers
- Demolition of existing structural elements on the rooftop car park will commence in order to enable future extension works.

Existing lifts and stairs to access the ground floor will remain open and accessible to commuters.

## Vegetation removal

Some trees and vegetation will need to be removed for the car park extension. All trees removed as part of the project will be offset with landscaping at the end of the project.

## Construction hours

Work will take place during standard construction hours between **7am to 6pm Monday to Friday and 8am to 1pm on Saturdays**. Deliveries will be scheduled outside of peak times wherever possible to minimise disruption to local businesses, pedestrians and motorists.

## Key features of the St Marys Commuter Car Park

- a new lift and extension of the existing lift and stairs
- additional accessible parking spaces
- provision for future electric vehicle charging spaces
- CCTV, lighting and wayfinding for improved safety and security
- provision for future Transport Park&Ride infrastructure (Opal operated boom gates)
- additional motorcycle bays.

## Keeping you up to date

We will continue to keep the community informed with regular project updates. More information about the project is available on our website [www.transport.nsw.gov.au/stmarys](http://www.transport.nsw.gov.au/stmarys). If you would like to sign up to our project distribution list, please contact us on **1800 684 490** or email [projects@transport.nsw.gov.au](mailto:projects@transport.nsw.gov.au). We send project updates via email monthly.

For all urgent enquiries or complaints regarding construction activities, please call our **24-hour Construction Response Line** on **1800 775 465**.



This document contains important information about public transport projects in your area. If you require the services of an interpreter, please contact the Translating and Interpreting Service on **131 450** and ask them to call Transport for NSW on **1800 684 490**. The interpreter will then assist you with translation.

For more information call **1800 684 490**

Email [projects@transport.nsw.gov.au](mailto:projects@transport.nsw.gov.au) or visit [www.transport.nsw.gov.au/stmarys](http://www.transport.nsw.gov.au/stmarys)

For urgent enquiries or complaints regarding construction activities, please call 24 hours **1800 775 465**