

# Redfern Station Upgrade

## New Southern Concourse

Transport for NSW | May 2022



### What happened in April and what is planned next?

During April, we removed materials within the building at 125-127 Little Eveleigh Street and installed stormwater drainage on Little Eveleigh Street. In Marian Street, work continued on the shared zone and on roof installation for the new electrical building.

Throughout May, work activities will continue on the New Southern Concourse, and new station entrances and shared zones in Little Eveleigh and Marian Streets.

Our standard construction hours are 7am to 6pm Monday to Friday and 8am to 6pm Saturday. Due to unforeseen events, such as weather, some construction activities may run slightly past 6pm, but these activities are not expected to be noisy.

### Are there activities planned outside of standard construction hours?

Electrical work, delivery of plant and equipment, installation and pre-assembly of bridge components including stairs, lifts, canopies, roof panels and screens, and platform resurfacing will occur during the following times.

- 2am Saturday 7 May to 2am Monday 9 May
- 10pm Friday 13 May to 2am Monday 16 May
- 2am Saturday 21 May to 2am Monday 23 May
- 2am Saturday 28 May to 2am Monday 30 May.

**Pedestrian access to Platform 10 will be closed on 2am Saturday 30 April to 2am Monday 2 May and 2am Saturday 21 May to 2am Monday 23 May.** Traffic control and detour signs will be in place to direct pedestrians via Gibbons Street.

Service investigation, excavation and stormwater installation will also occur intermittently at the corner of Little Eveleigh Street and Lawson Street on the following dates.

- 10am Friday 29 April to 6am Monday 2 May
- 10am Friday 6 May to 6am Monday 9 May
- 10am Friday 13 May to 6am Monday 16 May
- 10am Friday 20 May to 6am Monday 23 May.

**A single lane closure on Lawson Street will be in place during these times.**

Traffic control, detour and information signage will be in place to safely direct and assist motorists, cyclists, and pedestrians. Please refer to the map on the last page for more information.

Minor traffic delays may be experienced during the stop and slow traffic arrangement.

If there are weather impacts, the work activities will occur during another weekend in May, but we will keep the community updated.

Material and equipment removal, deliveries, concrete pouring, pre-assembly of lift components and electrical work may also occur up to two nights per week. This is not expected to be noisy.

## Why are there activities planned outside of standard construction hours?

Night work is required to be undertaken outside standard construction hours to ensure the safety of workers, pedestrians, and motorists, and to minimise impacts to traffic.

Sometimes out of hours work can be noisy. A noise assessment will be undertaken prior to the work, and more information will be provided to impacted residents closer to date.

## Station area and platforms update

During May, work will continue at and around the station area and on platforms. This includes:

- Fit out of the lift shafts, stairs, and bridge
- Electrical work
- Installation of cable casings across platforms and platform canopies, and on the existing Northern Concourse.

Work will continue behind Platform 1, including rock breaking, excavation, concreting, drilling, material removal and the installation of stairs and a lift shaft.

## Little Eveleigh Street update

Stage two of Little Eveleigh Street is due to begin in mid to late May. Residents will receive more information before stage two construction starts.

From **Sunday 1 May to Tuesday 31 May**, work activities will occur on Little Eveleigh Street during standard construction hours. These activities include:

- Underground services exploration
- Roadway and footpath excavation
- Backfilling
- Concreting
- Service and stormwater installation
- Pavement installation

- Tree and tree roots investigation
- Tree and tree stump removal.

Work activities on the building at 125-127 Little Eveleigh Street will include the removal of materials, external scaffolding installation, concreting, piling, hammering and service installation. A crane will operate behind Platform 1 to remove and deliver material and equipment into the building.

## Marian Street update

Work in the Marian Street compound includes the assembly of lift shafts and other bridge components, fit out, tiling and painting of the electrical building, and service connections. Cranes will operate within the compound to lift in components of the bridge.

Work activities on the new shared zone will continue within standard construction hours from **Sunday 1 May to Tuesday 31 May**. These include:

- Excavation
- Concreting
- Rock breaking
- Service and stormwater installation
- Pavement installation
- Underground services exploration
- Drainage and stormwater installation and backfilling.

**From Sunday 1 May to Friday 3 June**, a temporary road closure will be in place on Rosehill and Marian Streets, between Margaret and Cornwallis Streets. Residents can access their properties via Cornwallis Street and traffic control will be in place to manage cyclists, pedestrians, and motorists. Please refer to the map overleaf for more information.

If you require any further information regarding the work program for Little Eveleigh or Marian Street, please call 1800 684 490 or email [projects@transport.nsw.gov.au](mailto:projects@transport.nsw.gov.au)

## Where will work take place?

Project and work areas include inside the rail corridor, at our site compounds at North Eveleigh and Marian Street, and on Little Eveleigh, Lawson, Wilson, and Marian Streets. The site access points are at Newtown, Eveleigh, and Erskineville.

## Upcoming changes to parking

Parking will be temporarily removed on surrounding streets for service searching and delivery of plant and equipment to our site compounds.

- **Up to 10 parking spaces will be temporarily unavailable on Rosehill Street from Monday 9 May to Friday 20 May**
- **Up to six parking spaces will be temporarily removed on Wilson Street from Sunday 1 May to Friday 13 May**
- **Up to six parking spaces will be temporarily unavailable on Wilson Street from Sunday 22 May to Wednesday 25 May**

Please refer to the map on the last page for more information.

## What you may notice

Equipment used during all of the activities outlined in this notification may include cranes, vacuum trucks, elevated work platforms, access equipment, flatbed crane trucks, excavators, dump trucks, core hole drills, compactors, forklifts, concrete trucks and concrete pumps, watercart, chainsaws, lighting towers, generators, work vehicles and hand held power tools.

At times, our activities require the use of equipment that operates at a higher sound level than standard equipment. These include power saws, grinders, jackhammers, rollers, rattle guns, vacuum trucks, rock hammers or breakers and piling rigs. The use of some equipment can cause vibration and may be noticeable to nearby residents.

We will minimise noise and vibration impacts by turning off equipment when not in use and where possible, using noise absorbing blankets.

A real time environmental management system is in place to ensure noise, vibration and dust levels are operating within our project requirements.

For more information on how we manage our noise and vibration impacts, please refer to the Construction Noise and Vibration Management Plan under the

“Management Plans” section on the project webpage ([transport.nsw.gov.au/redfern](https://transport.nsw.gov.au/redfern)).

## How are we staying safe?

We continue to deliver projects across NSW while ensuring the safety of all staff and the community. All activities being undertaken adhere to COVID safe practices and comply with current NSW Health COVID-19 Public Health Orders and restrictions.

### Contact us

If you have any questions or would like more on the Redfern Station Upgrade project, please contact our project team:



Project information line: **1800 684 490**



24/7 construction response line:  
**1800 775 465**



[projects@transport.nsw.gov.au](mailto:projects@transport.nsw.gov.au)



[www.transport.nsw.gov.au/redfern](http://www.transport.nsw.gov.au/redfern)



PO Box K659, Haymarket NSW 1240



If you need help understanding this information, please contact the Translating and Interpreting Service on 131 450 and ask them to call us on 1800 684 490.

May 2022

Privacy Transport for NSW (TfNSWS) is subject to the Privacy and Personal Information Protection Act 1998 (“PIIP Act”) which requires that we comply with the Information Privacy Principles set out in the PIIP Act. All information in correspondence is collected for the sole purpose of assisting in the delivery of this project. The information received, including names and addresses of respondents, may be published in subsequent documents unless a clear indication is given in the correspondence that all or part of that information is not to be published. Otherwise we will only disclose your personal information, without your consent, if authorised by the law. Your personal information will be held by us at 27 Argyle Street, Parramatta. You have the right to access and correct the information if you believe that it is incorrect.

## Temporary parking and access changes in May



- Key**
- Temporary removal of parking spaces on Rosehill Street from Sunday 1 May to Friday 3 June
  - Temporary removal of parking spaces on Rosehill Street from Monday 9 May to Friday 20 May
  - Temporary road closure on Rosehill and Marian Streets between Margaret and Cornwallis Streets from Sunday 1 May to Friday 3 June
  - Footpath open on Marian Street
  - One way traffic access on Cornwallis Street for Watertower and Ariane apartments
  - Detour on Margaret Street

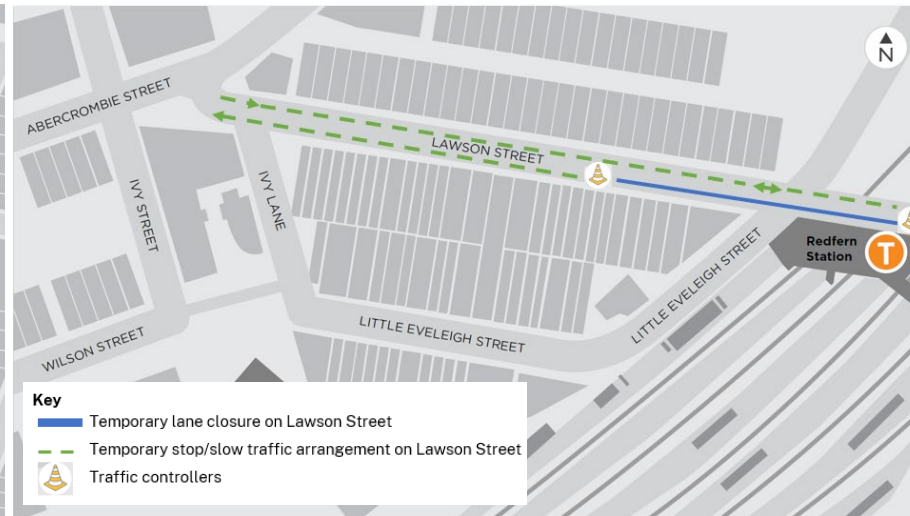

- Key**
- Temporary lane closure on Lawson Street
  - Temporary stop/slow traffic arrangement on Lawson Street
  -  Traffic controllers



- Key**
- Temporary removal of parking spaces on Wilson Street from Sunday 1 May to Friday 13 May and Sunday 22 May to Wednesday 25 May

Left: maps showing temporary parking and access changes on Marian, Rosehill, Wilson and Lawson Streets during May