



Commuter Car Park Program

Emu Plains

Community Notification | December 2022 and January 2023

Project overview

Transport for NSW is constructing a new commuter car park at Emu Plains Station to provide the community with more convenient access to public transport and reduce congestion on our roads. The project is jointly funded by the Australian and NSW Governments. The car park, which will be accessed via a new roundabout at the intersection of Old Bathurst Road and Smith Street, will provide approximately 750 additional commuter parking spaces.

As part of this project, a new 220-metre footpath with lighting and fencing will be built between the new commuter car park through to the Great Western Highway. This will provide an improved pedestrian connection between the Nepean Creative and Performing Arts High School and the railway station, without the need for students to cross the road at the intersection of Old Bathurst Road and the Great Western Highway.

Progress update and upcoming work

Work to enable the construction of the new roundabout at the intersection of Old Bathurst Road and Smith Street has progressed well through November.

The following work is planned to occur in December and January:

- Construction of the roundabout on Old Bathurst Road
- Adjustments to fencing around the eastern abutment of the new footbridge
- Utilities work including water main diversions and construction of protection slabs in Old Bathurst Road
- Start construction of the footpath on the western side of Old Bathurst Road under the rail bridge through to the Great Western Highway. This will include some tree and vegetation removal.

Minor traffic flow changes will be made as required, and traffic controllers and signage will be in place for the safety of motorists and workers. Some short periods of daytime contra-flow (one lane at a time under traffic control) may be necessary. Please observe signage and the directions of traffic controllers.

Night work in December

Subject to approval, a section of **Old Bathurst Road will have a temporary single lane closure for night work between 9pm and 5am on Friday 2 December** for asphaltting work and **from Monday 12 December for up to four nights (workers will be on site from 6pm)** for the safe installation of a water main. Traffic control will be in place to allow two-way traffic but one lane at a time. Work will include lighting towers, metal pipe saws, excavator, bobcat, mobile crane, tip truck, service and delivery vehicles, compactor, and hand tools.

Further night work is planned for late January 2023, and we will provide an additional community notification closer to the time.

Map of work areas in December 2022 and January 2023

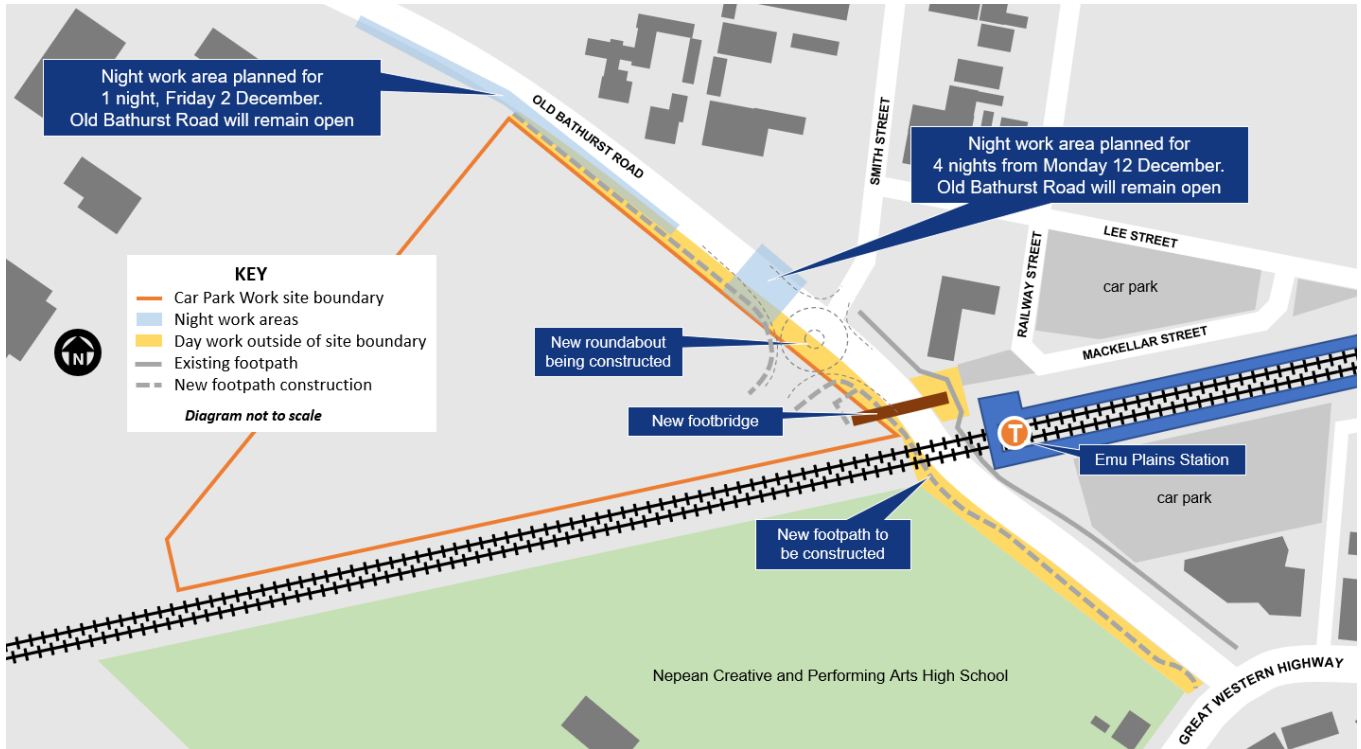

Construction hours

Standard construction hours are 7am to 6pm Monday to Friday and 8am to 1pm Saturdays. All work is dependent on weather, site conditions and COVID restrictions and may be varied without additional notice.

The site will close from Saturday 24 December and work will restart from Monday 9 January 2023. During this time, security patrols will keep the site secure. The team wish you a very happy and safe holiday season.

Keeping you up to date

More information is available on our website transport.nsw.gov.au/emuplains. If you would like to sign up to our project distribution list, please contact us on 1800 684 490 or email projects@transport.nsw.gov.au and we will email you regular updates. For all urgent enquiries or complaints regarding construction activities, please call our 24-hour Construction Response Line on 1800 775 465.



Translating and interpreting service

If you need help understanding this information, please contact the Translating and Interpreting Service on 131 450 and ask them to call us on 1800 684 490.