



Redfern Station Upgrade

Lawson Street utility and road work

May 2023



Transport for NSW acknowledges the Gadigal people of the Eora Nation as the Traditional Custodians of the lands on which we work and pay respects to Elders past and present.

Lawson Street utility and roadworks

Utility and road works are planned to occur on upcoming weekends in May and June, at the corner of Little Eveleigh and Lawson streets.

Our work will include:

- Installing new kerbs, stormwater drains and gutters
- Excavating, backfilling and concreting
- Road resurfacing.

When we are working

The work will be over the following weekends:

- **7pm Friday 19 to 5am Monday 22 May**
- **7pm Friday 23 to 5am Monday 26 June.**

What this means for you?

You may notice:

- Workers and vehicles
- Traffic controllers and signage
- Noise and vibration from machinery and equipment, such as grinders, jackhammers, power saws, rattle guns, rock hammers/breakers, rollers and vacuum trucks.

Traffic and parking impacts

A single westbound lane closure on Lawson Street will be in place, which may cause minor traffic delays.

The southern footpath on Lawson Street near the work site will be closed and pedestrian detours will be in place via the northern footpath.

Eveleigh Street will be closed from Caroline Street to Lawson Street.

Traffic control and signage will assist motorists, cyclists, and pedestrians.

Access to some driveways on Little Eveleigh Street will be unavailable during the work.

Residents and workers with driveways impacted will be provided dedicated parking space in the Little Eveleigh Street interim car park.

Further details on map overleaf.

Managing our impacts

We reduce noise and vibration by turning off machinery when not in use and, where possible, use noise absorbing blankets. For more information about the project's noise and vibration management, please refer to the *Construction Noise and Vibration Management Plan* which can be viewed on the project webpage: transport.nsw.gov.au/redfern.



Work area and traffic impact map

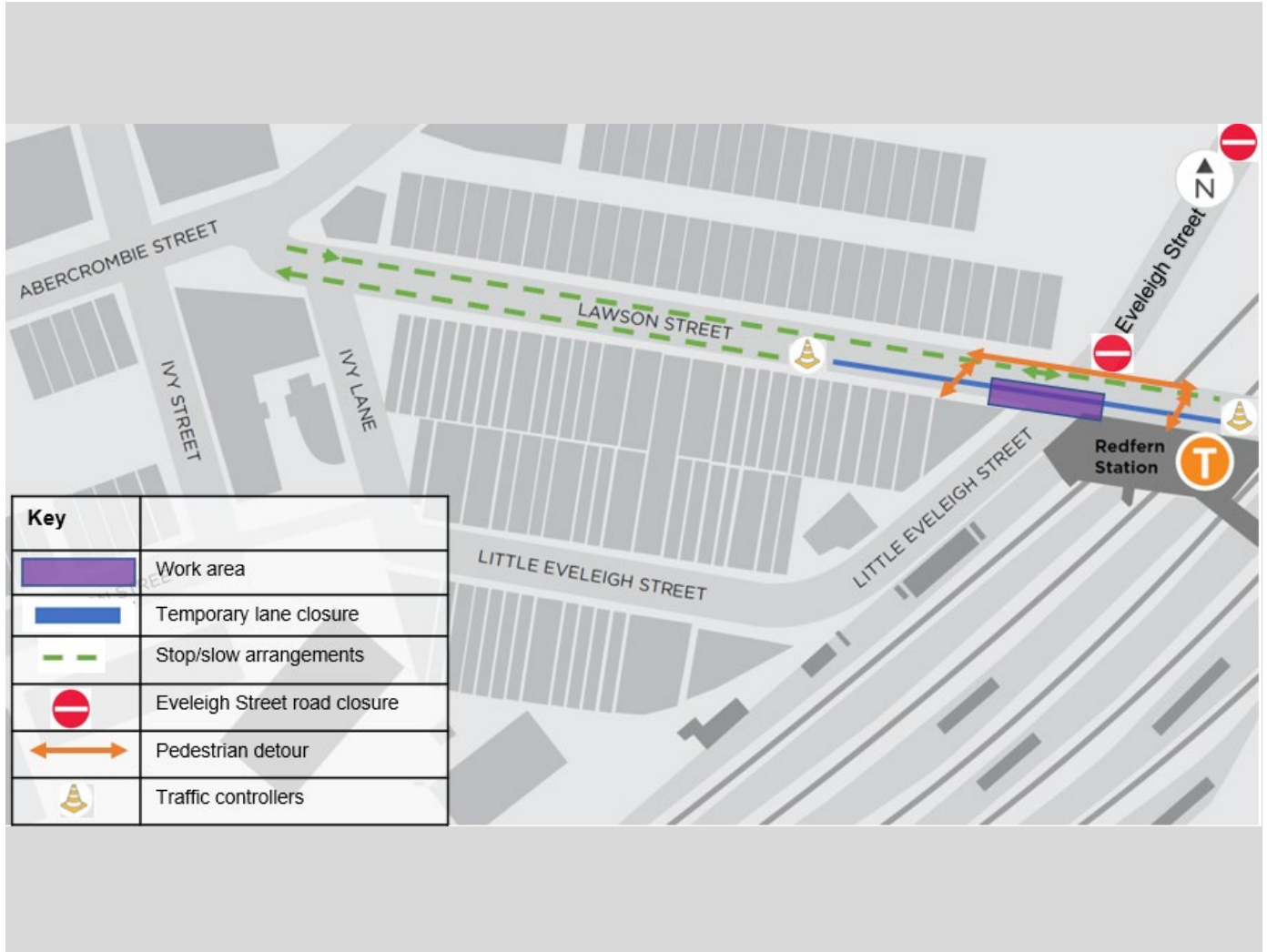

Contact us



Project Infoline **1800 684 490**
24-hour Construction Response Line
1800 775 465



projects@transport.nsw.gov.au



PO Box K659
Haymarket, NSW 1240



Visit the online portal go to
www.transport.nsw.gov.au/redfern



Interpreter service

For languages other than English call 131 450
Arabic • Cantonese • Hindi • Mandarin • Vietnamese
لطلب خدمة الترجمة الشفهية للغات غير الإنجليزية اتصل بالرقم
131 450

獲取英語以外的其他語言傳譯協助服務可以致電**131 450**
अंग्रेज़ी के अतिरिक्त अन्य भाषाओं के लिए दुभाषिया सेवा **131 450**
पर कॉल करें

获取英语以外的其他语言口译协助服务可以致电**131 450**

Để có dịch vụ thông ngôn cho các ngôn ngữ khác tiếng Anh,
gọi số **131 450**