

March 2023

Barton Highway Upgrade

Traffic changes at Boundary Lane, Rolfe Road and Church Lane

The Australian Government and NSW Government are investing in the Barton Highway upgrade.

What are we doing?

Work is progressing on the new two-lane northbound carriageway for the first stage of the Barton Highway Upgrade. As part of this upgrade, we need to close Boundary Lane intersection on the northern end of the project, and property accesses between the construction site compound at the ACT-NSW border and Church Lane.

During this stage of the work, the existing Boundary Lane intersection will be closed. Access to Boundary Lane will be available via the new northbound lanes between Boundary Lane and Rolfe Road. Northbound and southbound road users will be required to use the Rolfe Road intersection to access Barton Highway.

Property accesses between the construction site compound and Church Lane will be diverted via Church Lane to access the Barton Highway. Traffic will be diverted onto the new lanes at the Church Lane intersection to access the existing highway.

These traffic arrangements will allow work to be completed north of Boundary Lane and within the median at the northern end of the project, and the new temporary southern tie-in with the Barton Highway to be carried out at the ACT-NSW border.

When are we working?

This temporary traffic arrangement will be in place from **Wednesday 15 March 2023 for up to eight months**, weather permitting. **Our work hours are between 7am and 6pm weekdays and 8am and 1pm Saturdays, excluding public holidays.**

There may be a need to carry out some work at night to reduce impacts on traffic. Nearby residents will be notified in advance of this work.

How will the work affect you?

Please note that during this time, all vehicles travelling to and from Boundary Lane, will travel through the construction zone between Rolfe Road and Boundary Lane. All road users are to follow signage and travel at a 40km/h speed limit.

There may be maintenance work required at different times. Traffic controllers will be in place whenever there is work within this area.

A map showing the traffic changes is over the page.

Traffic changes

Lane closures, traffic control and reduced speed limits will be in place during work hours and may affect travel times. Road users are advised to allow up to five minutes extra travel time to their journey while work is under way.

Barton Highway upgrade

Traffic changes at Boundary and Church lanes.

Please keep to speed limits and follow the direction of traffic controllers and signs. For the latest traffic updates, you can call **132 701**, visit **livetraffic.com** or download the **Live Traffic NSW App**.

We apologise for any inconvenience and thank you for your patience during this important work.

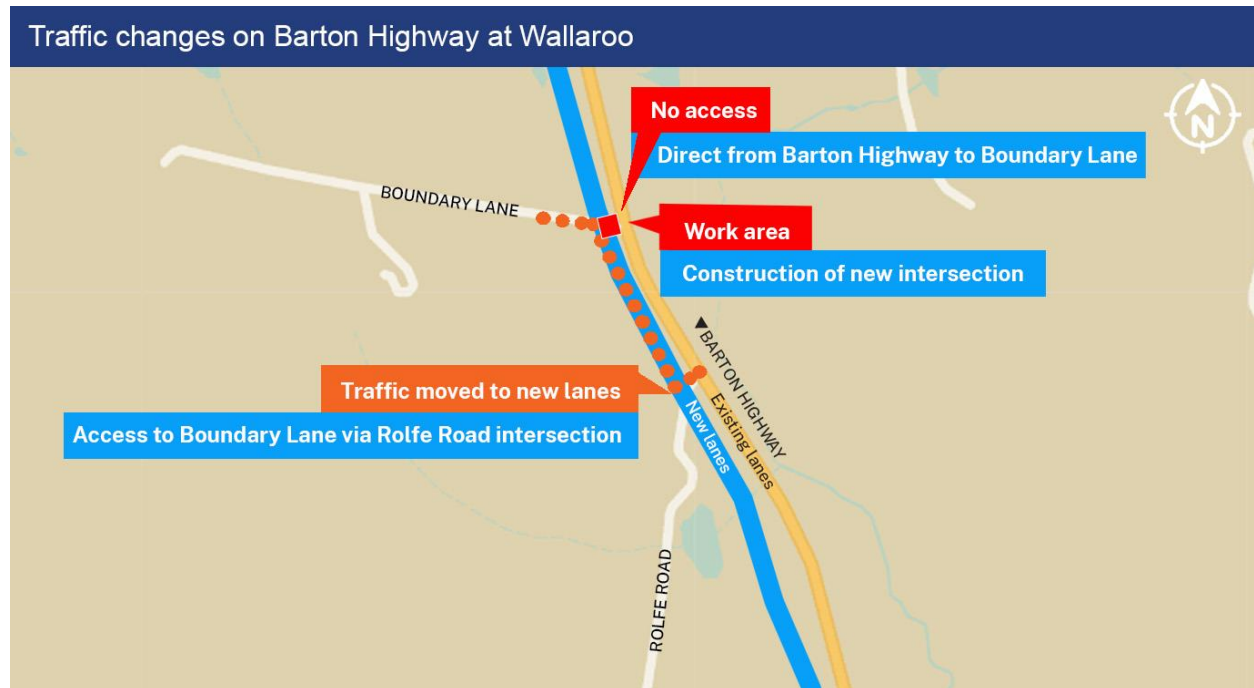

Contact us

If you have any questions, please contact our project team on 1800 931 250 or barton.highway@transport.nsw.gov.au.

Thank you for your patience during this important work.



Translating and Interpreting Service

If you need help understanding this information, please contact the Translating and Interpreting Service on **131 450** and ask them to call us on 1800 931 250250.