

# Culvert strengthening works – Kamilaroi Highway, Walgett

May 2023



Transport for NSW acknowledges the Traditional Custodians of the lands on which we work and pay respects to Elders past and present.

## Culvert strengthening works will be carried out on the Kamilaroi Highway between Walgett and Narrabri.

The location of works is from the intersection with Beanbri Road, east of Walgett, to Burren Junction, a total length of about 47 kilometres. We have included a map to show location of the works.

### What work are we doing?

Walgett Shire Council will deliver the work which will include replacing and extending 12 culverts located on the Kamilaroi highway between Walgett and Burren Junction.

### When we'll be working

Work will be carried out from **Wednesday 31 May for about four weeks**, weather permitting.

Working hours are between **7am and 6pm Monday to Friday** and between **7am and 1pm on Saturdays** from **31 May**.

We will let you know in advance if we need to do any work outside these times.

### Traffic changes

There will be temporary traffic changes to ensure the work zone is safe.

**Lane closures and a 40km/h speed limit will be in place during work hours and may affect travel times.**

Motorists should allow up to **5 minutes extra travel time** during this work.

Outside work hours, both lanes will be open and revert to the posted speed limit

### Oversize Overmass (OSOM) Vehicles

Restrictions will be in place for **vehicles over 5 metres wide** during work hours. Vehicles which exceed this limit will need to **notify us on 0400 472 488 ahead of your journey** so that arrangements can be planned within the construction area to minimise delays.

### What will this mean for you?

Please keep to speed limits and follow the direction of traffic controllers and signs.

For the latest traffic updates, you can call 132 701, visit **livetraffic.com** or download the Live Traffic NSW App.

### Managing our impacts

The work will involve the use of machinery which generates some noise. We will make every effort to minimise noise by turning off machinery and vehicles when not in use.



## Location of work area

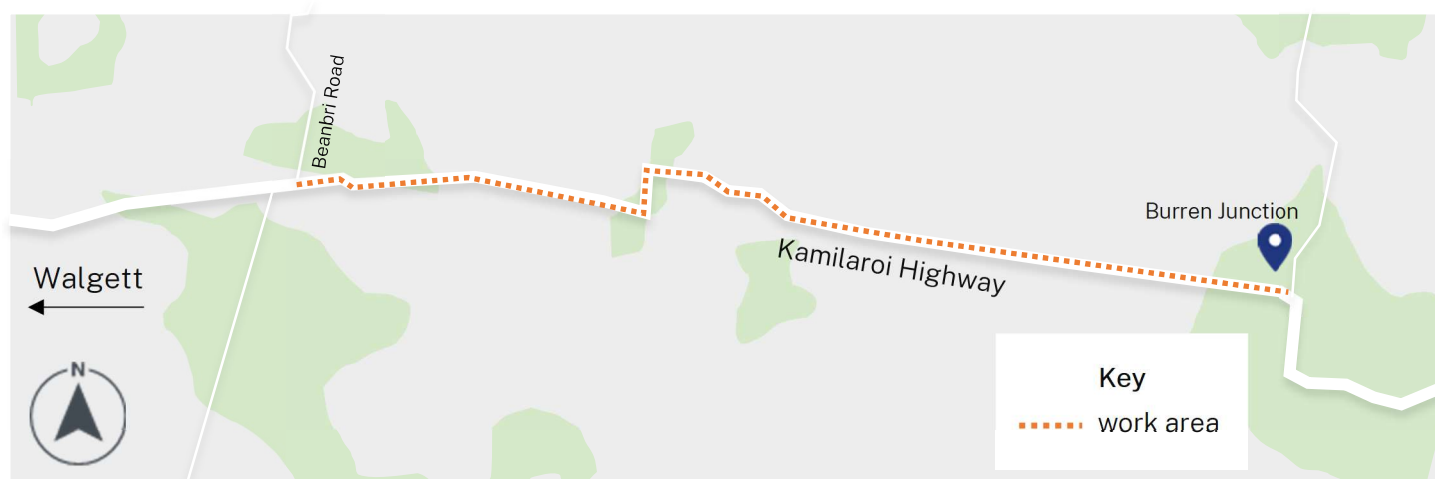

## Contact us



Project Infoline **1800 167 499**



**Western.projects@transport.nsw.gov.au**



**yoursay.transport.nsw.gov.au/**



51 – 55 Currajong Street  
PARKES, NSW 2870



### Interpreter service

For languages other than English call 131 450  
Arabic • Greek • Hindi • Mandarin • Vietnamese

لطلب خدمة الترجمة الشفهية للغات غير الإنجليزية اتصل  
بالرقم **131 450**

Για υπηρεσίες διερμηνείας σε άλλες γλώσσες εκτός από  
τα Αγγλικά καλέστε το **131 450**

अंग्रेज़ी के अतिरिक्त अन्य भाषाओं के लिए दुभाषिया सेवा  
**131 450** पर कॉल करें

获取英语以外的其他语言口译协助服务可以致电**131 450**

Để có dịch vụ thông ngôn cho các ngôn ngữ khác tiếng  
Anh, gọi số **131 450**