

Start of work and project delivery

Early work on the project started in June 2022 and is progressing well. Early work will continue until late-January 2023, weather permitting.

Work on the main project will start in **February 2023**.

You will notice the following work activities as we start delivering the project:

- Temporary footpaths will be constructed to the new station entrances to provide access to platforms 1 and 2

- Opal card readers and station passenger information systems will be relocated near to the new station entrance
- Hoardings will be installed on station platforms and the Bryant Street carpark on the platform 1 side of the station
- Hoardings will be installed on the Pacific Highway on platform 2 side of the station
- Portions of the canopies on both platforms will be removed to allow for the commencement of piling.



Work hours

Standard work hours are between **7.00am to 6.00pm Monday to Friday** and **8am to 1pm on Saturday**, with no work on Sundays or on public holidays. Some out of hours work will be required throughout the project delivery. This will mostly occur during planned rail shutdown weekends.

Work within the rail corridor must be timed to occur when the rail line is closed for maintenance. Out of hours work may also be scheduled outside planned rail shutdown weekends. We will provide the community advance notice of when out of hours work is occurring. The project is due for completion in 2024. We will continue to keep the community informed as the project progresses.

Contact us

If you have any questions or would like more information please contact our project team:

-  1800 684 490 (business hours)
-  projects@transport.nsw.gov.au
-  www.transport.nsw.gov.au/tuggerah



Scan the QR code to visit the project webpage.



This document contains important information about Transport projects in your area. If you require the services of an interpreter, please contact the Translating and Interpreting Service on 131 450 and ask them to call Transport Projects on 1800 684 490. The interpreter will then assist you with translation.

Pub No. 22.345



Transport for NSW

Tuggerah Station Upgrade

Transport Access Program

Project Update

January 2023

www.transport.nsw.gov.au/tuggerah



Artist's impression of new buildings for Tuggerah Station viewed from Pacific Highway

The NSW Government is improving accessibility at Tuggerah Station



The upgrade of Tuggerah Station is being delivered as part of the Transport Accessibility Program (TAP), a NSW Government initiative to provide a better experience for public transport customers by delivering accessible, modern, secure and integrated transport infrastructure across the state.

The upgrade will enhance connectivity between the station and Tuggerah Precinct, improve the public domain and make it easier for everyone to access public transport services, including people with a disability, people with mobility aids, parents or carers with prams and travellers with luggage.

Transport for NSW awarded the contract for the design and construction of the TAP upgrade of Tuggerah Station to Downer Group in December 2022.

Key features of the proposed upgrade

- New pedestrian footbridge, lifts and stairs connecting the Pacific Highway, commuter car park and station platforms
- Demolition of the existing footbridge, stairs and connecting ramps
- New and extended canopies at station platforms
- New family accessible, and male and female ambulant toilets
- Platform widening to improve customer accessibility
- Upgrades to station entrances, including landscaping and new bicycle hoops
- 15 accessible parking spaces in the commuter car park
- Accessibility upgrades to bus stops, and kiss and ride spaces
- Improvements to CCTV, lighting and wayfinding signage
- New and upgraded footpaths at station.

Demolition of the existing footbridge, stairs and connecting ramps will not be carried out until the upgrade is completed.

Changes to the project design

Transport consulted with the community on the Tuggerah Station upgrade and displayed the Review of Environmental Factors for community comment in March and April 2021. The project team received 12 submissions which were considered and responded to before the project was approved in May 2022.

The detailed design for the project has been completed. The following modifications have been made to the design:

- Relocation of the new footbridge 10 metres to the south
- Reconfiguration of new Disability Discrimination Act compliant (DDA) car parking spaces
- Provision of new compliant ramps adjacent to the entry stairs to achieve independent access to both sides of the station
- New pedestrian footpath from the bus stop to the station entrance (Pacific Highway)
- Provision of a family accessible toilet, male and female ambulant toilets and a new Station Master's office at concourse level
- Installation of new switchback stairs and relocation of lifts near to stairs (south of the concourse) to provide an equitable entrance for all customers
- Extension of existing canopy on platform 1.

 **New family accessible, and male and female ambulant toilets**

 **Opal card readers and station passenger information systems will be relocated**

Transport has completed a consistency assessment for the upgrade, which involves a review of the existing approved project and the proposed design modifications. It has been determined that the proposed design modifications still provide equitable access to the station in line with the original requirements outlined in the Review of Environmental Factors (REF) and meet the requirements for Disability Standards Accessible Public Transport.

Proposed new station layout - incorporating changes to detailed design

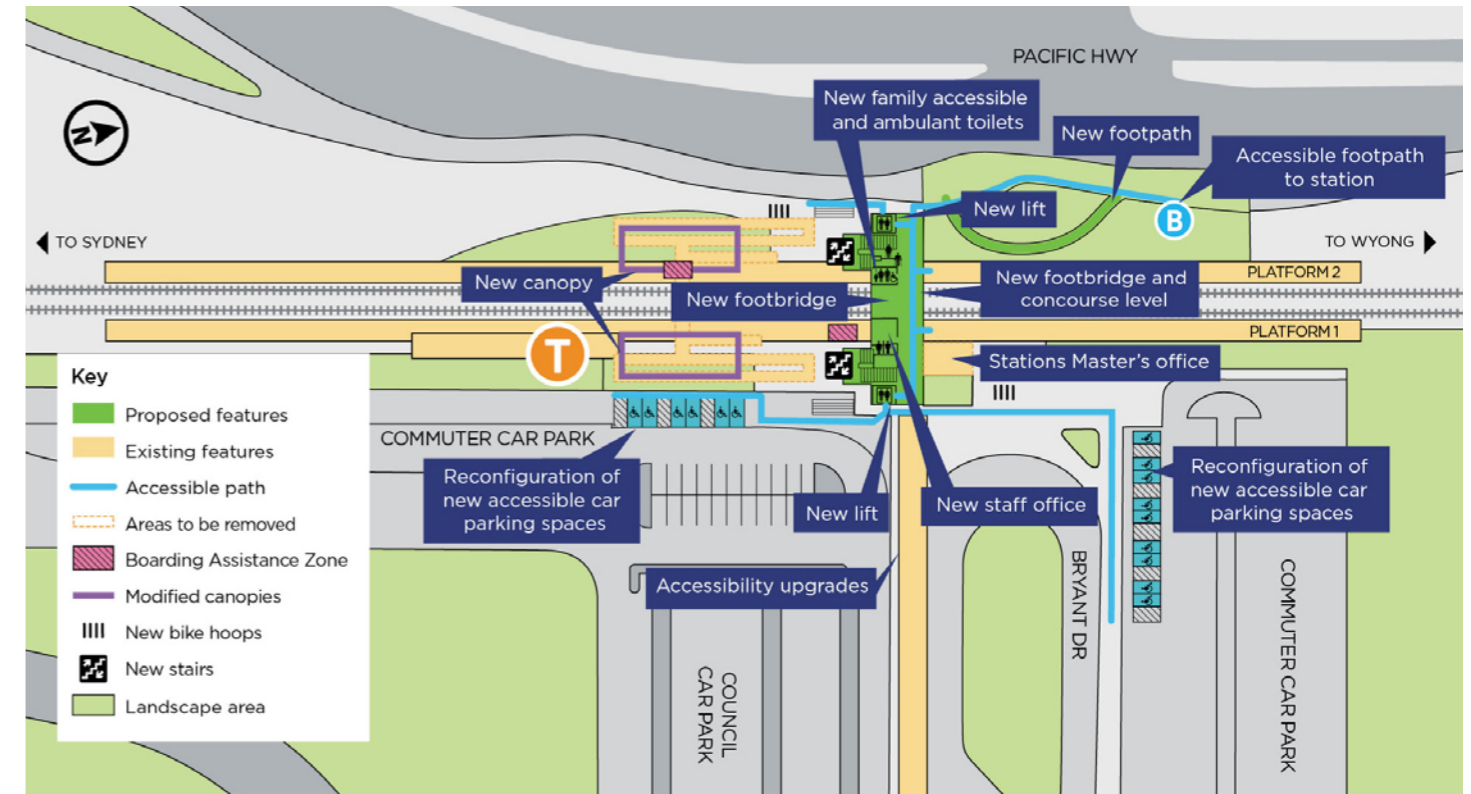

Preparing for the Tuggerah Station upgrade - site establishment underway