

## Acknowledgement of Country

Transport for NSW acknowledges the Wallumedegal people of the Dharug Nation as the traditional custodians of the land on which we work and live.

We pay our respects to Elders past and present and celebrate the diversity of Aboriginal people and their ongoing cultures and connections to the lands and waters of NSW.

Many of the transport routes we use today – from rail lines, to roads, to water crossings – follow the traditional Songlines, trade routes and ceremonial paths in Country that our nation's First Peoples followed for tens of thousands of years.

Transport for NSW is committed to honouring Aboriginal peoples' cultural and spiritual connections to the lands, waters and seas and their rich contribution to society.

---

### 1. Why are early works required?

To enable the widening of Epping Bridge, the chiller unit attached to the northern end of the Sydney Metro South Service Building (South Service Building), located within the rail corridor on High Street, needs to be relocated.

In its current location the chiller unit will impact the proposed new, widened bridge. Early works will see the chiller unit relocated to the southern end of the South Service Building.



*Artist impression of the chiller unit in its new location -southern end of the Sydney Metro South Service Building*

This work is required to be completed ahead of commencement of the main works to replace the bridge. Further information on the project location can be seen in the diagram below.

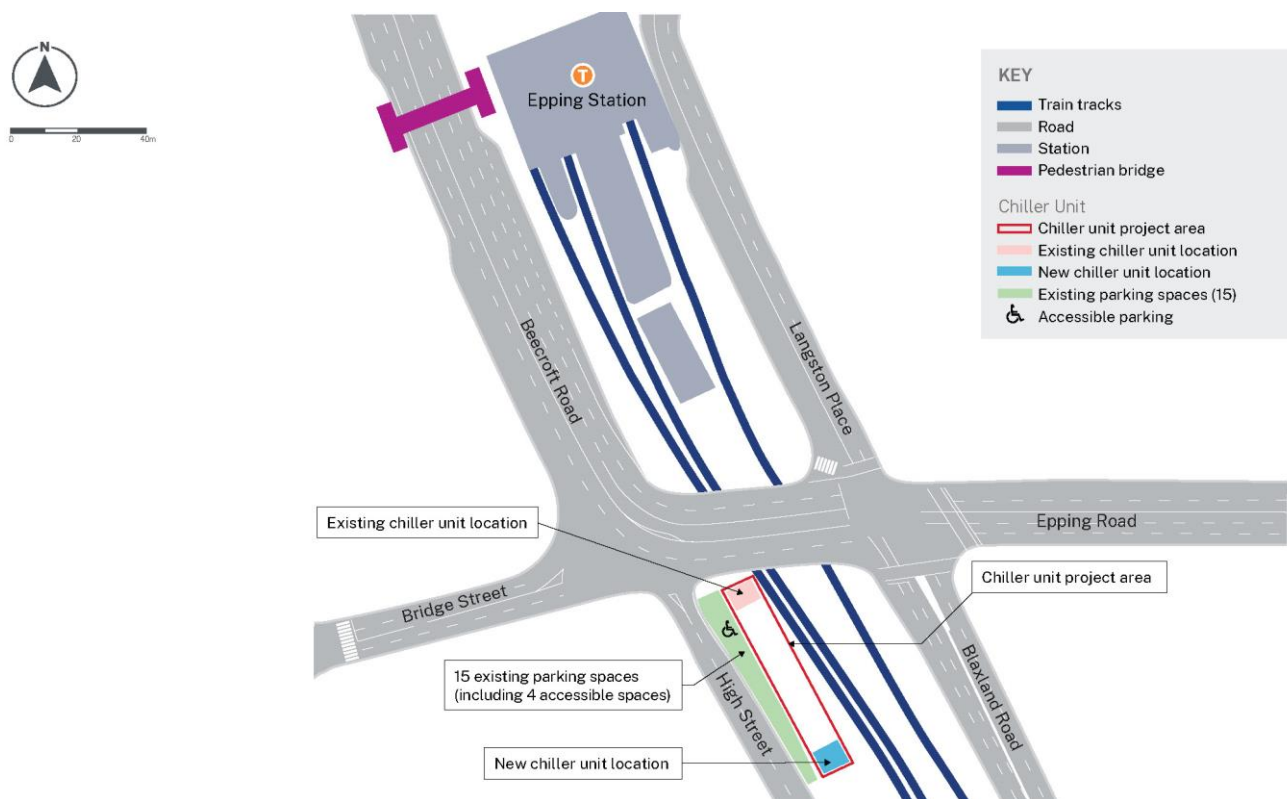

*Project location for early works (chiller unit relocation)*

## 2. What is the purpose of the chiller unit?

The chiller unit provides spot cooling of the Epping Station Sydney Metro platforms. Cooling of the Sydney Metro platforms will not be impacted by chiller unit relocation works.

## 3. What work will be carried out as part of early works?

The chiller unit is currently located on the northern end of the South Service Building and within the rail corridor adjacent to High Street. Early works will see the chiller unit relocated to the southern end of the South Service Building. Mechanical, electrical, communications and hydraulic services will be adjusted and reconnected at the new location.

A more detailed description of works to be completed is as outlined below:

- site compound establishment, including construction fencing
- demolition of partial fence and vehicle barrier in new chiller unit location
- construction of a new chiller unit enclosure, including minor earthworks/cut, new footing/foundations
- deck, acoustic enclosure cladding, ventilation louvres and doors and access ways
- adjustment of services
- relocation of the existing chiller unit to the new enclosure and connection at the new location
- demolition and removal of redundant services
- demolition of existing chiller unit (7.5 metres long and 4.7 metres wide), including ancillary structures and fencing
- construction of new fencing and site rectification at the location of the existing chiller unit.

#### **4. Was an environmental assessment carried out?**

An Environmental Impact Assessment (EIA) checklist was completed for early works. An EIA checklist is a type of environmental impact assessment which assesses potential environmental impacts such as air, water, noise, biodiversity and heritage.

The EIA checklist prepared for early works – chiller unit relocation is available to view or download from the project webpage: [transport.nsw.gov.au/epping-bridge](https://transport.nsw.gov.au/epping-bridge)

#### **5. Will there be a site compound?**

As part of early works a site compound and laydown area will be established within the rail corridor on High Street and approximately 300 metres south of the South Service Building. The site compound will be used for the duration of the works.

The site compound will be used for the storage of equipment, construction materials and for staff amenities.

The site compound will be used during our standard working days and when additional work is being carried out during planned Sydney Trains and Sydney Metro weekend trackwork.

#### **6. When will early works commence and be completed by?**

Early works are expected to commence in late July 2024 and take approximately nine months to complete, weather permitting. The community will be kept updated as the project progresses.

#### **7. Will early works impact High Street traffic?**

Temporary traffic changes will be required at times on High Street to make sure the work zone is safe and to enable delivery of materials required for construction.

Lane closures, a contraflow traffic arrangement and reduced speed limits will be used, which may at times affect travel times.

Traffic controllers will be on site to assist motorists, residents, pedestrians and cyclists as required.

The community will be notified of any changes to traffic, or access to residential or business properties, via doorknock, letterbox drop, Electronic Direct Marketing (EDM), project webpage updates and social media at least five (5) days before any traffic changes come into effect.

Construction vehicles will primarily use Epping Road, Beecroft Road and High Street to access the construction area and compound site.

#### **8. Will early works impact pedestrians?**

To enable access to the compound and laydown areas and construction site, the footpath adjacent to the chiller unit and South Service Building on High Street will be temporarily closed for the duration of construction, with pedestrian traffic diverted to the western footpath.

Traffic controllers will be on site to assist residents and pedestrians as required.

## **9. Will early works impact parking on High Street?**

There will be temporary impacts to the parking spaces on High Street, adjacent to the South Service Building during different stages of the early works.

Some of the parking spaces will be used to secure the construction site and as a laydown area. It is also expected that there will be a period of up to one week when all 15 parking spaces, including the four accessible parking spaces, will be occupied by the construction work. This is when the chiller unit is being relocated from the northern end of the South Service Building to the southern end of the building.

Further information will be provided to the community before we commence work and as the project progresses.

## **10. When will early works be carried out?**

Early works will be carried out during the day between **Monday** and **Friday, 7am to 6pm** and **Saturday, 8am to 1pm**.

Additional work may need to be carried out during planned Sydney Trains and Sydney Metro weekend trackwork.

We will notify the community if we intend to carry out any work outside of our standard working days and hours.

## **11. Is Epping Bridge Project funded?**

The Australian and NSW governments are jointly providing \$220 million in funding for the Epping Bridge Project.

## **12. How is planning progressing for main works?**

In April 2023, Transport for NSW awarded Mott MacDonald Australia the contract to develop the concept design, prepare the Review of Environmental Factors (REF) and manage early investigation work.

Development of the project's concept design and REF is still ongoing. Once these are completed the REF and concept design will go on public display and the community invited to provide feedback. The REF will outline and identify environmental impacts, constraints, risks and opportunities for the project.

As part of concept design development and preparation of the REF, investigation works were undertaken in the road and rail corridors between August 2023 and February 2024.

## **13. When can the community provide feedback on the project?**

The community will be provided with an opportunity to provide feedback on the concept design and Review of Environmental Factors (REF) when placed on public display.

Submissions received during the public display of the REF will be responded to in a Determination Report which will be made publicly available to the community to view or download via the project webpage: [transport.nsw.gov.au/epping-bridge](https://transport.nsw.gov.au/epping-bridge)

At this stage, development of the project's concept design and REF is still ongoing, with timing of public display yet to be determined.

Transport for NSW will continue to engage with the community and stakeholders throughout the planning and delivery stages of the project. The community will be kept informed via the project webpage, community notifications, email alerts, social media posts and media announcements.

We encourage community members to subscribe to the project's email distribution list to receive project updates as soon as they happen via email.

## **14. When will construction of the bridge start and finish?**

Commencement of construction is subject to planning approval, which will be outlined in the Determination Report.

Once planning approval is received, the project will proceed to detailed design and then construction. Construction is expected to take approximately five years to complete.

For the safety of the community and our workers, some of the work on the Epping Bridge Project needs to be completed during Sydney Trains track work weekends, when no trains are running through Epping Station. This only occurs for selected few weekends during the year, and the project's ability to complete work during these weekends is also dependent on other circumstances, such as weather.

## **15. How can I get project updates?**

To receive project updates as they become known, please contact us so that we can add you to the project's email distribution list. Please contact us by email at [parramatta@transport.nsw.gov.au](mailto:parramatta@transport.nsw.gov.au) or by phone 1800 979 577 (during business hours).

## **16. How can I get further information on the Epping Bridge Project?**

Further information on the Epping Bridge Project is available on the project webpage and in the Epping Bridge Project Frequently Asked Questions, July 2023 document which is available to view or download on the project webpage: [transport.nsw.gov.au/epping-bridge](https://transport.nsw.gov.au/epping-bridge)

To access the project webpage you can also scan the QR code.

### **Have any questions?**

If have any questions or concerns about the work or would like to subscribe to the project email distribution list, please contact the project team via email at [parramatta@transport.nsw.gov.au](mailto:parramatta@transport.nsw.gov.au) or by calling 1800 979 577.

**SCAN ME**



To subscribe to the email distribution list for this project, please contact [parramatta@transport.nsw.gov.au](mailto:parramatta@transport.nsw.gov.au)