

Lewisham Station Upgrade

Safe Accessible Transport program

July 2024



Photograph of Lewisham Station, February 2024

The NSW Government is improving accessibility and safety at Lewisham Station

This upgrade is being delivered as part of the Safe Accessible Transport program. The program aims to make public transport safer, more inclusive and easier to use for all passengers.

Improvements will be designed to support our diverse customers, such as people with disabilities, parents or carers with prams, the elderly, and women and girls.

Key features



- 4 new lifts to improve access to platforms, underpass and surrounding streets



- An accessible parking space and kiss and ride on Thomas Street, and a kiss and ride on Victoria Road



- A new family accessible toilet, new hearing loops, platform regrading and tactile indicators



- Safety improvements including lighting, CCTV, and wayfinding signage, with improvements to address the flooding in the underpass



- Design and placemaking enhancements that consider Connecting to Country.



Project status

We have developed a draft concept design by looking at the site's unique opportunities and constraints, and through undertaking targeted stakeholder engagement.

We are now seeking community feedback on this design. The feedback we receive will influence the final concept design.

A Review of Environmental Factors (REF) will then be prepared using the design.

Engagement with the community and key stakeholders will be ongoing throughout project development and delivery.

What we have heard so far

So far, we have engaged with various groups including Inner West Council, people with disability, and separately with women and girls from the local community through a Safer Cities Program workshop.

We also accessed existing customer feedback about Lewisham Station to help understand community sentiment.

These engagements and research provided insights into how the transport network is used and the opportunities we have to improve passengers' experiences.

Feedback we have heard so far includes:

- Flooding in the underpass needs to be addressed.
- Safety and security: additional safety measures such as CCTV, help points and mirrors, wayfinding signage and additional lighting will help the station feel safer. Railway Terrace bus stop and Thomas Street can feel unsafe at times.
- Accessibility: include a lift lobby with space for someone in a wheelchair to safely wait while passengers alight the lift, make sure street furniture (ie seats, bicycle hoops) don't block paths for people with vision impairment, and use larger lift buttons.
- Suggestions to include a ramp to access station platforms instead of, or as well as, the new lifts.

Proposed key features of Lewisham Station upgrade

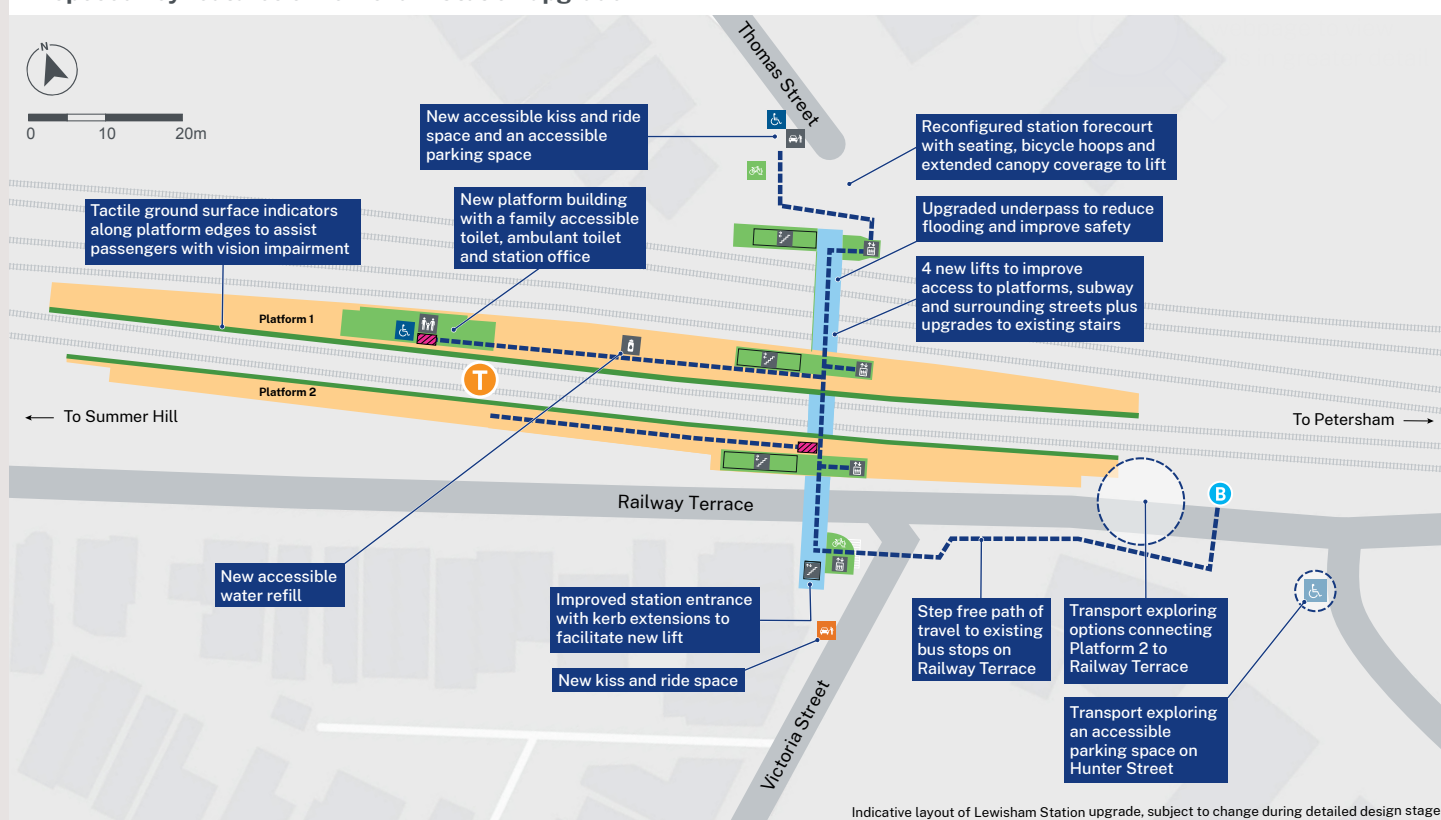

Indicative layout of Lewisham Station upgrade, subject to change during detailed design stage

KEY

 Proposed features	--- Step free path of travel	 New family accessible toilet	 Accessible parking space
 Existing features	 Upgraded stairs	 Bicycle hoops	 Existing underpass
 Boarding Assistance Zone	 New lifts and landings	 Accessible kiss and ride space	B Bus stop
--- Accessible path of travel	 Accessible water refill	 Kiss and ride space	 Taxi

Have your say

To view the draft concept design and learn more about the project, please scan the QR code on the next page or visit **transport.nsw.gov.au/lewisham**

Feedback can be submitted by:

- Emailing projects@transport.nsw.gov.au
- Calling 1800 684 490
- In person at a pop-up information session (details on page 4)

Please provide your feedback by **5pm Sunday 18 August**.

Your feedback will help Transport understand what is important to passengers and the community.

What will happen with my feedback?

Feedback received will be considered in the finalisation of the concept design, and responded to within the Review of Environmental Factors, which the community will be invited to have their say on in 2025.



Next steps

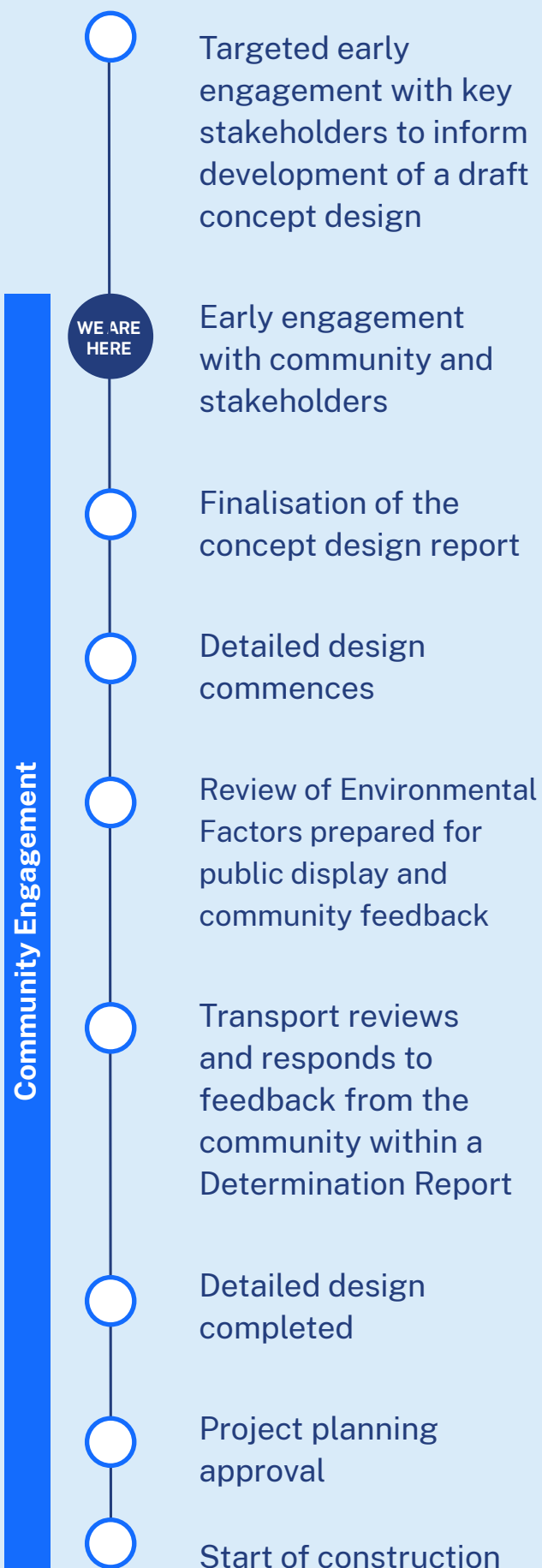

Key features



Meet the project team

We invite you to come and meet the team where you may ask questions and learn more about the proposed project.

You can drop in any time during the informal sessions.

Come and see us at:

- Flour Mill Markets, Summer Hill on **Sunday 4 August from 9am to 1pm**
- Lewisham Station, Thomas Street forecourt on **Thursday 15 August from 4pm to 6pm**



Lewisham Station, February 2024

Safe Accessible Transport program

This project is being delivered as part of the Safe Accessible Transport program, which aims to make public transport safe, inclusive and easy to use for all passengers, especially people with disability, older people, people with prams or luggage and others who may be experiencing mobility problems.

The program will upgrade stations to achieve Disability Standards for Accessible Public Transport (DSAPT) compliance, improving amenity, access and safety and acknowledging the important role these locations have to the communities they serve.

The modernisation of the network also helps bring ageing infrastructure in line with current accessibility standards, making it possible for everyone to access transport services.

Get in touch

If you have any questions or would like more information please contact our project team:



1800 684 490



projects@transport.nsw.gov.au



transport.nsw.gov.au/lewisham



Interpreter service

For languages other than English call **131 450**
Mandarin • Cantonese • Greek • Italian

获取英语以外的其他语言口译协助服务可以致电**131 450**

獲取英語以外的其他語言傳譯協助服務可以致電**131 450**

Για υπηρεσίες διερμηνείας σε άλλες γλώσσες εκτός από τα Αγγλικά καλέστε το **131 450**

Per il servizio di interpretariato per lingue diverse dall'inglese chiamare il **131 450**