



# Live Traffic NSW

## Guide for freight



Photo: Copyright State of New South Wales (Transport for NSW)





# Live Traffic NSW guide for freight

The Live Traffic NSW website and app provide real-time information to help you and your team plan around incidents on roads in NSW.

The Transport Management Centre at Transport for NSW manages and monitors the NSW state network of 18,000 kilometres of roads.

In 2023, councils were invited to publish local and regional road disruption information to Live Traffic NSW.

The Live Traffic NSW app is ideal for our freight partners. This document helps explain some of what the Live Traffic NSW app can do, including how to:

- Create, save and name a route
- Schedule the relevant times and days for your saved routes
- Set up and manage notifications for your saved routes
- Share information with your drivers easily.

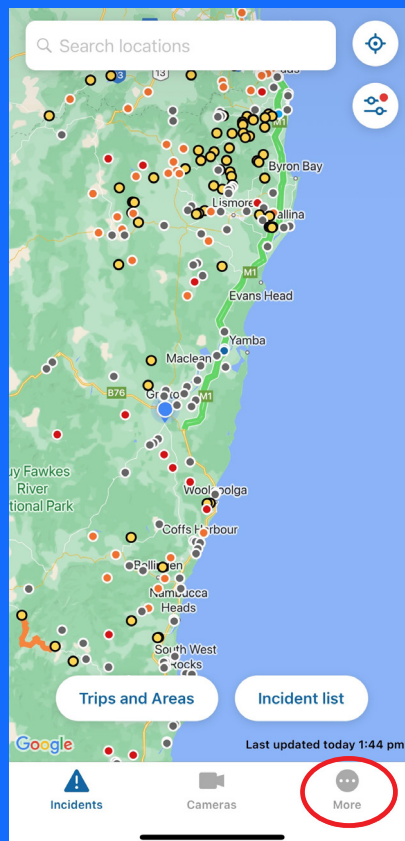

## Find the Restricted Access Vehicle Map in Live Traffic NSW

We have made it easy to access the interactive Restricted Access Vehicle (RAV) Map in the web and app versions of Live Traffic NSW.

The interactive RAV Map provides an active depiction of the location of road network restrictions and approved routes for use by heavy vehicles. Restrictions and approved routes are shown by heavy vehicle types and map layers can be switched on and off as required, allowing you the option of customising your view.

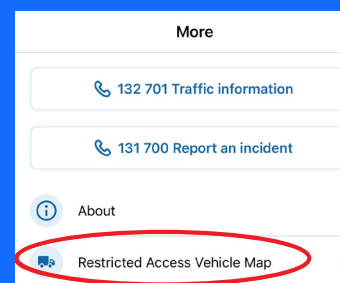

Want to check the route is suitable for your vehicle? Just tap on **"More"** and check the Restricted Access Vehicle Map.





# Live Traffic NSW – step by step guide for freight

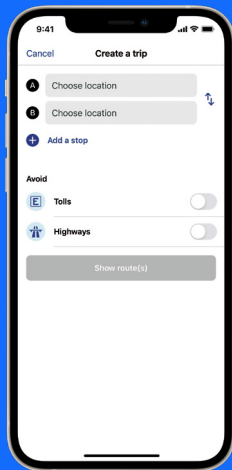

**Step 1:**  
Create a trip

From the Live Traffic homepage, select **“Trips and Area”**

Select **“Create a trip”**

Enter the starting location and the destination (you can add one stop along the way) and select **“show route(s)”**

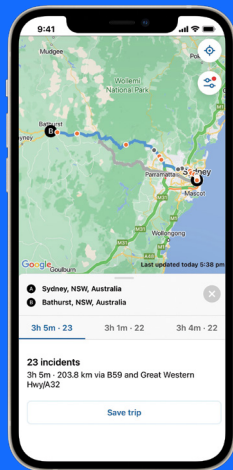

**Step 2:**  
Save and name the route

Choose the route you use for your operations from the options listed

Select **“Save trip”**

Name the route and select **“Save trip”** again. Saved routes will show in the **“Trips and Areas”** menu.

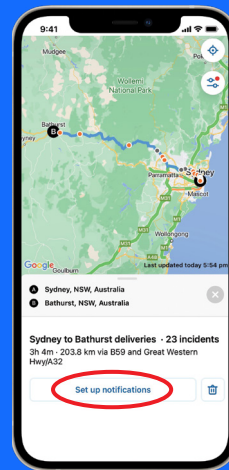

**Step 3:**  
Set up notifications

Open **“Trips and Areas”** again to select your new saved trip from the list

Select **“Set up notifications”**

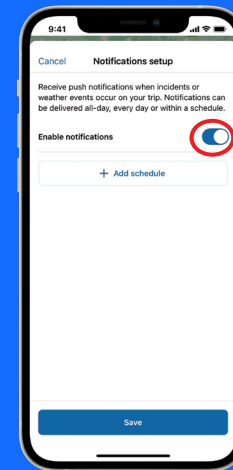

**Step 4:**  
Choose and add schedules

You can choose the days and times you want to receive notifications. Notifications can be delivered all day, every day or within your nominated schedule.

Select **“+ Add schedule”**

Select start/end time

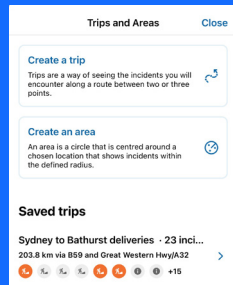

**Quick tip:**  
you can see route options mapped out by touching the times in the grey header under the map.

Just touch on the route you use for your operations and follow the steps above.

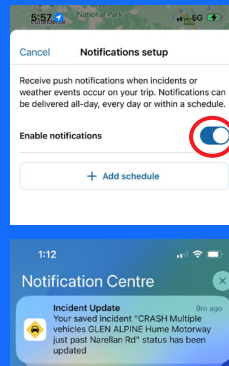

Ensure that the **“enable notifications”** is selected using the toggle.

When there is an incident on your saved route, including road closures and reopenings, you will get push notifications to your phone like the one to the left.

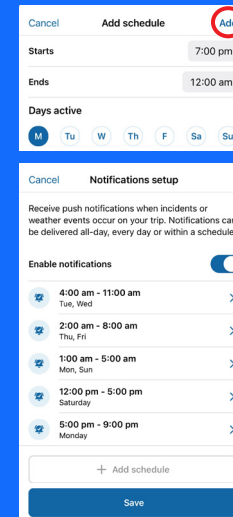

Select the days you would like to receive notifications

Select **“Add”**

**Quick tip:**  
you can add up to five scheduled periods (days and times) for each trip.

To do this, select **“+ Add schedule”**.

All active schedules will now show in **“Notifications setup”**.



# Filters – control what you see



The Live Traffic NSW app allows you to choose what you want to see. Select the filters button on the home screen and choose from the filters available under the different categories.

## Incidents

Cancel		Map options	
Filter		Legend	Councils
Incidents			Select
	Crash (5)		<input type="checkbox"/>
	Breakdown (5)		<input type="checkbox"/>
	General hazard (484)		<input type="checkbox"/>
	Traffic signal (1)		<input type="checkbox"/>
	Roadwork (1404)		<input type="checkbox"/>
	Low impact roadwork (305)		<input type="checkbox"/>
	Changed traffic condition (95)		<input type="checkbox"/>
	Public event (63)		<input type="checkbox"/>

## Map features

Map features		Select
	Google traffic flow and road closures	<input type="checkbox"/>
	Live traffic cameras	<input type="checkbox"/>
	Heavy vehicle safety stations	<input type="checkbox"/>
	Rest areas	<input type="checkbox"/>
	<b>Council supplied information</b> Information provided by local government areas	<input type="checkbox"/>
	<b>Interstate information</b> Information provided by ACT, QLD, SA, VIC	<input type="checkbox"/>
	<b>Rural Fire Service</b> Information provided by RFS Fires Near Me	<input type="checkbox"/>
	<b>Show closed incidents</b> Show incidents that have closed within the last 24 hours	<input type="checkbox"/>
	<b>Show future incidents</b> Show planned incidents which start more than 24 hours from now	<input type="checkbox"/>

## Weather and natural events

Weather and natural events		Select
	Fire (57)	<input type="checkbox"/>
	Flood (188)	<input type="checkbox"/>
	Snow/Ice (0)	<input type="checkbox"/>
	Adverse weather (23)	<input type="checkbox"/>

For freight operators you could choose to filter on:

- Rest areas
- Live Traffic cameras
- Heavy vehicle safety stations
- Interstate information
- Google traffic flow and road closures.

## What do polylines mean?

Polylines are used on Live Traffic NSW to indicate a road is closed to all vehicles. Line colour reflects incident categories. The removal of a polyline means light vehicles can travel in at least one direction. Always read the incident content as restrictions may apply to vehicle types (height, width, weight, OSOM). If you are unsure of the specific advice for your vehicle type, contact the Transport Management Centre on 131 700 prior to travelling\*.

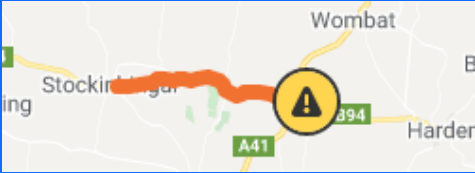

\*Unless specified otherwise, operators of Class 1, 2 & 3 vehicles travelling under a Notice must consult their relevant enforceable network map to confirm a suitable approved alternate route. Operators of Class 1, 2 & 3 vehicles travelling under a Permit must not travel off the approved route listed in the permit unless an updated permit is obtained from the NHVR.