

Out of hours work - Road closure on Elizabeth Drive, Badgerys Creek

M12 Motorway – West

March 2024



Australian Government



Transport for NSW acknowledges the Dharug people as the Traditional Custodians of the lands on which we work and pays respect to Elders past and present.

The Australian and NSW governments are building the M12 Motorway to provide direct access to the Western Sydney International Airport at Badgerys Creek and connect to Sydney's motorway network.

What work are we doing?

Transport for NSW will close Elizabeth Drive in Badgerys Creek between Adams Road and Badgerys Creek Road from **6pm Friday 8 March** to **6am Monday 11 March 2024**, weather permitting. If the work cannot be carried out over this weekend, it will be postponed to the following weekend. The road will be closed to allow our workers to realign Elizabeth Drive.

This may increase travel times. Stakeholders are encouraged to limit their movements during these works.

During this period, we will:

- close a section of Elizabeth Drive and remove future access to this road alignment
- establish the new road alignment
- open Elizabeth Drive to live traffic once the new road alignment has been completed.

The work needs to be carried out under a full road closure for the safety of our workers and road users and to minimise traffic disruption.

We will reopen the road for traffic at **6am Monday 11 March 2024**.

Our work schedule

Our work hours are between **6pm Friday 8 March** and **6am Monday 11 March 2024**, weather permitting.

What equipment will be used?

During the work we may use lighting towers, excavators, light and heavy vehicles, paving machine, cranes, vacuum trucks, water carts, sweepers, graders, and compactors.

When we work at night and on the road we will have traffic control in place.

What will this mean for you?

During this work, you may see increased activities in the area. Our work may be noisy at times, but we will do everything we can to minimise its impact, including completing noisier activities earlier in the night before **midnight**, where possible, and turning off equipment and machinery when not in use.

A map of the work has been provided over the page. Residents and businesses in the area should access via Luddenham Road or Badgerys Creek Road.

Managing our impacts

There will be temporary traffic changes along the work zone during our work hours to ensure the work zone and traffic are safe.

Please keep to speed limits and follow the direction of traffic controllers and signs.



Location of work area

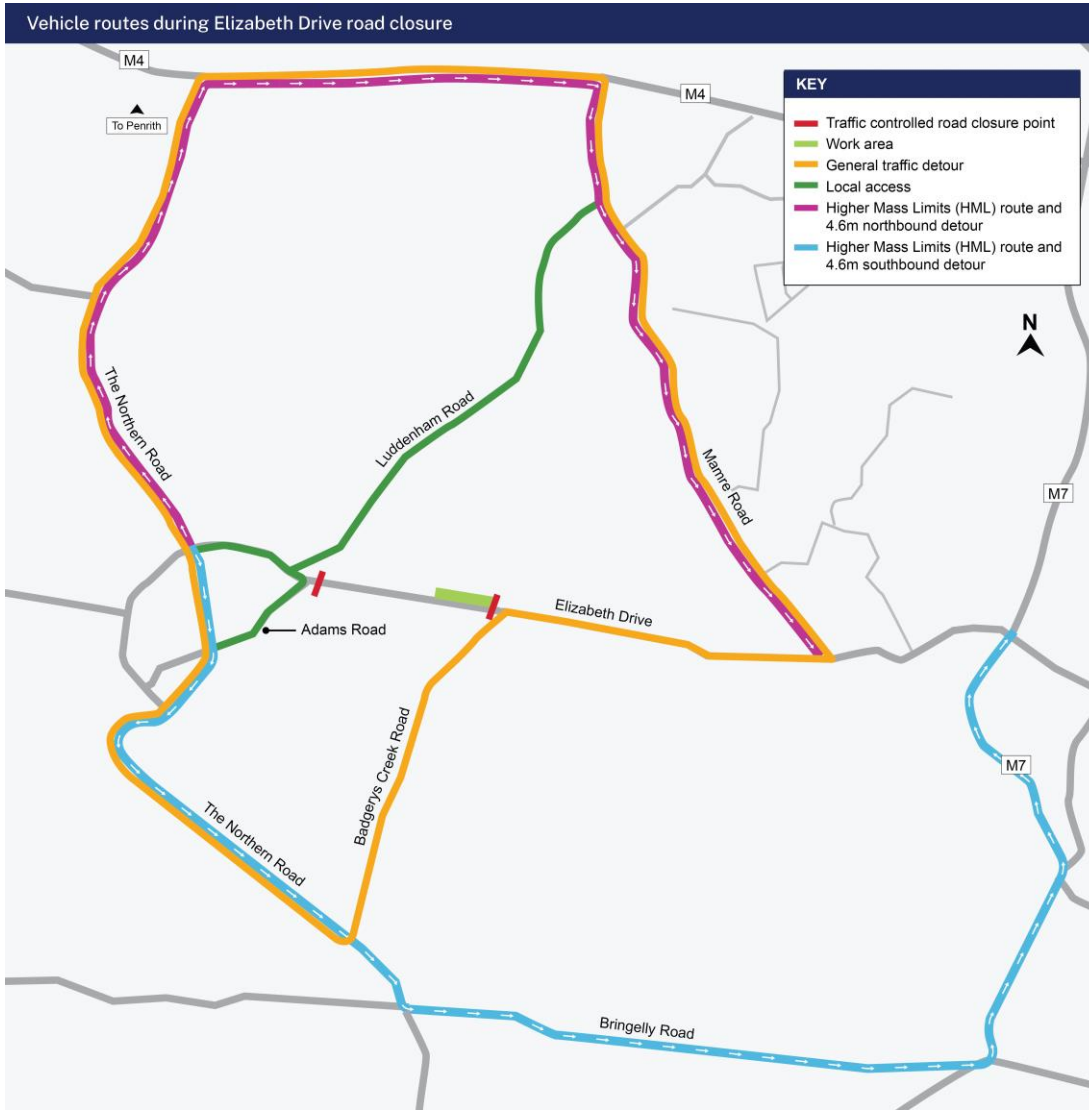

Contact us



24-hour Project Infoline
1800 517 155



m12westinfo@cpbggjv.com.au



nswroads.work/m12



Transport for NSW
PO Box 973, Parramatta NSW 2124



For the latest traffic updates:
Call 132 701, visit livetraffic.com or
download the app Live Traffic NSW



Interpreter service

For languages other than English call 131 450
Arabic • Greek • Hindi • Mandarin • Vietnamese

لطلب خدمة الترجمة الشفهية للغات غير الإنجليزية اتصل
بالرقم **131 450**

Για υπηρεσίες διερμηνείας σε άλλες γλώσσες εκτός από
τα Αγγλικά καλέστε το **131 450**

अंग्रेज़ी के अतिरिक्त अन्य भाषाओं के लिए दुभाषिया सेवा
131 450 पर कॉल करें

获取英语以外的其他语言口译协助服务可以致电**131 450**

Để có dịch vụ thông ngôn cho các ngôn ngữ khác tiếng
Anh, gọi số **131 450**

www.transport.nsw.gov.au/privacy-statement#Your_Privacy