

Removing the former Sea Life building

Manly Cove West

June 2024



View of the former Sea Life building.

From early July 2024 Transport for NSW will start removing the former Sea Life building to promenade level retaining the circular footprint for future public use. The project will provide more space back to the community and be the first step in meeting our commitment to revitalise this iconic site.

Project update

The former Manly Sea Life building is dilapidated and poses an ongoing safety risk as a result of continued unauthorised access.

In June, Delta Group was awarded the contract to remove the former Sea Life building.

Work will take about four months to complete, weather permitting.



Upcoming work

From early July 2024
for around two weeks

**WE ARE
HERE**

Site establishment

Installation of hoarding around the former Sea Life building, site sheds on the grass area next to the Manly Museum & Art Gallery and fencing off a small section of the beach to provide temporary access.

July to September 2024

Removing the building

September 2024

Site clean-up and restoration

October 2024

Site opening

The circular footprint area will be open to the public with opportunities for temporary landscaping, seating and community activation being explored while planning for the site's revitalisation is completed.

*Note some activities will run concurrently.

Location of work area

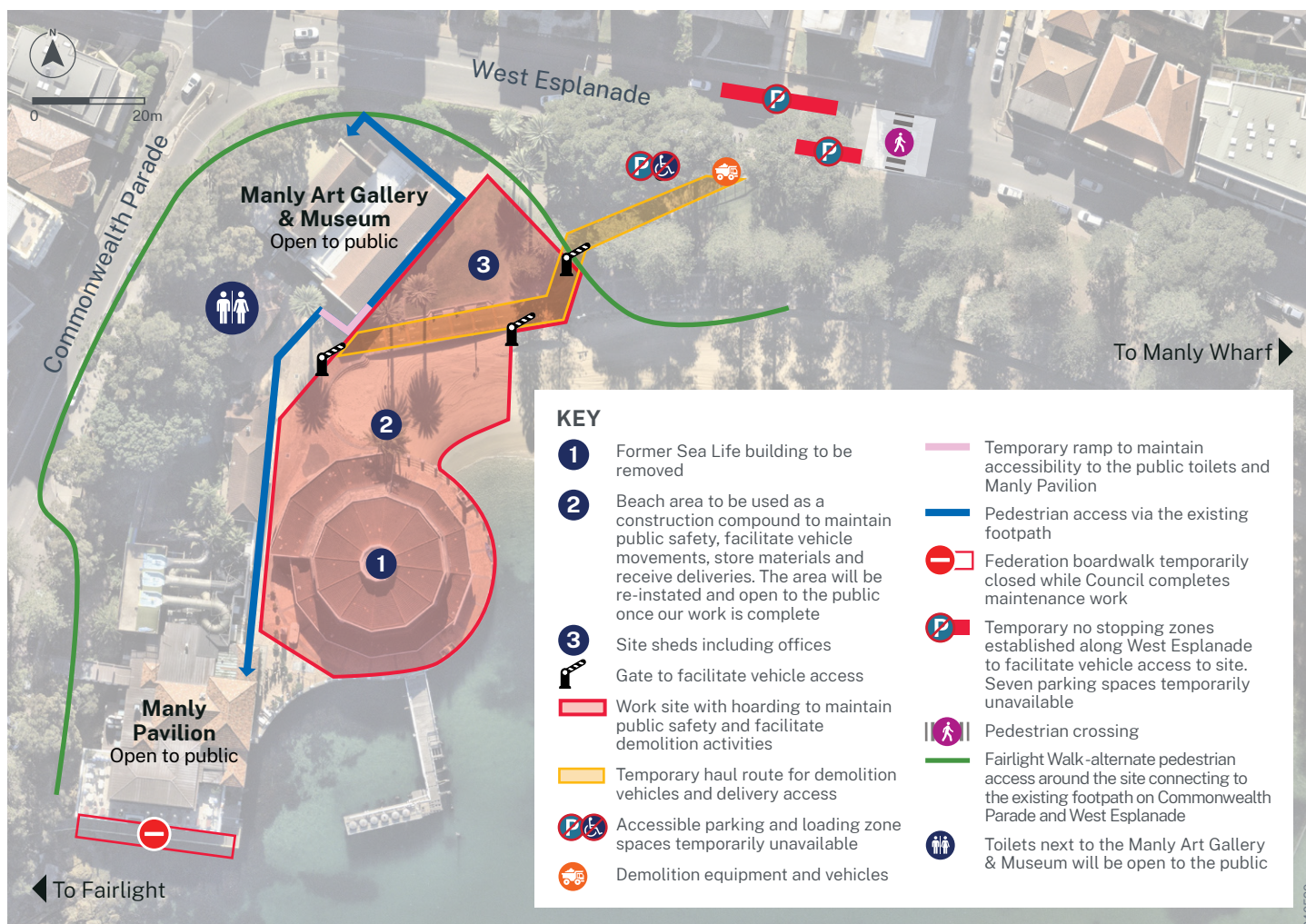

Managing impacts

We will do everything we can to minimise the impacts of our work on the community. We will keep nearby residents and businesses updated as work progresses.

Wayfinding signage and traffic control will be in place for vehicle access and to assist the community around the site.

Noise and vibration

To reduce noise we will:

- not do noisy work on the weekends and public holidays
- use noise or blanket barriers
- turn off equipment when not in use
- stage our work to minimise impacts to neighbouring businesses and residents.

Environment

All work will be carried out in accordance with our environmental management measures which can be viewed on our website.

This includes avoiding any marine side works, carrying out pre-work surveys for fauna including microbats and Little Penguins, and implementing tree protection measures.

Work hours

Our standard work hours will be:

- **7 am to 6 pm Monday to Friday**
- **8 am to 1 pm on Saturdays**

Some deliveries like machinery and equipment, may need to access site outside of standard construction hours. We will notify impacted residents and businesses when required.

Equipment used during our work will include excavators, hammers, skid steer loaders, saws, pulveriser, jack hammers, air compressors, tip trucks, concrete trucks, concrete pump, cranes, road roller, equipment floats and hand tools.

No noisy work will occur on weekends or public holidays.

Manly Pavilion and Manly Art Gallery & Museum open

During our work, the Manly Pavilion, the Manly Art Gallery & Museum and the public toilets will remain open. Signage will be in place so you can find your way.



For more information about what's on at the Manly Pavilion please visit their website manlypavilion.com.au



To learn more about what's on at the Manly Art Gallery & Museum, please visit their website www.magam.com.au



What you told us

Thank you to everyone who took the time to let us know how you would like to see this space used in the future.

We had over 300 responses with support for commercial food and beverage and open space being the most popular choices. Feedback will help inform planning for the site's final use.

Next steps

Following the removal of the building, the space will be opened for community use while planning for the site's revitalisation is completed.

Plans for the sites revitalisation, including proposed urban design features, will be placed on public display for community consideration and feedback.

We thank the community for their patience during this work and look forward to the community's ongoing involvement.

We're going paperless

To reduce our environmental impact, we would like to provide construction updates to the community via email, instead of printed notifications.

To assist with this initiative, subscribe to project updates by emailing us at manlycove@transport.nsw.gov.au with the email subject line "Manly Cove West -subscribe" or via our website "subscribe box" by scanning the QR code.



To stay informed about this project, we encourage you to sign up for project updates.

Contact us



Project Infoline **1800 684 490**
24-hour Construction Response Line
1800 775 465



manlycove@transport.nsw.gov.au



www.transport.nsw.gov.au/manlycovewest



For the latest traffic updates:

Call 132 701, visit livetraffic.com
or download the app Live Traffic NSW

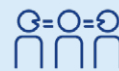

Interpreter service

For languages other than English call **131 450**
Arabic • Greek • Hindi • Mandarin • Vietnamese

لطلب خدمة الترجمة الشفهية للغات غير الإنجليزية اتصل
بالرقم **131 450**

Για υπηρεσίες διερμηνείας σε άλλες γλώσσες εκτός από
τα Αγγλικά καλέστε το **131 450**

अंग्रेज़ी के अतिरिक्त अन्य भाषाओं के लिए दुभाषिया सेवा
131 450 पर कॉल करें

获取英语以外的其他语言口译协助服务可以致电**131 450**

Để có dịch vụ thông ngôn cho các ngôn ngữ khác tiếng
Anh, gọi số **131 450**