

Maintenance work on the Hume Highway at Marulan

Upcoming work

February 2024



Transport for NSW acknowledges the Traditional Custodians of the lands on which we work and pays respect to Elders past and present.

Transport for NSW will carry out maintenance work on the Hume Highway at Marulan

What work are we doing?

We will be replacing the most damaged concrete pavement slabs on the northbound lanes along the Hume Highway at Marulan, just north of Medway Road for about 2.5 kilometres.

This work will support future repairs of the Hume Highway at Marulan and improve safety.

We will be working between **6am and 11pm** each day from **Friday 23 February to Friday 22 March**, weather permitting.

Traffic control measures including single lane closures and a contraflow arrangement will be in place during this period.

During the Canberra Day long weekend from **Friday 8 March to Monday 11 March**, lanes in both directions will reopen with a reduced speed of 80 km/h.

How will this work affect you?

There will be noise and lighting associated with this work. We will make every effort to minimise noise where possible.

Traffic impacts

From **Friday 23 February to Sunday 25 February**, single lane closures will be in place in both directions between 6am and 6pm to allow for site set-up and traffic control placement.

From **Monday 26 February to Friday 22 March**, northbound traffic will be diverted onto the southbound lanes with a single lane in each direction in a contraflow arrangement and a reduced speed limit of 60 km/h will be in place, **24 hours a day**, for the safety of workers and road users.

Road users are advised to allow up to 10 minutes additional travel time.

During the Canberra Day long weekend, between **7am Friday 8 March and 7pm Monday 11 March**, lanes in both directions will be reopened with a reduced speed limit of 80 km/h.

From **Monday 26 February to Friday 22 March** the northbound entry ramp to the Hume Highway from Medway Road will be closed. Northbound traffic will be detoured via the Brayton Road entry ramp to the Hume Highway.

From **Monday 26 February to Friday 22 March** the northbound heavy vehicle weighbridge will be temporarily closed. All heavy vehicles are advised to remain on the highway during this period.

Traffic control and variable message signs will be in place throughout the work area and on the detour route. Please keep to speed limits and follow the direction of traffic controllers and signs.

Location of work area

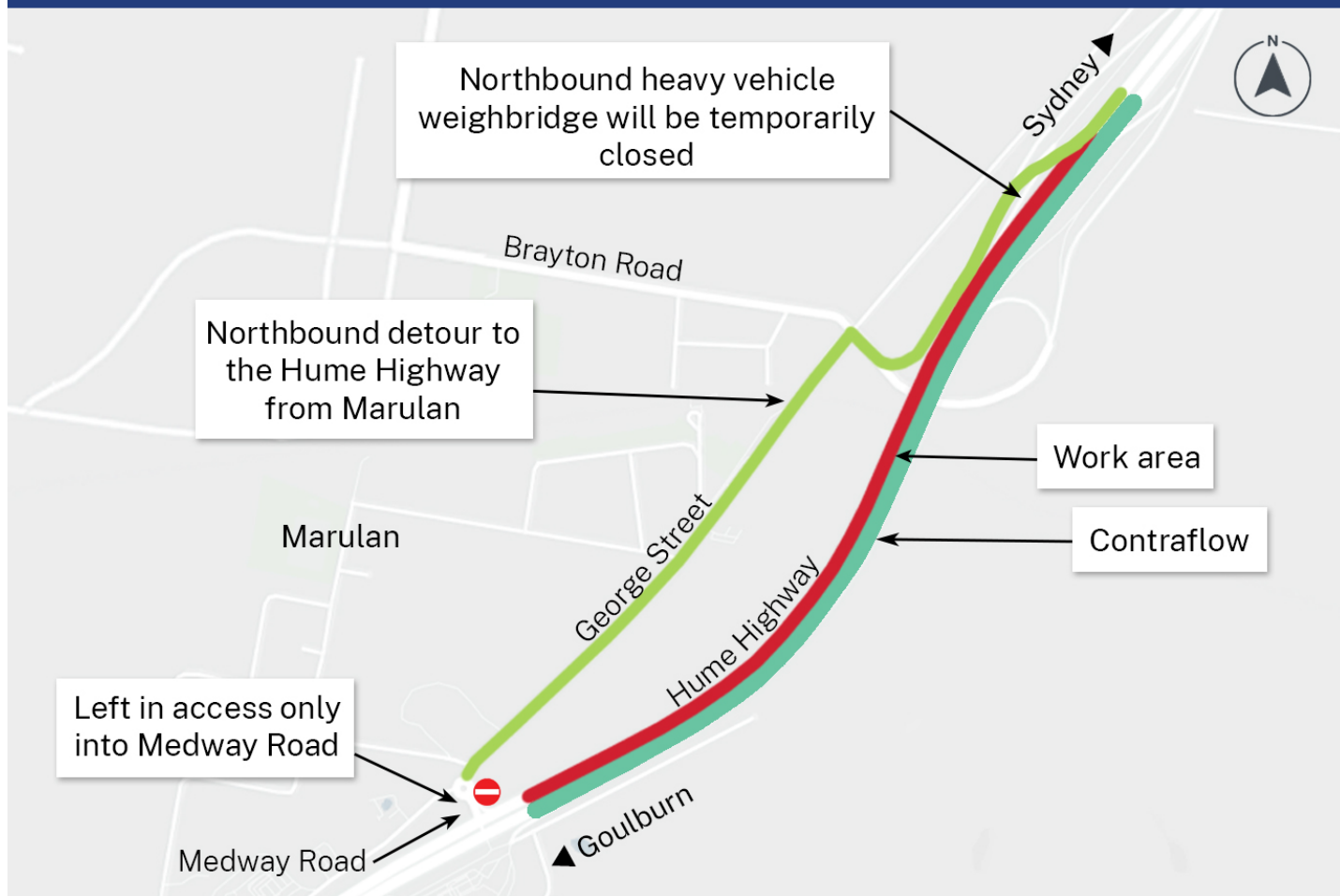

For the latest traffic updates, you can call 132 701, visit livetraffic.com or download the Live Traffic NSW App.

Contact us

If you have any questions or would like more information, please contact the project team:

 0497 879 428

 southprojects@transport.nsw.gov.au

 transport.nsw.gov.au

If you need help understanding this information, please contact the Translating and Interpreting Service on 131 450 and ask them to call us on 0497 879 428.