

Community Update | February 2024

Medlow Bath Upgrade



Australian Government

BUILDING AUSTRALIA



Work is well underway on the Medlow Bath Upgrade

Together, the Australian and NSW Governments are investing in the Medlow Bath Upgrade which will reduce congestion and improve safety and accessibility for all road users, commuters, and pedestrians.

Work is progressing with the project on track to be finished early 2025.

Despite the heavy rain in Medlow Bath over the last months, the majority of stormwater drainage work should be finished around the middle of the year.

The new drainage will really improve the way stormwater is managed along the highway and reduce runoff flow during heavy rain in Medlow Bath. For more news on construction, please see inside this update.

There has been a lot of feedback and discussion around Bellevue Crescent, and Transport has listened to your concerns.

We have removed the U-Turn Bay from the design and have responded to community suggestions to incorporate a roundabout instead.

We have now completed the design and are pleased to provide more information inside.

Highway construction update

Traffic changes on the Highway

We are planning some traffic switches during the night to help us keep the Highway open during construction.

We have started pavement work on the eastbound side of the Highway adjacent to the rail line. Once this is complete – towards the middle of the year – we will switch the traffic over to this side of the Highway to work on the westbound side of the road.

Retaining walls

The retaining wall on the eastbound side of the Highway near Bellevue Crescent is taking shape and is about 60 per cent complete and we are preparing the foundations of a second retaining wall nearby.

Soil nail wall

In February, we started work on a soil nail wall on the westbound side of the Highway near Bellevue Crescent. A soil nail wall uses drilled and grouted bars installed in a grid pattern to anchor a steep embankment that could not otherwise support itself.

Once we've finished excavation, we will start a capping beam, which is the concrete structure that will go on top of the wall next to the shared bike path past Bellevue Crescent.

The capping beam will provide drainage along the shared path and will direct runoff into the new stormwater drainage system along the Highway.

Utilities

We have finished most of the utility work on the Highway. There will be testing, commissioning and transitions for each utility as work finishes.

Utility work is continuing along Railway Parade at Sheila Street, and we will shortly complete utility work on Bellevue Crescent.

Extended working hours on Saturdays

We are working hard to get the Medlow Bath Upgrade complete so residents can enjoy the benefits.

To help us meet this goal, Transport has approved working hours of 8am to 4pm (previously 8am to 1pm) on Saturdays until the end of 2024.

We will be aiming to complete noisier works before 1pm and for works between 1pm and 4pm we will follow the out of hours noise limits and mitigation measures similar to those used during night work.

Pedestrian bridge and station update

Transport for NSW is continuing work with principal contractor, Arenco on the Medlow Bath station upgrade and pedestrian bridge.

Work on the station platform has continued with a focus on improving visual amenity, with new brick work updating planter boxes across the station.

In the coming weeks, we will resurface the platform on the country end of the station and level out the platform gradient around existing buildings, which will improve access.

We are laying the foundations for the ramp to the new pedestrian bridge, with ongoing concrete and form work.

Work on the new pedestrian walkway between the Highway and station is also taking shape; once complete, commuters will be able to directly access the Highway bus stop. These elements will dramatically improve safety for foot traffic.

In the coming weeks, there will be extensive enabling works ahead of Sydney Trains rail possession work planned for mid-March. During this possession we will:

- install precast culverts, stairs, coping deck panels and panels for the Highway walkway
- remove scaffolding around Lift 1 and install structures on top of the foundations
- resurface the platform.

Transport for NSW is committed to making it safer for everyone to use our roads and train network, and we use every opportunity in our projects to improve safety.



Pouring the new westbound elevator shaft

Bellevue Crescent

U-Turn Bay to Roundabout

Transport for NSW is committed to making it safer for everyone to use our roads, and we use every opportunity in our projects to improve safety.

In early consultation on the Medlow Bath Upgrade, many people made submissions about how they used Bellevue Crescent to do a U-Turn to get to businesses on the western side of the Highway.

This showed us that the upgrade needed to provide a way for people to do this safely.

Our concept design included a U-Turn Bay in Bellevue Crescent; however, the community had concerns and did not support this proposal. We received several suggestions that a roundabout would be a more appropriate solution.

Transport took the opportunity to reconsider the design and have now committed to providing a roundabout instead.

We have taken time to consider this new design to make sure we are providing a safe, practical roundabout that minimises impacts to the surrounding streets as much as possible.

We are speaking directly to nearby property owners about access or any other impacts to their property.

Work starting in Bellevue Crescent

We'll begin work in Bellevue Crescent in early March, and we expect to finish late 2024, weather permitting. The work includes:

- building a new roundabout
- stormwater drainage and utilities relocation
- building driveways, kerbs and gutters
- line marking and road furniture, such as signposts, speed signs, safety barriers and light poles
- removing trees along a section of Bellevue Crescent and Delmonte Avenue.

Why are we removing trees?

Unfortunately, because we need to widen the road and install new utilities, we need to remove the Cherry Trees up to and including the intersection with Delmonte Avenue. One mature gum tree and a number of trees near the intersection also need to be removed.

We appreciate that the Cherry Trees are important to the community, and we are talking with Council and the Community Advisory Group about replanting. We will look at a number of options, which may include replanting mature Cherry Trees.

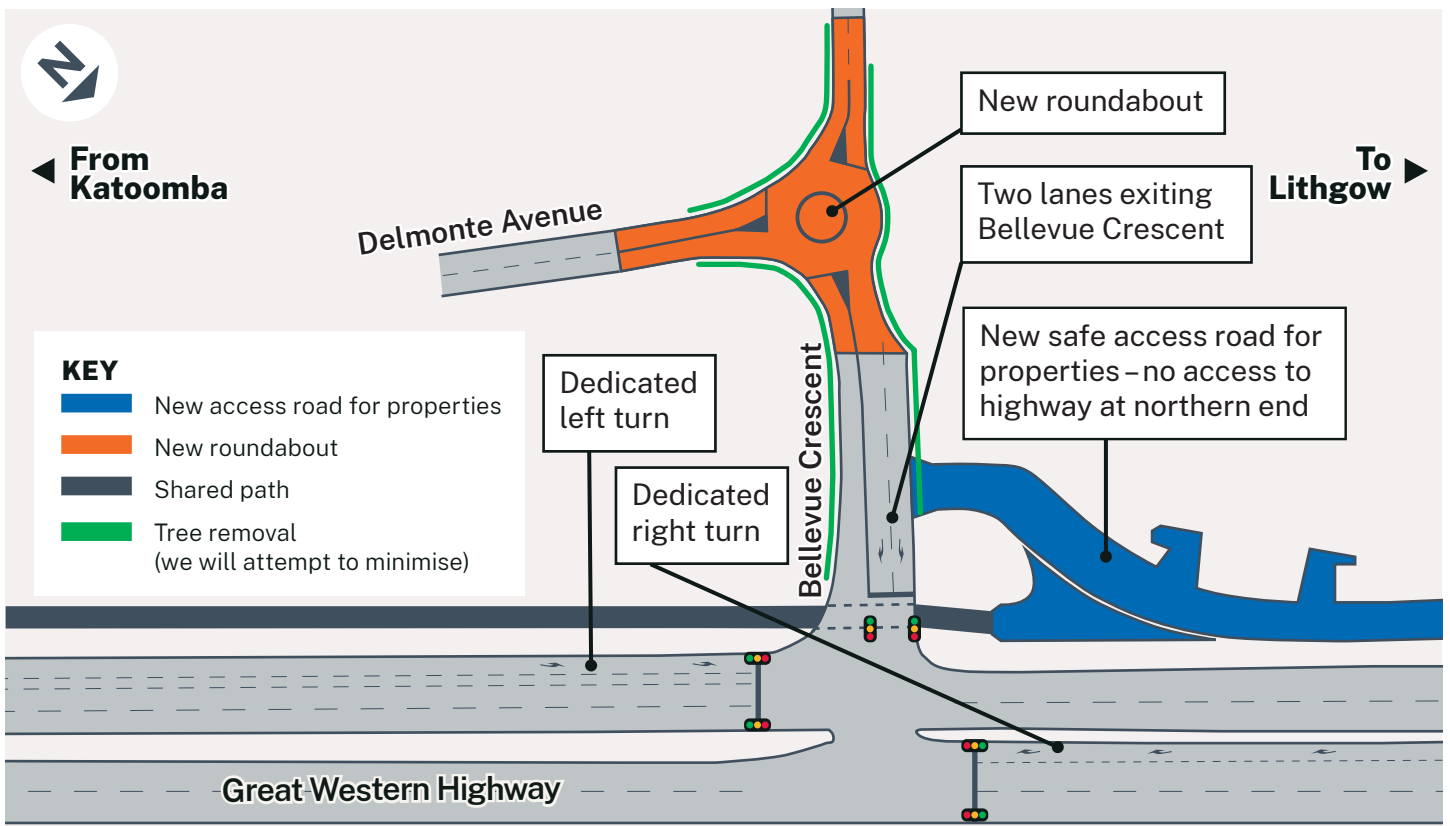

Design of the new roundabout in Bellevue Crescent

Medlow Bath Upgrade

Never miss an update

Construction can change quickly, and we often email updates to residents and other stakeholders who have registered for our ENews.

If you would like to join the list so that we can keep you up to date, please email us at gwh@transport.nsw.gov.au and let us know.

Respecting our neighbours

Medlow Bath construction is well under way, and Abergeldie and Transport have been working hard to respond to community feedback and amend our design and construction approaches where we can.

We've adjusted the parking plan in Railway Parade to protect trees, and we've fast-tracked landscaping around the PotBelly Café to ensure safe access for patrons.

We realise that construction can be inconvenient for residents and appreciate how hard it can be to live with the impacts.

We love hearing your proactive feedback and suggestions about how we can work together to provide better outcomes and reduce impacts.

In turn, we do ask that you communicate respectfully with our workers, who are doing their job as diligently and professionally as they can. If you ever have any questions or concerns, please reach out to Abergeldie or Transport on our project hotline: **1800 953 777**.

Contact us



24-hour phone line: **1800 953 777**

Press 1 for roadworks, 2 for bridge work, or 4 for Transport for NSW



gwhmedlow@abergeldie.com



gwh@arencocom.au



gwh@transport.nsw.gov.au



Roadworks:

nswroads.work/gwhmedlow



Station upgrade:

nswroads.work/medlowbathbridge



If you need help understanding this information, please contact the Translating and Interpreting Service on **131 450** and ask them to call us on **1800 953 777**.

Stay safe crossing the road

We have delivered two pedestrian crossings on Railway Parade – one at the traffic lights, and one at the U-Turn Bay near the station.

Please be aware that the speed hump near the PotBelly Cafe is not a pedestrian crossing – and crossing or not, always make sure a driver has seen you before stepping out onto the road.



Work in progress alongside the Great Western Highway at Medlow Bath

February 2024

Privacy Transport for NSW ("TfNSW") is subject to the Privacy and Personal Information Protection Act 1998 ("PPiP Act") which requires that we comply with the Information Privacy Principles set out in the PPiP Act. All information in correspondence is collected for the sole purpose of assisting in the delivery of this project. The information received, including names and addresses of respondents, may be published in subsequent documents unless a clear indication is given in the correspondence that all or part of that information is not to be published. Otherwise TfNSW will only disclose your personal information, without your consent, if authorised by the law. Your personal information will be held by TfNSW at 51-55 Currajong Street Parkes NSW 2870. You have the right to access and correct the information if you believe that it is incorrect.

Transport for NSW

roads-maritime.transport.nsw.gov.au