

# Neighbour Notification Plan

Development Application: Proposed Public Artwork - *Monuments for Fishes*

Location: Watermans Cove, Barangaroo South, Darling Harbour Waterway

Address: Barangaroo Avenue, Barangaroo NSW 2000

Applicant: Lendlease (Millers Point) Pty Ltd

Artist: Mikala Dwyer

Engineer: Event Engineering

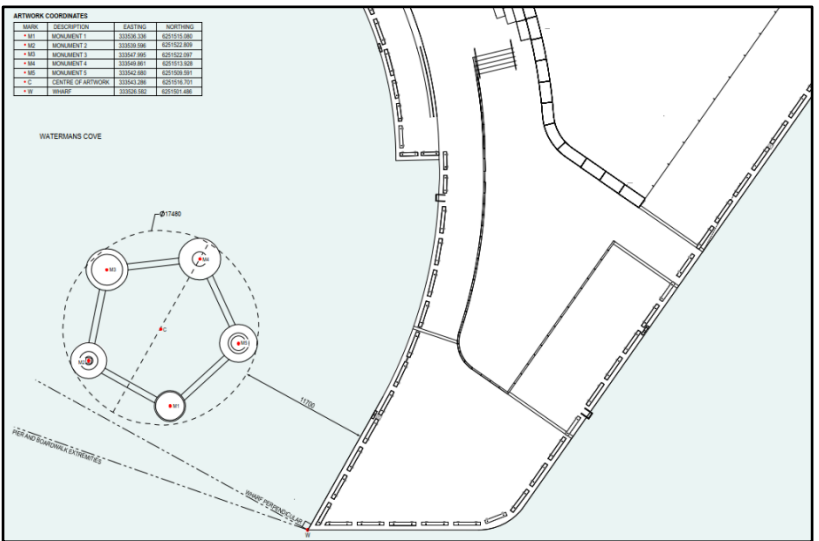
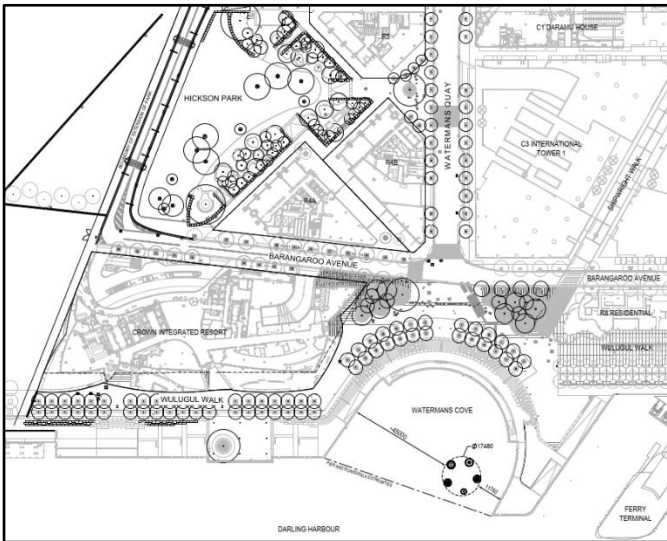

Site Plan

Pier Plan View

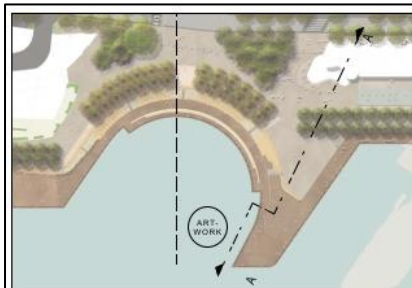

KEY PLAN

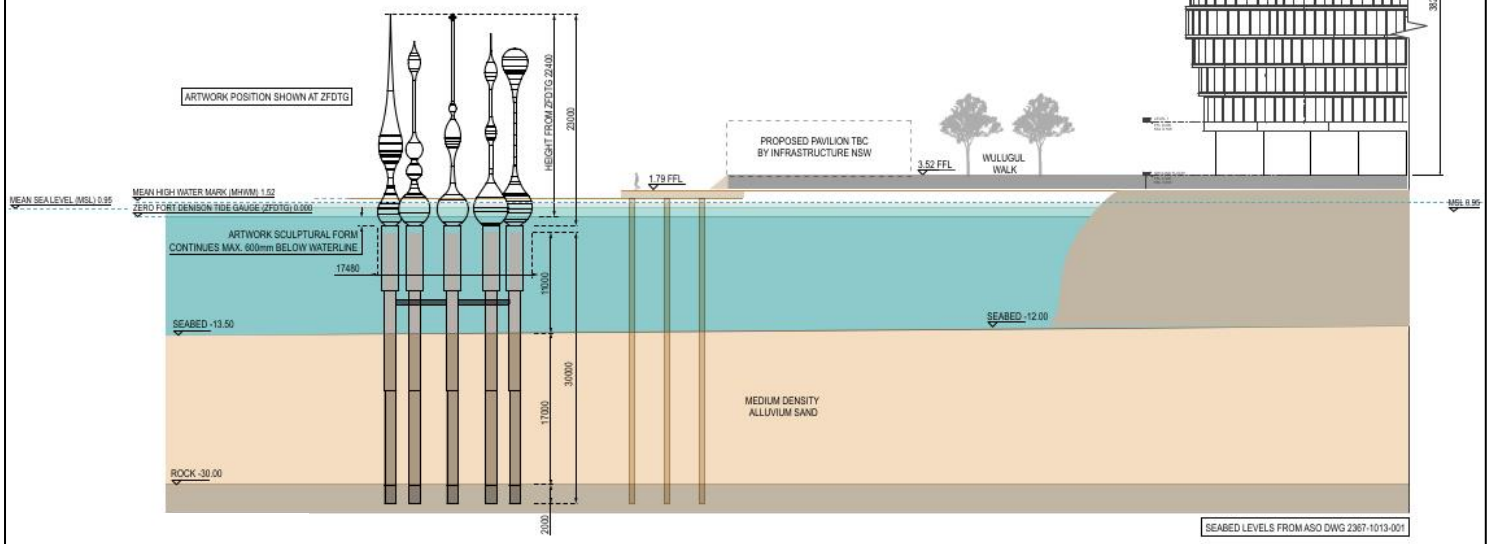

Section Plan

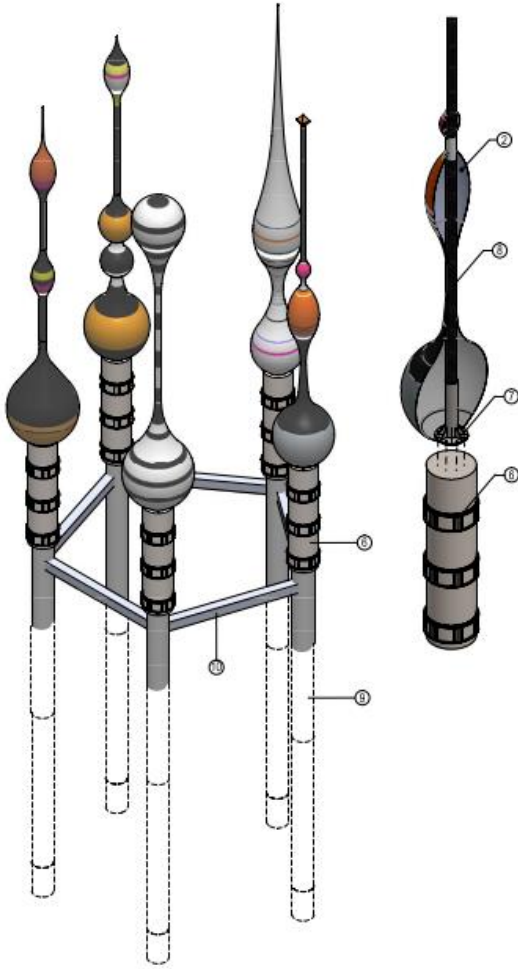

Isometric View

| ITEM NO. | DESCRIPTION          | QTY. |
|----------|----------------------|------|
| 1        | MONUMENT 1           | 1    |
| 2        | MONUMENT 2           | 1    |
| 3        | MONUMENT 3           | 1    |
| 4        | MONUMENT 4           | 1    |
| 5        | MONUMENT 5           | 1    |
| 6        | KEEL                 | 5    |
| 7        | MAST BASE            | 5    |
| 8        | MAST ( x 3 SECTIONS) | 5    |
| 9        | PIER                 | 5    |
| 10       | RING BEAM            | 1    |

Key

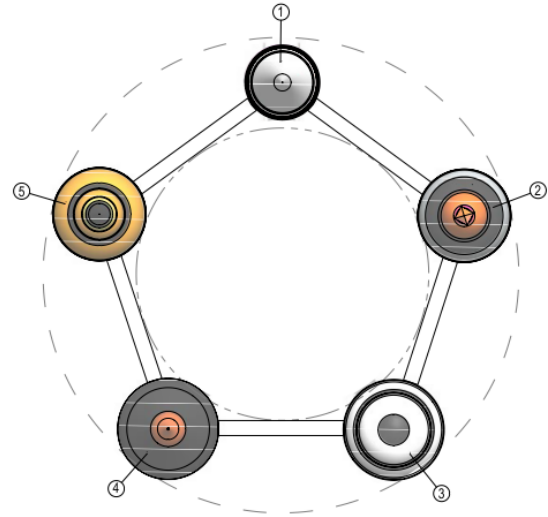

Plan View



Artist impression only. Design subject to change. View lines and fixtures may differ from that shown.

Render view from Waterman's Cove