

# Access Improvements – St Peters Station

August 2024



Transport for NSW acknowledges the Gadigal and Wangal people as the Traditional Custodians of the lands on which we work and pays respect to Elders past and present.

## The NSW Government is improving accessibility at St Peters Station

Earlier this year, Transport for NSW completed upgrades to the station master's office and installed family accessible toilet facilities .

After listening to the community, we are designing a step-free pathway from Goodsell Street through May Lane to St Peters Station.

Transport are working with the Inner West Council on a design, which includes:

- a step-free pathway created by removing the existing garden bed and retaining wall on Railway Lane
- the removal of some seating along Railway Lane to improve access.

We will be in touch before construction starts.



To subscribe to the email distribution list for this project, please contact [projects@transport.nsw.gov.au](mailto:projects@transport.nsw.gov.au)

## Transport for NSW

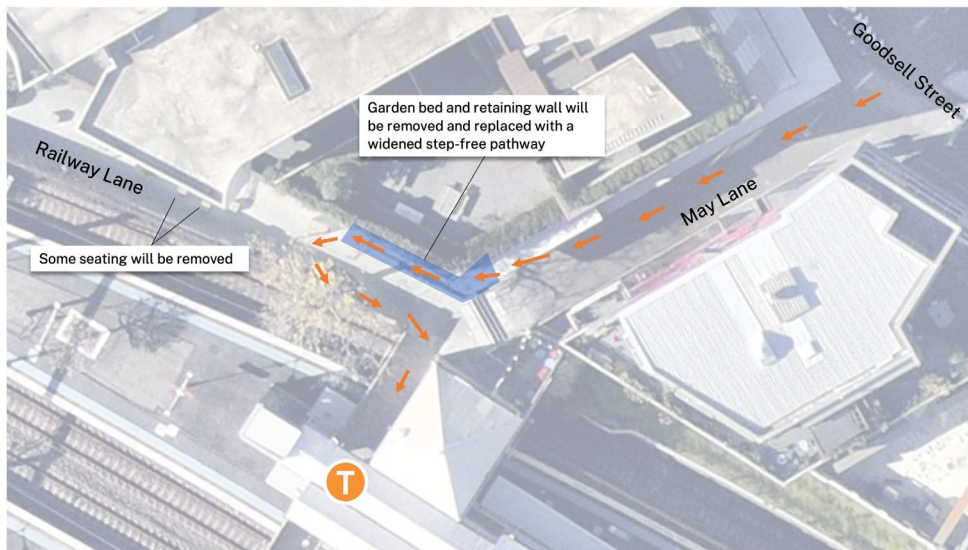

← New step-free pathway from Goodsell Street to St Peters station via May Lane

■ Garden bed and retaining wall removal/widened step-free pathway

### Contact us

If you have any questions, please get in touch via the details below.



Project Infoline **1800 684 490**



**[transport.nsw.gov.au/StPeters](https://transport.nsw.gov.au/StPeters)**



**[projects@transport.nsw.gov.au](mailto:projects@transport.nsw.gov.au)**

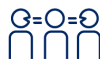

**Interpreter service** For languages other than English call 131 450

[www.transport.nsw.gov.au/privacy-statement#Your\\_Privacy](https://www.transport.nsw.gov.au/privacy-statement#Your_Privacy)



To subscribe to the email distribution list for this project, please contact [projects@transport.nsw.gov.au](mailto:projects@transport.nsw.gov.au)