

Have your say Lewisham Station

Safe Accessible Transport program

March 2025



Artist's impression of the proposed upgrade, subject to change during detailed design

The NSW Government is improving accessibility at Lewisham Station



Planning is underway to improve Lewisham Station under the Safe Accessible Transport program, which aims to make public transport safe, inclusive and easy to use for all passengers, especially people with disability, older people, people with prams or luggage and others who may be experiencing mobility problems.

New features and improvements



Four lifts to improve access to platforms, underpass and surrounding streets.

Drainage improvements to address flooding in the underpass.



An accessible parking space and kiss and ride on Thomas Street, a kiss and ride on Victoria Street and an accessible parking space on Hunter Street.



A family accessible toilet within a new station building.



Hearing loops to assist people with hearing loss.

Platform levelling, and installation of tactile ground surface indicators to assist passengers who are visually impaired.



Safety and security improvements including lighting, CCTV, and signage.



Design and placemaking enhancements including Connecting with Country design elements.

Lewisham Station upgrade

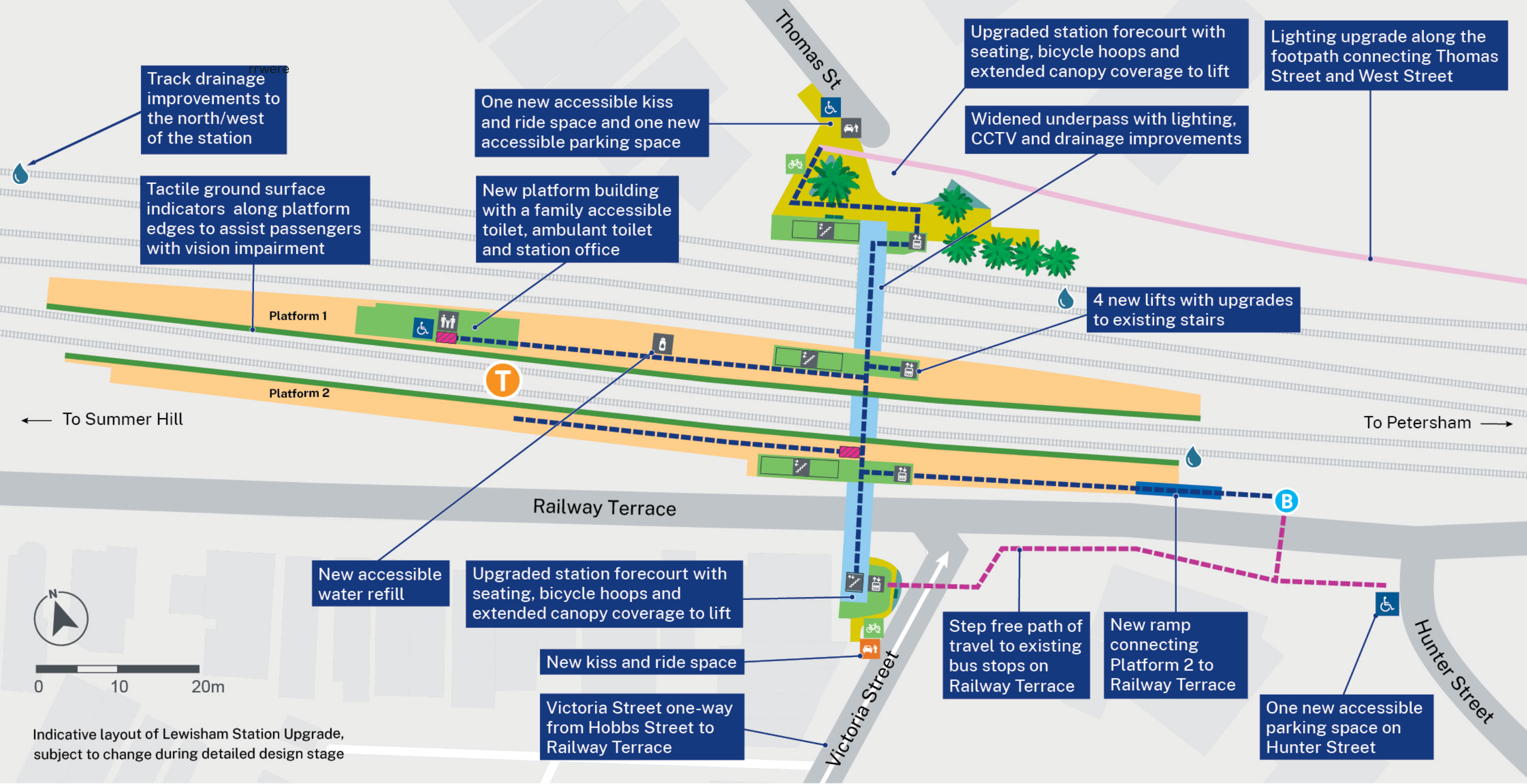

KEY

- Proposed features
- Existing features
- Boarding Assistance Zone
- Accessible path of travel
- Step free path of travel

- Upgraded stairs
- New lifts and landings
- Accessible water refill
- New family accessible toilet
- Accessible kiss and ride space

- Kiss and ride space
- Accessible parking space
- Bicycle hoops
- Taxi
- Bus stop
- Track drainage improvements

- Existing underpass
- Existing footpath
- Proposed paved area
- Proposed landscaping
- Proposed seating

Potential impacts during construction and operation

These are addressed in greater detail in the REF, and are subject to planning approval and detailed design.



Work hours

Standard hours are between 7am and 6pm Monday to Friday and between 8am and 1pm on Saturday. Some construction work will be required at night and on weekends, and we will notify the community in advance. During night and weekend work, access to, from and around the station may change. The community will be informed well ahead of expected impacts.



Changes to parking

During construction there will be a temporary reduction in parking to facilitate construction activities, including the establishment of a site compound in Thomas Street. The proposal will result in a loss of seven time-restricted parking spaces near the station, four located on Victoria Street, two on Thomas Street, one on Hunter Street, to facilitate the new kiss and ride zones and accessible parking spaces. Transport will work closely with Council, the contractor and the community to minimise impacts as much as possible while work takes place.



Noise and vibration

At times, some noise and short bursts of vibration may be felt by residents and businesses operating close to the station. Transport will work to carefully plan this work and reduce impacts wherever possible. Additional mitigation measures will be considered for potentially affected residents throughout construction.

Have your say

We are now seeking community feedback on the Review of Environmental Factors (REF) for the proposed upgrade to Lewisham Station.

The REF outlines the features of the concept design and assesses a range of potential environmental impacts expected during construction and operation.

The REF includes how we plan to minimise these impacts to our environment and community. Your feedback will help us understand what is important to the community and identify additional ways to reduce potential impacts.

Construction is expected to commence early 2026, and take 18-24 months to complete.



Scan the QR code to view the REF



Artist's impression of the proposed Lewisham Station Upgrade, subject to change during detailed design

What you've told us so far

In 2024, we engaged with the community and stakeholders. Here is a summary of the key issues:

What we heard from the community

Flooding in underpass and leaking awning on Victoria Street

We are committed to resolving underpass flooding issues as part of this station upgrade with track drainage improvements. We are proposing to replace the existing awnings on Victoria Street with a new single awning, to resolve the leaks.

Requests to retain timed shopper/commercial parking

Transport will explore opportunities to retain a shopper/commercial parking space behind the proposed kiss and ride space on Victoria Street during the detailed design stage.

Bicycle parking

Transport will look at relocating bicycle parking in covered and visible locations at Thomas Street and Railway Terrace/Victoria Street. We will also explore suitable parking for e-bikes.

Safety at and around the station

The station upgrade includes additional lighting, CCTV and emergency help points, meaning if you press an emergency help point on any station platform, you're visible on live CCTV and can get assistance from a trained operator. Opportunities to further improve safety at the station will continue to be a focus during the detailed design stage.

Visual impacts

The station upgrade design will be developed by architects, who will take into consideration the existing environment and local history, as well as aspects like the long-term maintenance of the new infrastructure.

Pedestrian connectivity between the rail and light rail stations

This project is focused on delivering improved accessibility and convenience for current and future passengers, which the current design delivers. Transport would explore future opportunities to better connect the light rail with the upgraded train station in collaboration with Council.

Proposed changes to Victoria Street

Victoria Street is proposed to be one way northbound from Hobbs Street. Details including vehicle movements will be explored during the detailed design stage.

What we heard from local people with disability and carers

Accessible parking

Accessible parking should be provided on both sides of the station, as well as step-free kiss and ride. Upgrades will provide an accessible parking space and accessible kiss and ride on Thomas Street, and an accessible parking space on Hunter Street, and a step-free kiss and ride on Victoria Street.

Ramp access to station platforms

The project design includes a new accessible ramp to integrate a new accessible ramp connecting Railway Terrace to Platform 2.

Next steps

Community Engagement

WE ARE
HERE

March 2025

Review of Environmental Factors released for community and stakeholder feedback

Mid 2025

Project planning approval

Q3 2025

Award delivery contract and commence second stage of the design process

Early 2026

Start of construction

Late 2027

Upgrade complete and open to public

At the end of the REF display period, we will collate and consider the submissions received. A Determination Report with a summary of the community feedback received and our responses will be published on the project website. **We encourage you to register for updates by contacting us**, so we can get the latest information to you via email.

We'd like to hear from you

How to provide feedback

Email projects@transport.nsw.gov.au

Call the project Infoline on **1800 684 490**

Visit the project website and complete a feedback form online via transport.nsw.gov.au/lewisham



Talk to the team

The project team will be available to answer your questions during the display period.

Drop in any time during these informal sessions.

When Thursday, 3 April

Time 4pm to 6pm

Where Lewisham Station

Corner Victoria St and Railway Terrace,
Lewisham

When Sunday, 6 April

Time 9am to 1pm

Where Flour Mill Markets

18 Flour Mill Way, Summer Hill



Did you know?

The Review of Environmental Factors (REF) is on public display until

Tuesday 22 April 2025, community feedback is invited during this time.



Scan the QR code
to view the REF



Contact us



Project Infoline **1800 684 490**



projects@transport.nsw.gov.au



transport.nsw.gov.au/lewisham

www.transport.nsw.gov.au/privacy-statement#Your_Privacy

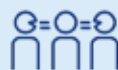

Interpreter service

For languages other than English call **131 450**
Mandarin • Cantonese • Greek • Italian

获取英语以外的其他语言口译协助服务可以致电**131 450**

獲取英語以外的其他語言傳譯協助服務可以致電**131 450**

Για υπηρεσίες διερμηνείας σε άλλες γλώσσες εκτός από
τα Αγγλικά καλέστε το **131 450**

Per il servizio di interpretariato per lingue diverse
dall'inglese chiamare il **131 450**