

# Maintenance work on Medway Road at Marulan

Upcoming work

April 2024



Transport for NSW acknowledges the Traditional Custodians of the lands on which we work and pays respect to Elders past and present.

## What work are we doing?

We will be replacing concrete pavement slabs on the northbound entry ramp to the Hume Highway from Medway Road at Marulan.

Work will be carried out from **Monday 29 April to Wednesday 8 May** between 7am and 5pm, weather permitting. No work will be carried out on Saturday or Sunday.

## How will this work affect you?

There will be noise and lighting associated with this work. We will make every effort to minimise noise and complete this work as quickly as possible.

## Traffic impacts

From **Monday 29 April to Friday 3 May and from Monday 6 May to Wednesday 8 May** the northbound entry ramp to the Hume Highway from Medway Road will be closed. Northbound traffic will be detoured via George Street and Brayton Road to the Hume Highway.

The northbound entry ramp to the Hume Highway from Medway Road will re-open on **Saturday 4 May and Sunday 5 May**.

From **Monday 29 April to Thursday 2 May** guidance under traffic control and stop/slow conditions will be in place at the George Street and Medway Road roundabout.

For the safety of workers and motorists, a reduced speed limit of 80 km/h will be in place on the Hume Highway approaching the Medway Road intersection.

Road users are advised to allow five minutes additional travel time.

Traffic control and variable message signs will be in place on the detour route. Please keep to speed limits and follow the direction of traffic controllers and signs.

For the latest traffic updates, you can call 132 701, visit [livetraffic.com](https://www.livetraffic.com) or download the Live Traffic NSW app.

## Location of work area

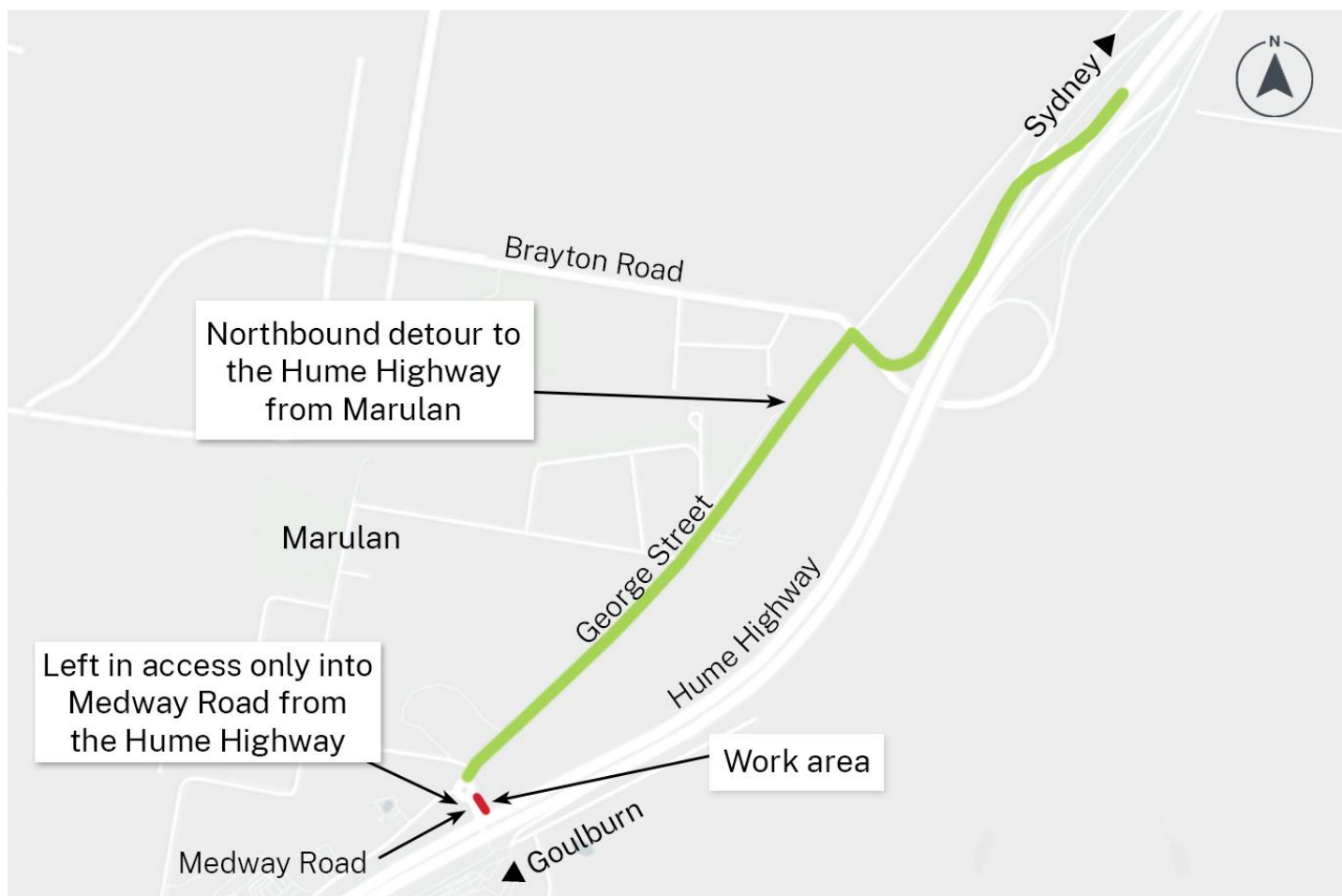

## Contact us

If you have any questions or would like more information, please contact the project team:

 0497 879 428

 [southprojects@transport.nsw.gov.au](mailto:southprojects@transport.nsw.gov.au)

 [transport.nsw.gov.au](http://transport.nsw.gov.au)

If you need help understanding this information, please contact the Translating and Interpreting Service on 131 450 and ask them to call us on 0497 879 428.