

Moss Vale Station and Stabling Yard Upgrade

Community notification

February 2025



Transport for NSW acknowledges the Traditional Custodians of the lands on which we work and pays respect to Elders past and present.

The NSW Government is delivering an upgrade to Moss Vale Station and Stabling Yard to achieve Disability Standards for Accessible Public Transport 2002 (DSAPT) compliance and to accommodate the new Regional Rail fleet.

The project will provide a station precinct that is accessible to those with a disability, limited mobility, parents/carers with prams and customers with luggage, while ensuring it aligns with Moss Vale's transport needs.

What work are we doing?

Construction will continue in and around the station building on Argyle Street, Lackey Road and Dalys Way. Key activities include:

- installing a kiss and ride zone and pram ramp on Argyle Street near the clock tower
- resurfacing a section of the footpath on Argyle Street, near Leighton Gardens
- reinstating temporary toilet facilities in the station forecourt to carry out minor modifications to male and female toilets
- resurfacing pathways near the station forecourt
- upgrading the ticket window and installing new automated doors to the waiting room, luggage room and station office
- continuing work in the stabling yard and foundation work for the noise barrier on Lackey Road
- installing temporary concrete barriers along the eastern side of Lackey Road and a 'no stopping' zone on the western side. The road

will be narrowed and new line marking applied (see map).

What will this mean for you?

Access

- Entry to the station will be through the front of the waiting room building.
- Pedestrian access to the pathway along Argyle Street near Leighton Gardens will be temporarily relocated to the path through the gardens while footpath is resurfaced.
- Traffic and pedestrian arrangements will remain in place along Dalys Way, including:
 - traffic lights positioned at the start of Dalys Way and at the station forecourt to facilitate one way traffic flow
 - footpath closure on the eastern side of Dalys Way.
- There will be more workers in and around the station buildings with some work zones temporarily isolated for the safety of workers and the community.

Bus and taxi zones

- Bus and taxi zones will be relocated further south on Argyle Street, until the end of February.

Parking

- Parking spaces in the station forecourt may be adjusted to allow work to continue safely. There will be no changes to accessible parking spaces.



When will we be working?

Most work will be carried out during standard construction hours between **7am to 6pm, Monday to Friday and 8am to 1pm on Saturdays**. Where required, approved Saturday extended hours may apply from 7am to 6pm. All work is dependent on weather and site conditions and is subject to change.

Location of work area

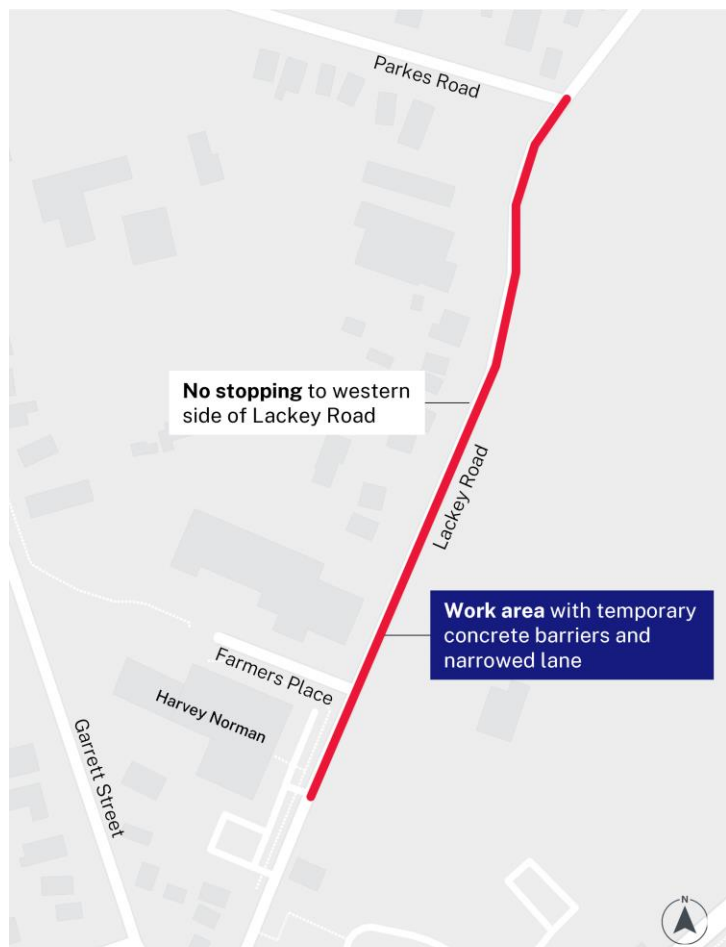

Changes to Lackey Road include a narrowed lane and 'no stopping' zone.

Work will be happening along Lackey Road and in and around the station buildings, adjacent to Argyle Street and on Dalys Way.

All construction areas will have fencing or barricades, and signage for safety and security.



For information on accessing the station, scan the QR code or visit transport.nsw.gov.au/mossvale

Contact us



Project Infoline **1800 684 490**
24-hour Construction Response Line
1800 775 465



projects@transport.nsw.gov.au



www.transport.nsw.gov.au/mossvale



Interpreter service

For languages other than English call 131 450
Arabic • Cantonese • Hindi • Mandarin • Vietnamese
لطلب خدمة الترجمة الشفهية للغات غير الإنجليزية اتصل بالرقم
131 450

獲取英語以外的其他語言傳譯協助服務可以致電**131 450**
अंग्रेजी के अतिरिक्त अन्य भाषाओं के लिए दुभाषिया सेवा **131 450**
पर कॉल करें

獲取英語以外的其他語言口譯協助服務可以致電**131 450**
Để có dịch vụ thông ngôn cho các ngôn ngữ khác tiếng Anh,
gọi số **131 450**



To subscribe to the email distribution list for this project, please contact projects@transport.nsw.gov.au